

VISA

EN INSTALLATION INSTRUCTIONS
FR NOTICE DE MONTAGE
DE MONTAGE-ANLEITUNG
PT INSTRUÇÕES DE MONTAGEM
ES INSTRUCCIONES DE MONTAJE

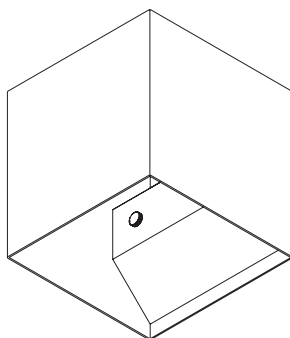

Order code / Code com. / Bestell-Nr. / Código / Código: 90220L...



EN Carefully read the installation instructions provided before installing the device. Safety and Maintenance: Scan here.
FR Lire attentivement les notices de montage avant l'installation de l'appareil. Sécurité et Entretien: Scannez ici.
DE Bitte lesen die mitgelieferte Montageanleitungen vor de Montage des Geräts. Sicherheit und Wartung: Hier scannen.
PT Leia atentamente as instruções de montagem fornecidas antes de instalar o aparelho. Segurança e Manutenção: Scan aqui.
ES Lea atentamente las instrucciones de montaje proporcionadas antes de instalar el aparato. Seguridad y Mantenimiento: Escanea aquí.



INDELAGUE - INDÚSTRIA ELÉTRICA DE ÁGUEDA, S.A. | RUA DA MINA 465, COVÃO - ZONA INDUSTRIAL EN1 NORTE
 3750-792 ÁGUEDA, PORTUGAL | T. +351 234 612 310 | WWW.INDELAGUEGROUP.COM

VISA

 (mm)
110x110x110

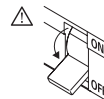

TOOLS | OUTILS | WERKZEUG | FERRAMENTAS | HERRAMIENTAS

Phillips screwdriver



EN USE GLOVES.
FR UTILISEZ DES GANTS.
DE HANDSCHUHE BENUTZEN.
PT UTILIZE LUVAS.
ES USE GUANTES.



VISA

90220L...

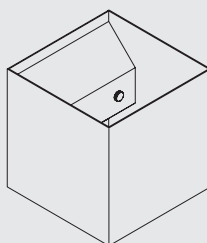
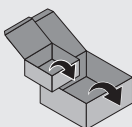

(x1)

 (mm) **A (mm)** **B (mm)** **C (mm)**
110x110x110 60 34 55

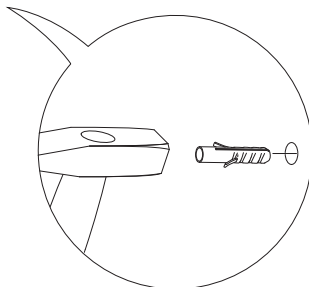
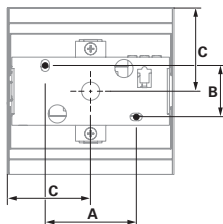
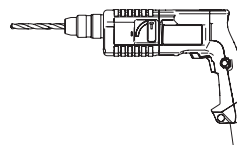

1

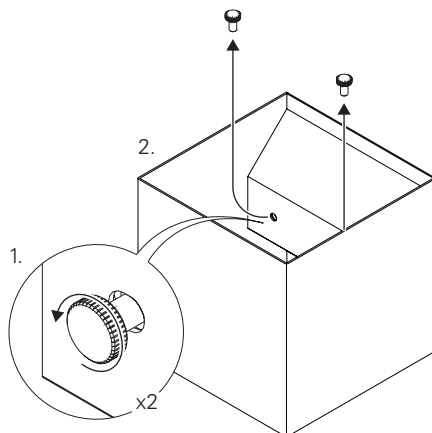

2

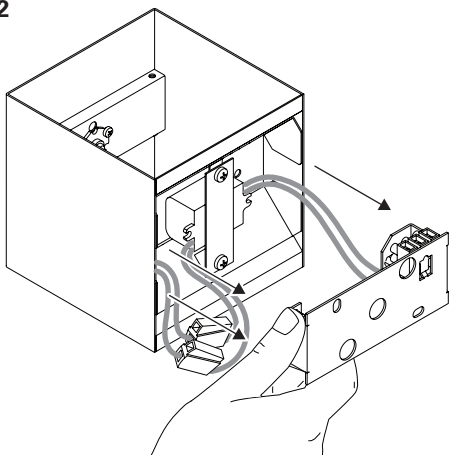

3

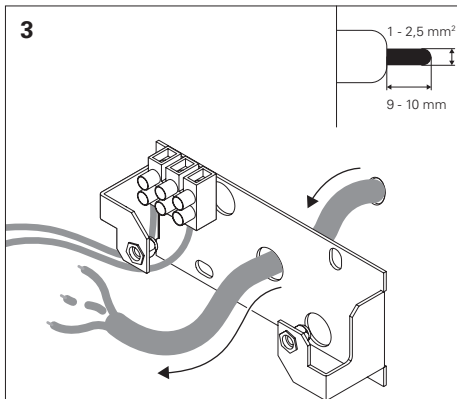

4

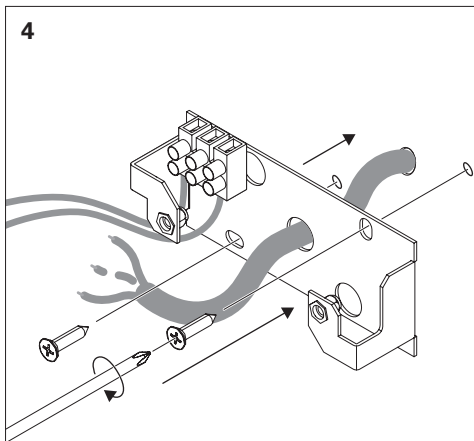

5

