

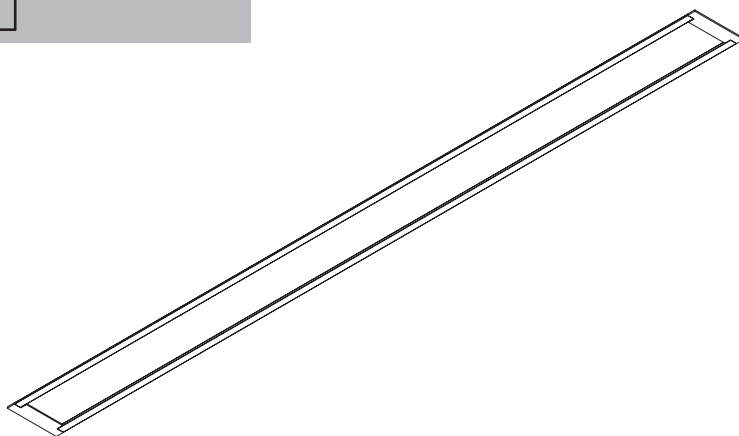

REBA 50 /E EXT | REBA 65 /E EXT**EN** INSTALLATION INSTRUCTIONS**FR** NOTICE DE MONTAGE**DE** MONTAGE-ANLEITUNG**PT** INSTRUÇÕES DE MONTAGEM**ES** INSTRUCCIONES DE MONTAJE**IIV659****EN** FOR MOUNTING, PLEASE READ THE SUPPLEMENTARY MANUALS.**FR** POUR LE MONTAGE, LIRE LES MANUELS SUPPLÉMENTAIRES.**DE** LESEN SIE ZUR MONTAGE, DIE ZUSÄTZLICHE ANLEITUNGEN.**PT** PARA A MONTAGEM, POR FAVOR, CONSULTE OS MANUAIS COMPLEMENTARES.**ES** PARA MONTAR, LEA LOS MANUALES COMPLEMENTARIOS.**IIV662**Order code / Code com. / Bestell-Nr. / Código / Código: **90520... | 90525...**

EN Please read carefully the installation instructions given before installing the appliance, the general terms and conditions of use and environmental concern with recycling attached. | **FR** Lire attentivement les notices de montage avant l'installation de l'appareil, les conditions générales de ventes et les précautions écologiques liées au recyclage ci-jointes. | **DE** Bitte lesen Sie sorgfältig die Montage-Anleitung, die Sie vorder Montage des Geräts erhalten haben, Allgemeinen Geschäftsbedingungen und Umweltbewusstsein über Recycling angeschlossen. | **PT** Leia atentamente as instruções de montagem fornecidas antes de instalar o aparelho, as condições gerais de uso e preocupação ambiental com a reciclagem, em anexo. | **ES** Lea atentamente las instrucciones de montaje proporcionadas antes de instalar el aparato, las condiciones generales de uso y la preocupación medioambiental con el reciclaje, que se adjuntan.

REBA 50 /E EXT | REBA 65 /E EXT

REBA 50 /E EXT		REBA 65 /E EXT	
	(mm)		(mm)
590x62x72	580x56	590x77x82	580x71
870x62x72	860x56	870x77x82	860x71
1150x62x72	1140x56	1150x77x82	1140x71
1430x62x72	1420x56	1430x77x82	1420x71
1710x62x72	1700x56	1710x77x82	1700x71
1992x62x72	1982x56	1992x77x82	1982x71
2272x62x72	2262x56	2272x77x82	2262x71
2552x62x72	2542x56	2552x77x82	2542x71
2832x62x72	2822x56	2832x77x82	2822x71

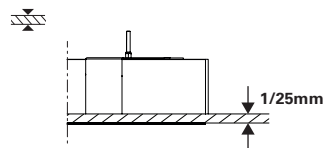

TOOLS
Phillips screwdriver

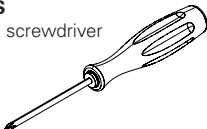

EN Accessories
FR Accessoires
DE Zubehör
PT Acessórios
ES Accesorios

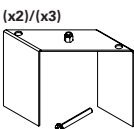
(x2)/(x3)

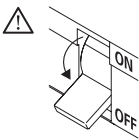

EN LUMINAIRE CAN NOT BE COVERED WITH THERMAL INSULATION.
FR LUMINAIRES NE POUVANT PAS ÊTRE RECOUVERTS DE MATÉRIAUX ISOLANT THERMIQUE.
DE LEUCHTE DIE NICHT MIT THERMISCH ISOLIERENDEN MATERIAL BEDECKT SEINKANN.
PT LUMINÁRIA, QUE NÃO PODE SER COBERTA COM MATERIAL ISOLANTE TÉRMICO.
ES LA LUMINARIA NO PUEDE SER CUBIERTA CON MATERIAL AISLANTE TÉRMICO.

90520... | 90525...

+ 
IIV662

SAFETY CABLE
FILIN D'ACIER
SICHERHEITSKABEL OPTION
CABO DE SEGURANÇA
CABLE DE SEGURIDAD

955000

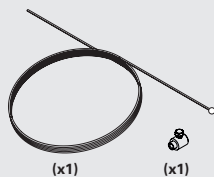
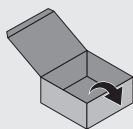
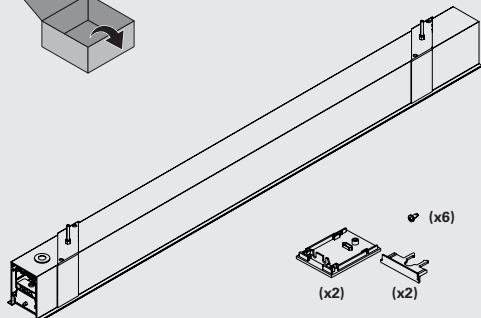
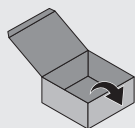

 (TOP VIEW)

REBA 50 / E EXT			
 (mm)	L	L1	
590x62x72	580		56
870x62x72	860		
1150x62x72	1140		
1430x62x72	1420		
1710x62x72	1700		
1992x62x72	1982		
2272x62x72	2262		
2552x62x72	2542		
2832x62x72	2822		

 (TOP VIEW)

REBA 65 / E EXT			
 (mm)	L	L1	
590x77x82	580		71
870x77x82	860		
1150x77x82	1140		
1430x77x82	1420		
1710x77x82	1700		
1992x77x82	1982		
2272x77x82	2262		
2552x77x82	2542		
2832x77x82	2822		

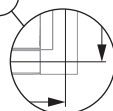
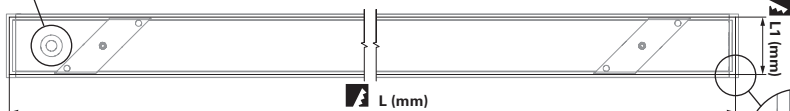
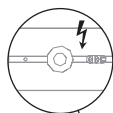

1

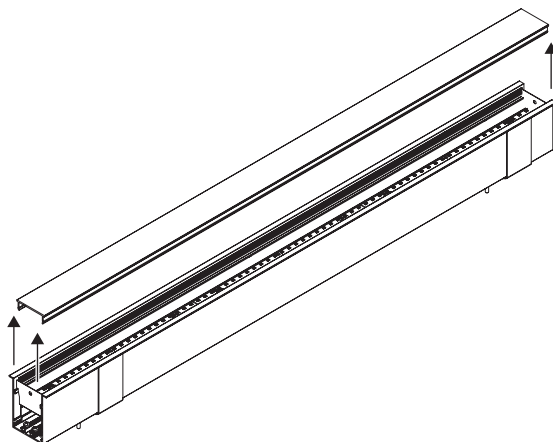

2

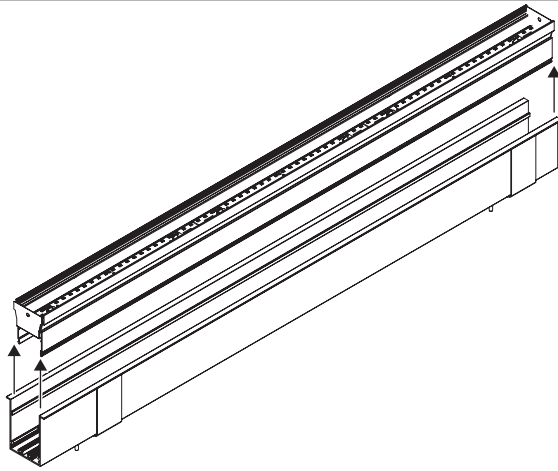

3

1.

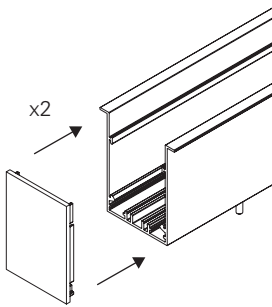

2.

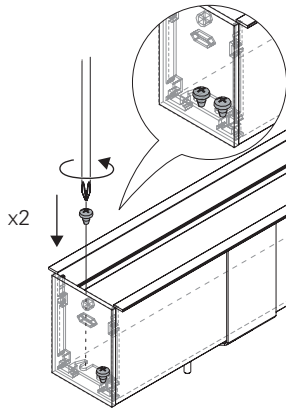

3.

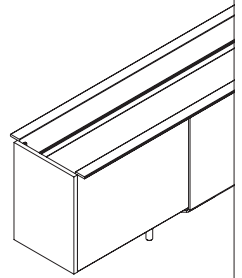

4

1.

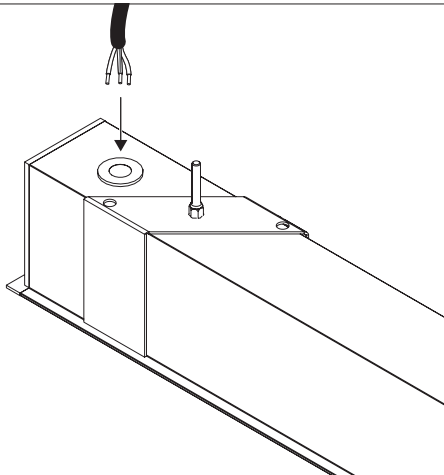

2.

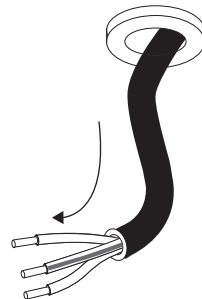

5 - SAFETY CABLE OPTION
OPTION FILIN D'ACIER
SICHERHEITSKABEL OPTION
OPÇÃO CABO DE SEGURANÇA
OPCIÓN CABLE DE SEGURIDAD

1.

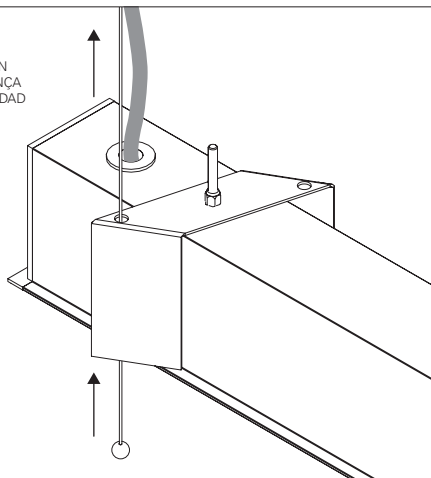

2.



6

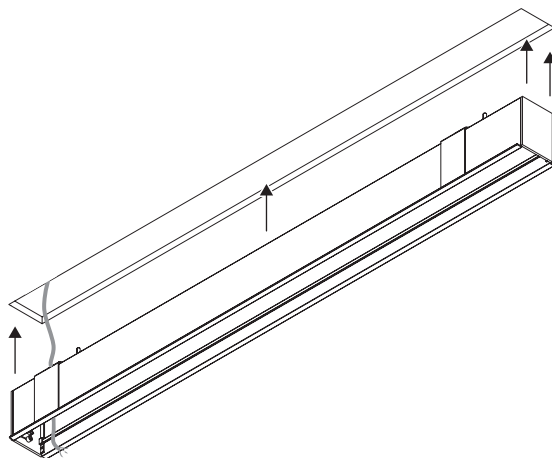

7

1.

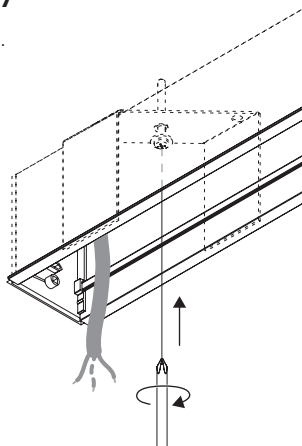

2.

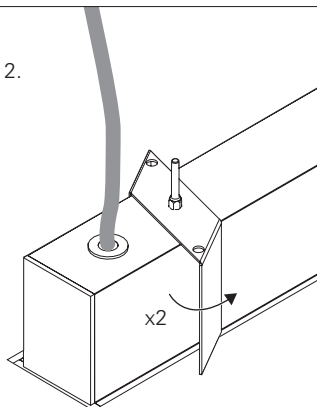

FOR LED MODULE PLEASE READ:
POUR PROFILÉ INTÉRIEUR LED LIRE:
FÜR INNEN LED PROFIL BITTE LESEN SIE:
PARA MÓDULO INTERIOR LED LER:
PARA PERFIL INTERIOR LED LEER:



IIV662

8

1.

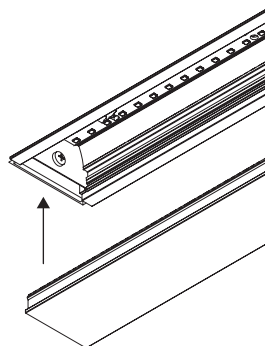

2.

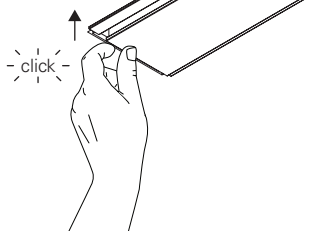

3.

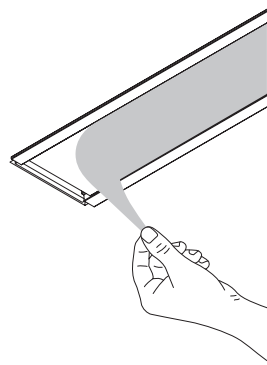

9

1.

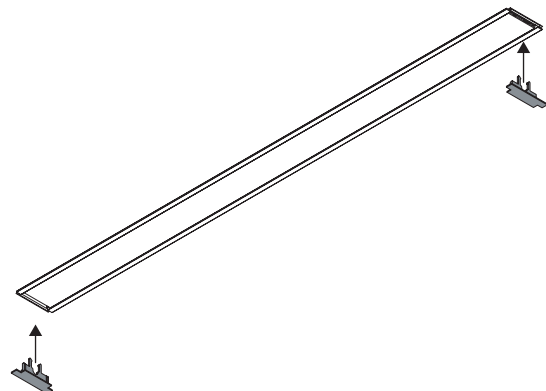

2.

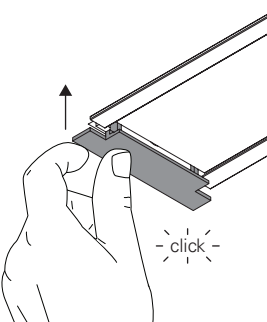

Info on (non-) replaceability

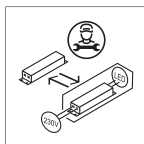
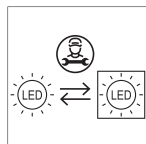

SEE THE SERVICES, TERMS AND CONDITIONS AT:
CONSULTEZ LES SERVICES, LES TERMES ET LES CONDITIONS À L'ADRESSE SUIVANTE
KONSULTIEREN SIE DIE DIENSTLEISTUNGEN UND BEDINGUNGEN UNTER:
CONSULTE OS SERVIÇOS, TERMOS E CONDIÇÕES EM:
CONSULTE LOS SERVICIOS, TÉRMINOS Y CONDICIONES EN:
WWW.INDELAGUEGROUP.COM

INDELAGUE - INDÚSTRIA ELÉCTRICA DE ÁGUEDA, S.A.
RUA DA MINA 465, COVÃO - ZONA INDUSTRIAL EN1 NORTE
3750-792 ÁGUEDA, PORTUGAL
T. +351 234 612 310