

## ROFY 85 IP /C

EN INSTALLATION INSTRUCTIONS

FR NOTICE DE MONTAGE

DE MONTAGEANLEITUNG

PT INSTRUÇÕES DE MONTAGEM

ES INSTRUCCIONES DE MONTAJE

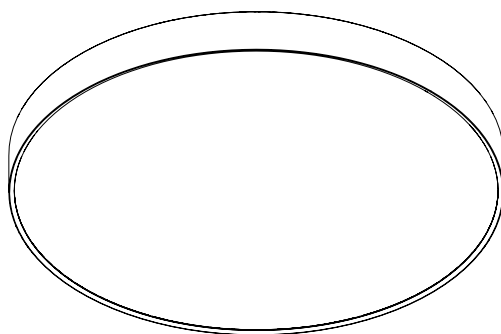

Order code / Code com. / Bestell-Nr. / Código / Código: 90581L...



EN Carefully read the instalation instructions provided before installing the device. Safety and Maintenance: Scan here.

FR Lire attentivement les notices de montage avant l'installation de l'appareil. Sécurité et Entretien: Sancez ici.

DE Bitte lesen die mitgelieferte Montageanleitungen vor de Montage des Geräts. Sicherheit und Wartung: Hier scannen.

PT Leia atentamente as instruções de montagem fornecidas antes de instalar o aparelho. Segurança e Manutenção: Scan aqui.

ES Lea atentamente las instrucciones de montaje proporcionadas antes de instalar el aparato. Seguridad y Mantenimiento: Escanea aqui.



# ROFY 85 IP /C



(mm) 2px  
Ø300x85  
Ø400x85  
Ø600x85 ▶

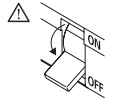

## TOOLS | OUTILS | WERKZEUG | FERRAMENTAS | HERRAMIENTAS

Phillips screwdriver  
Long nose pliers



**EN** USE GLOVES.  
**FR** UTILISEZ DES GANTS.  
**DE** HANDSCHUHE BENUTZEN.  
**PT** UTILIZE LUVAS.  
**ES** USE GUANTES.



**EN** DO NOT PRESS – RISK OF BREAKAGE.  
**FR** NICHT DRÜCKEN – BRUCHGEFAHR.  
**DE** NE PAS APPUYER – RISQUE DE CASSE.  
**PT** NÃO PRESSIONE – RISCO DE QUEBRA.  
**ES** NO PRESIONAR – RIESGO DE ROTURA.

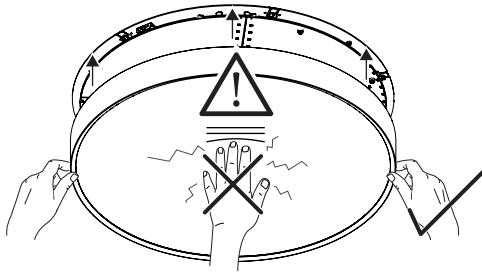

## ROFY 85 IP /C

90581L...

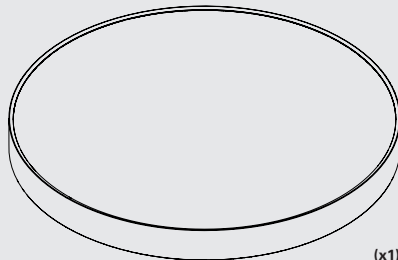

  
(x2/x3)

(x1)

ROFY 85 IP /C

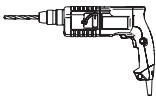

ROFY 85 IP /C				
(mm)	R	α	A	Fixings
ø300x85	117	120°	203	3
ø400x85	166	90°	235	4
ø600x85	268	60°	268	6

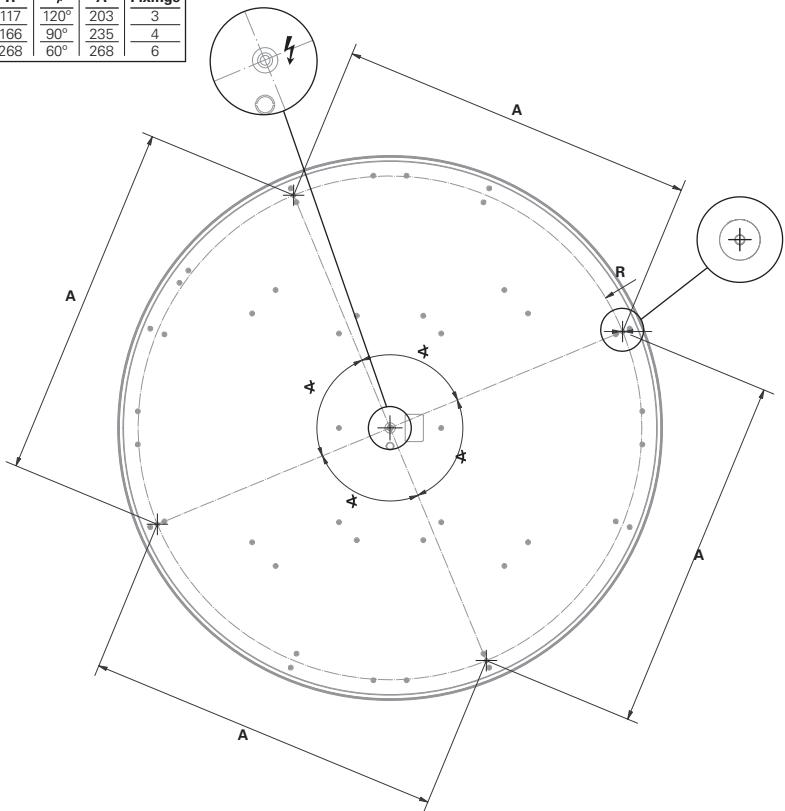

1

1.

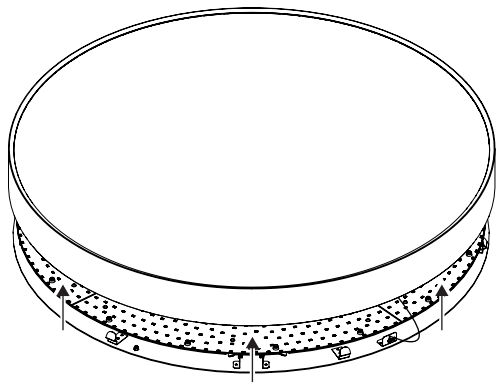

2.

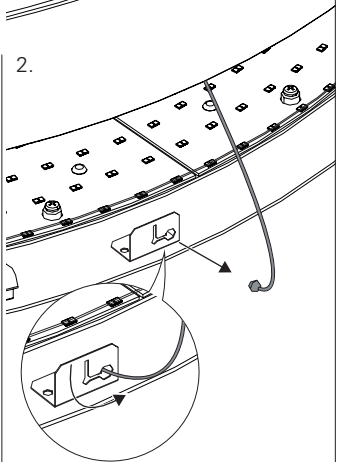

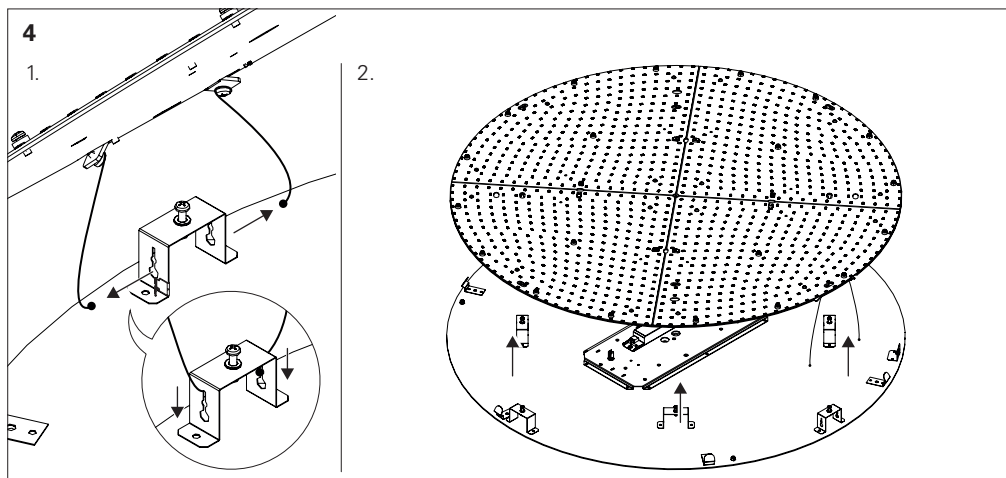
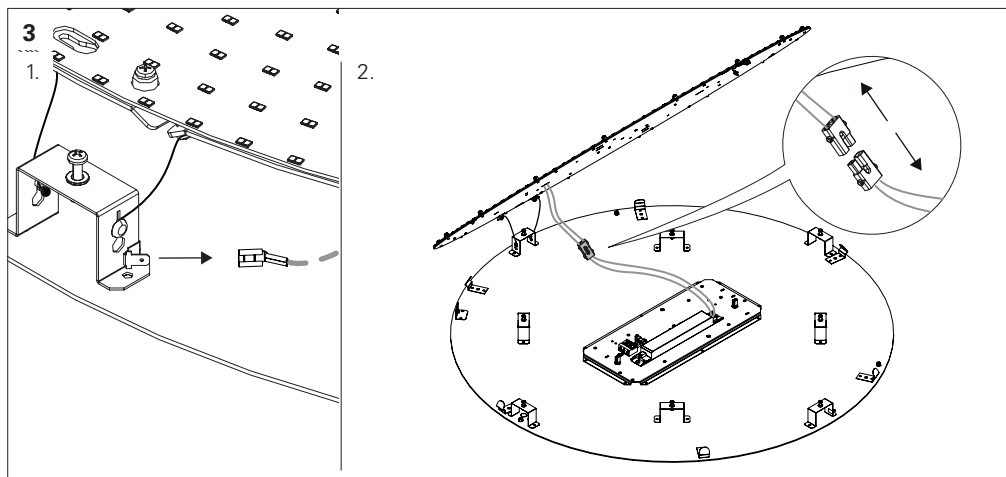
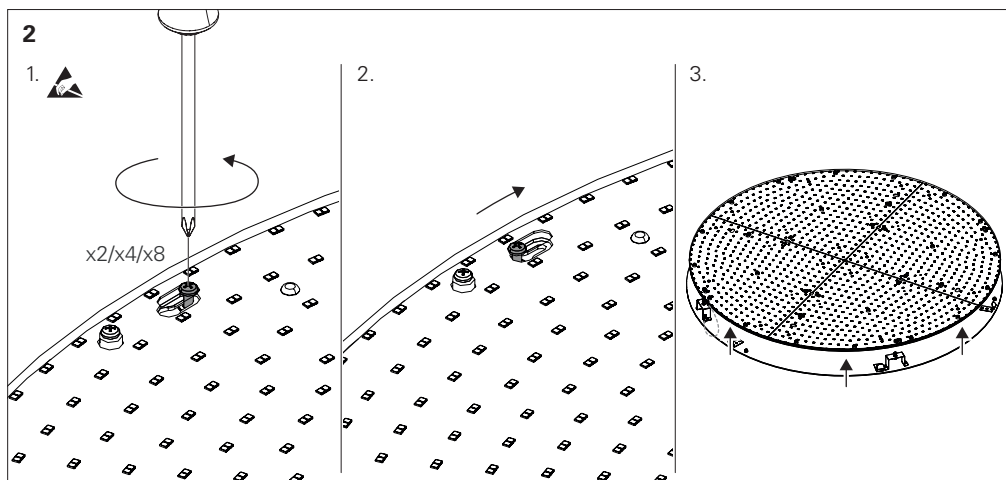

5

1.

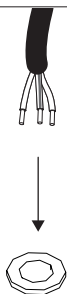

2.

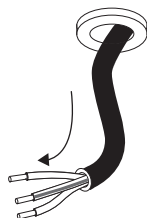

6

2px  
Ø600x85

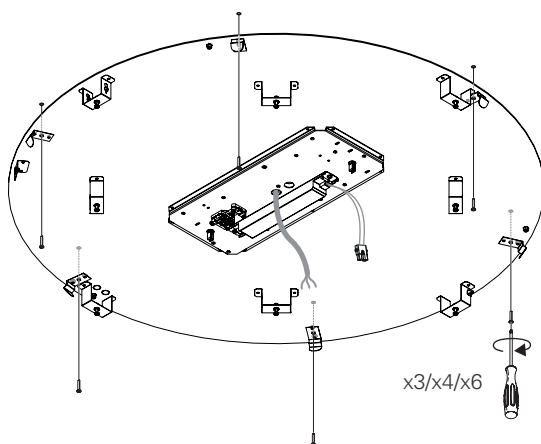

x3/x4/x6

7

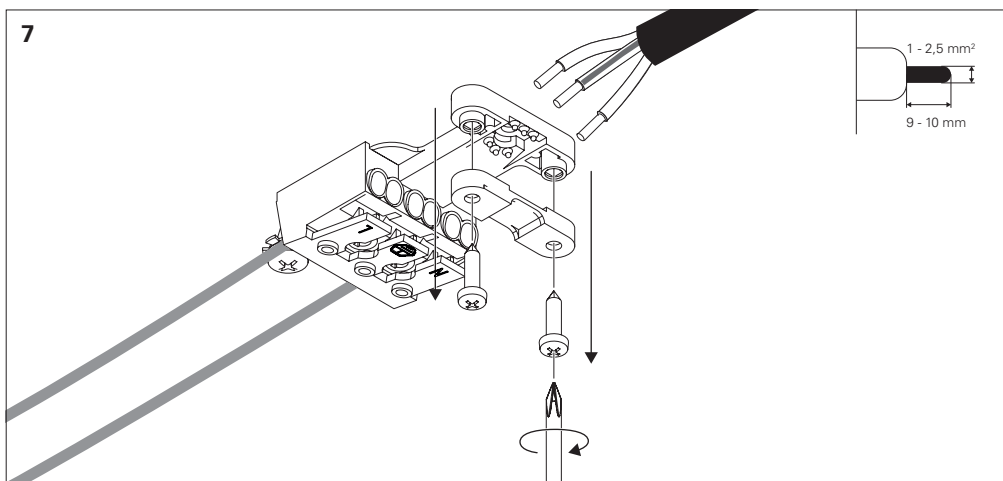

1 - 2,5 mm<sup>2</sup>  
9 - 10 mm

## 8 - HF

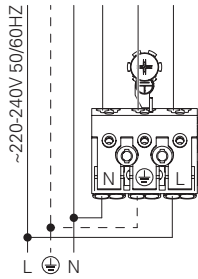

## DALI

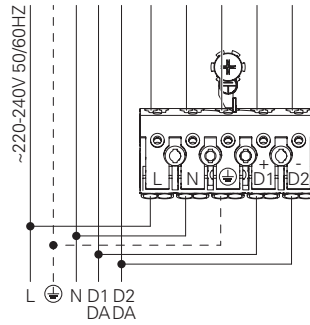

## 8 - HF + K3 + TEL.

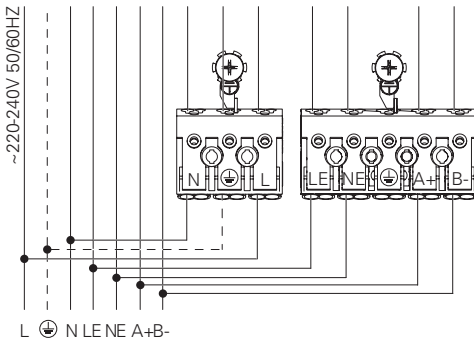

## 8 - DALI + K3 + TEL.

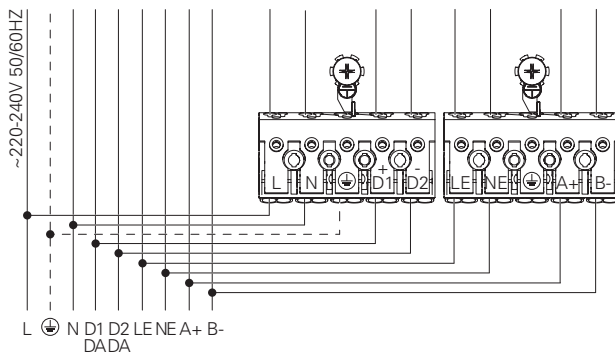

9

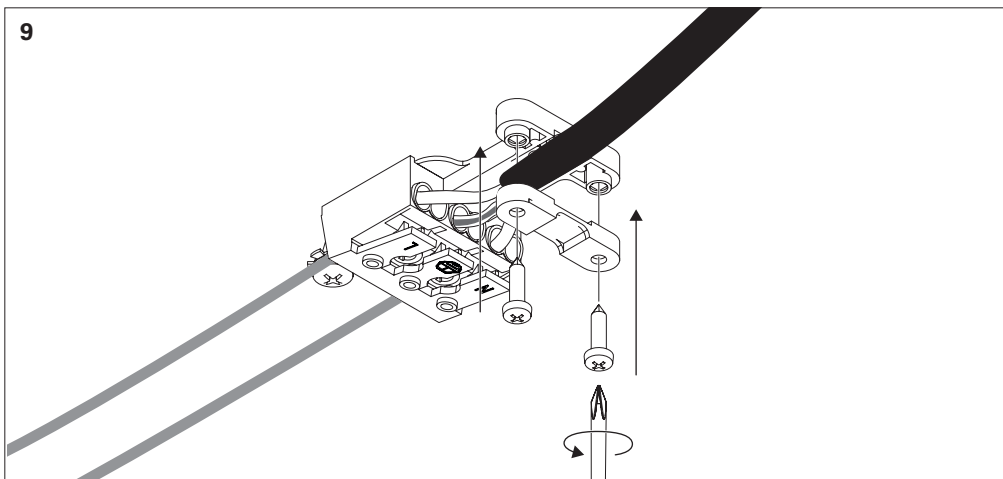

10

1.

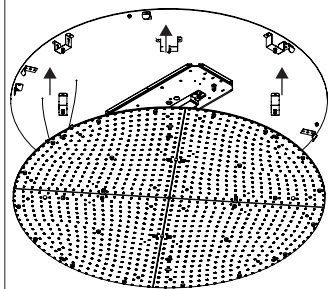

2.

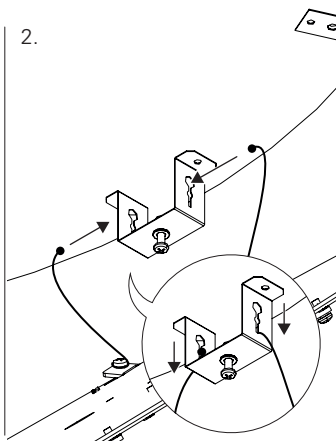

3.

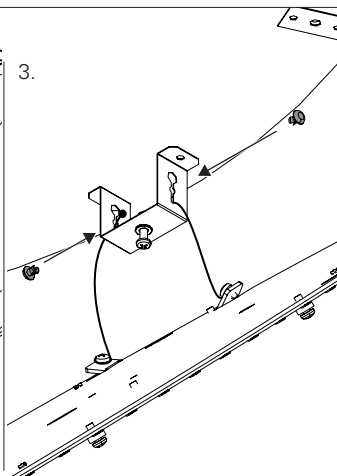

11

1.

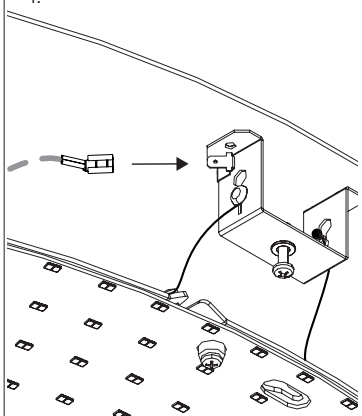

2.

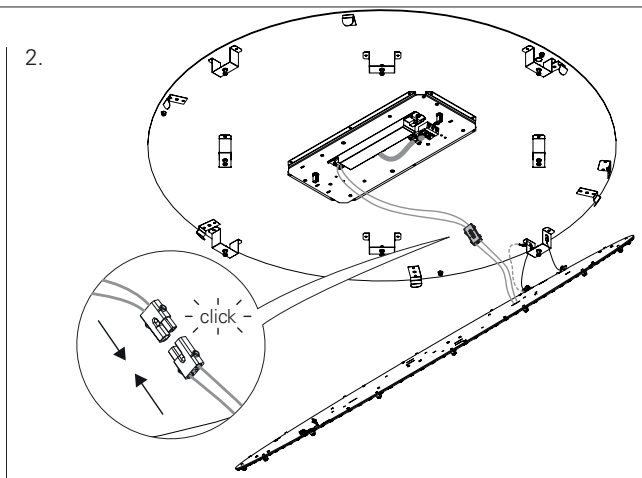

1. 

2.

The diagram shows a curved path defined by two parallel lines, with an arrow indicating the direction of travel. A vector field is represented by a grid of small squares, each containing a dot and a cross, indicating a direction of flow. A particle trajectory is shown as a series of circles, starting from the left and moving towards the right, following the curve of the path.

3.

A diagram of a 2D hexagonal lattice. A central unit cell is highlighted with a thick black border. This unit cell contains a small circle with a dot in the center and a small square with a dot in the center. The lattice is composed of many such unit cells. A curved line passes through the lattice, and a small circle with a dot is shown on this line. The text  $x2/x4/x8$  is written next to the line.

 $x^2/x^4/x^8$ 

1.

1.

2.



Ø600x85

2px



- click -