

CONCEPT S 35 / E

EN INSTALLATION INSTRUCTIONS

FR NOTICE DE MONTAGE

DE MONTAGEANLEITUNG

PT INSTRUÇÕES DE MONTAGEM

ES INSTRUCCIONES DE MONTAJE

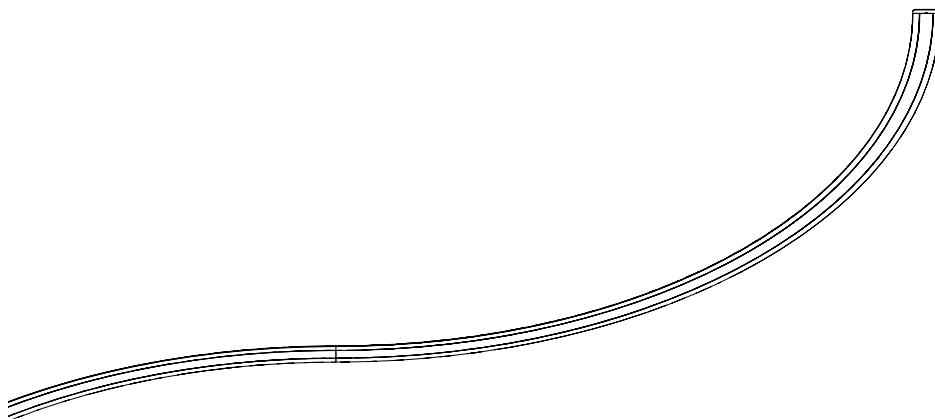

Order code / Code com. / Bestell-Nr. / Código / Código: | 90709... | 90710... | 90711... | 90712... | 90713...

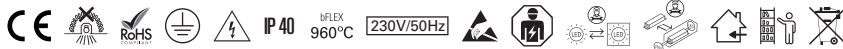

EN Carefully read the instalation instructions provided before installing the device. Safety and Maintenance: Scan here.

FR Lire attentivement les notices de montage avant l'installation de l'appareil. Sécurité et Entretien: Sancez ici.

DE Bitte lesen die mitgelieferte Montageanleitungen vor de Montage des Geräts. Sicherheit und Wartung: Hier scannen.

PT Leia atentamente as instruções de montagem fornecidas antes de instalar o aparelho. Segurança e Manutenção: Scan aqui.

ES Lea atentamente las instrucciones de montaje proporcionadas antes de instalar el aparato. Seguridad y Mantenimiento: Escanea aqui.



CONCEPT S 35 /E

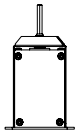

H

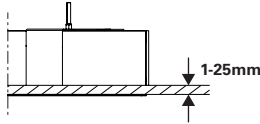

L1

1/16 (22,5°)



DxL1xH (mm)
Ø7939x58x99,5

1/8 (45°)



DxL1xH (mm)
Ø1856x58x99,5
Ø2572x58x99,5
Ø2929x58x99,5
Ø4003x58x99,5
Ø5792x58x99,5

1/4 (90°)



DxL1xH (mm)
Ø1139x58x99,5
Ø1497x58x99,5
Ø1856x58x99,5
Ø2572x58x99,5
Ø2929x58x99,5
Ø4003x58x99,5

1/2 (180°)



DxL1xH (mm)
Ø780x58x99,5
Ø1139x58x99,5
Ø1497x58x99,5
Ø1856x58x99,5

LINE

DxL1xH (mm)
843x58x99,5
1124x58x99,5
1405x58x99,5
1686x58x99,5
1967x58x99,5
2248x58x99,5
2529x58x99,5
2810x58x99,5

TOOLS | OUTILS | WERKZEUG | FERRAMENTAS | HERRAMIENTAS

Umbrako 4 mm
TORX T10

Phillips screwdriver
Long nose pliers



EN USE GLOVES.
FR UTILISEZ DES GANTS.
DE HANDSCHUHE BENUTZEN.
PT UTILIZE LUVAS.
ES USE GUANTES.



EN LUMINAIRES WITH 24V DRIVERS DO HAVE AN AUDIBLE NOISE. IT IS NOT A FAILURE; DUE TO THE PWM FREQUENCIES, SOME COMPONENTS GENERATE NOISE. THIS NOISE CAN APPEAR LOUDER IN APPLICATIONS WHERE THE DRIVER IS INSTALLED IN PLACES WHERE THE SOUND BOUNCES, CREATING AN ECHO OR TUNNEL EFFECT.

FR LES LUMINAIRES ÉQUIPÉS DE DRIVERS 24V ÉMETTENT UN BRUIT AUDIBLE DÙ AUX FRÉQUENCES PWM. CE BRUIT PEUT ÊTRE AMPLIFIÉ DANS LES ESPACES OÙ LE SON SE RÉFLÈCHIT, CRÉANT UN EFFET D'ÉCHO OU DE TUNNEL. IL NE S'AGIT CEPENDANT PAS D'UN DÉFAUT, MAIS D'UNE CARACTÉRISTIQUE INTRINSÈQUE DU FONCTIONNEMENT DE CES COMPOSANTS.

DE LEUCHTEN MIT 24-VOLT-TREIBERN GEBEN AUFGRUND VON PWM-FREQUENZEN EIN HÖRBARES GERÄUSCH AB. DIESES GERÄUSCH KANN AN BEREICHEN VERSTÄRKT WERDEN, IN DENEN DER SCHALL REFLEKTIERT WIRD, WODURCH EIN ECHO ODER EIN TUNNELEFFECT ENTSTEHT. DABEI HANDELT ES SICH JEDOCH NICHT UM EINEN DEFECT, SONDERN UM EIN UNVERMEIDBARES MERKMAL DES BETRIEBS DIESER KOMPONENTEN.

PT LUMINÁRIAS COM DRIVERS DE 24V EMITEM UM RUÍDO AUDÍVEL DEVIDO ÀS FREQUÊNCIAS PWM. ESSE SOM PODE SER AMPLIFICADO EM LOCAIS ONDE O SOM REFLETE, CRIANDO UM EFEITO DE ECO OU TÚNEL. NO ENTANTO, ISSO NÃO REPRESENTA UMA FALHA, MAS SIM UMA CARACTERÍSTICA INERENTE AO FUNCIONAMENTO DESSES COMPONENTES.

ES LAS LUMINARIAS CON DRIVERS DE 24 V EMITEN UN RUIDO PERCEPTIBLE DEBIDO A LAS FRECUENCIAS PWM. ESTE RUIDO PUEDE AMPLIFICARSE EN LUGARES DONDE EL SONIDO SE REFLEJA, CREANDO UN ECO O EFECTO TUNEL. SIN EMBARGO, NO SE TRATA DE UN FALLO, SINO DE UNA CARACTERÍSTICA INHERENTE AL FUNCIONAMIENTO DE ESTOS COMPONENTES.



EN ASSEMBLE THE MODULE IN THE DIRECTION OF THE ARROW.
FR ASSEMBLEZ LE MODULE DANS LE SENS DE LA FLECHE.
DE MONTIEREN SIE DAS MODUL IN PFEILRICHTUNG.
PT MONTAR O MÓDULO NO SENTIDO DA SETA.
ES MONTE EL MÓDULO EN LA DIRECCIÓN DE LA FLECHA.



CONCEPT S 35 / E

90709... | 90710... | 90711... |
90712... | 90713...

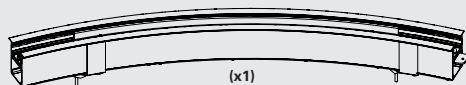

START KIT KIT DÉBUT DE LIGNE START KIT START KIT START KIT

923010...

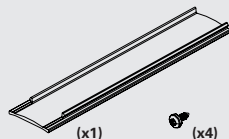
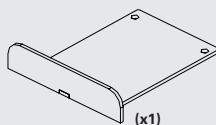

BODY CONNECTOR KIT UNION KIT VERBINDUNG KIT DE UNIÃO KIT DE UNIÓN

9320...

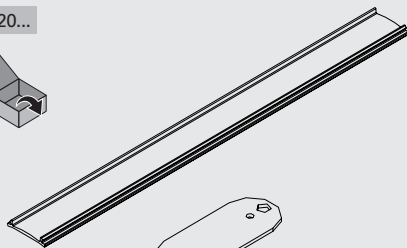

DIFFUSER DIFFUSEUR DIFFUSOR DIFUSOR DIFUSOR

9857...

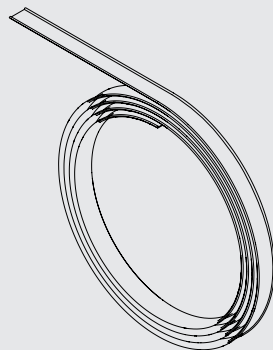

SAFETY CABLE FILIN D'ACIER SICHERHEITSKABEL OPTION CABO DE SEGURANÇA CABLE DE SEGURIDAD

955000

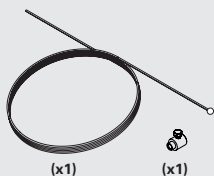

CONCEPT S 35 /E

1/16 (22,5°)



Left and Right module (SRT/MID/END)

CONCEPT S 35 /E					
⬡ (mm)	⌒	R	R ₁	R ₂	L ₁
ø7939x58x99,5	22,5	7881	3916 - 3918,5	3962,5 - 3965	1549

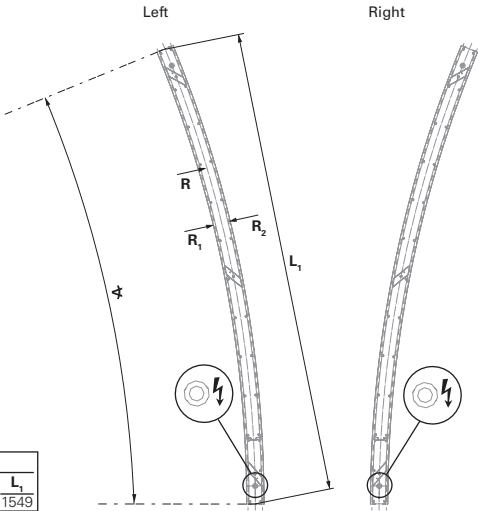

1/8 (45°)



Left and Right module (SRT/MID/END)

CONCEPT S 35 /E					
⬡ (mm)	⌒	R	R ₁	R ₂	L ₁
ø1856x58x99,5	45	1798	874,5 - 877	921 - 923,5	710
ø2572x58x99,5	45	2514	1232,5 - 1235	1279 - 1281,5	984
ø2929x58x99,5	45	2871	1411 - 1413,5	1457,5 - 1460	1121
ø4003x58x99,5	45	3945	1948 - 1950,5	1994,5 - 1997	1532
ø5792x58x99,5	45	5734	2842,5 - 2845	2889 - 2891,5	2217

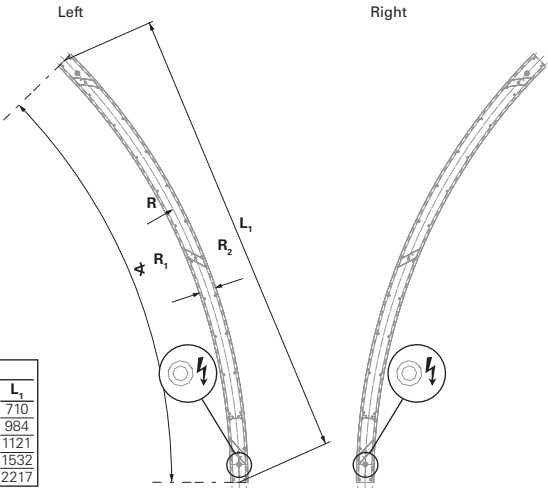

CONCEPT S 35 /E

1/4 (90°)



Left and Right module (SRT/MID/END)

CONCEPT S 35 /E					
Ø (mm)	ϕ	R	R ₁	R ₂	L ₁
ø1139x58x99,5	90	1081	516 - 518,5	562,5 - 565	805
ø1497x58x99,5	90	1439	695 - 697,5	741,5 - 744	1059
ø1856x58x99,5	90	1798	874,5 - 877	921 - 923,5	1312
ø2572x58x99,5	90	2514	1232,5 - 1235	1279 - 1281,5	1818
ø2929x58x99,5	90	2871	1411 - 1413,5	1457,5 - 1460	2071
ø4003x58x99,5	90	3945	1948 - 1950,5	1994,5 - 1997	2831

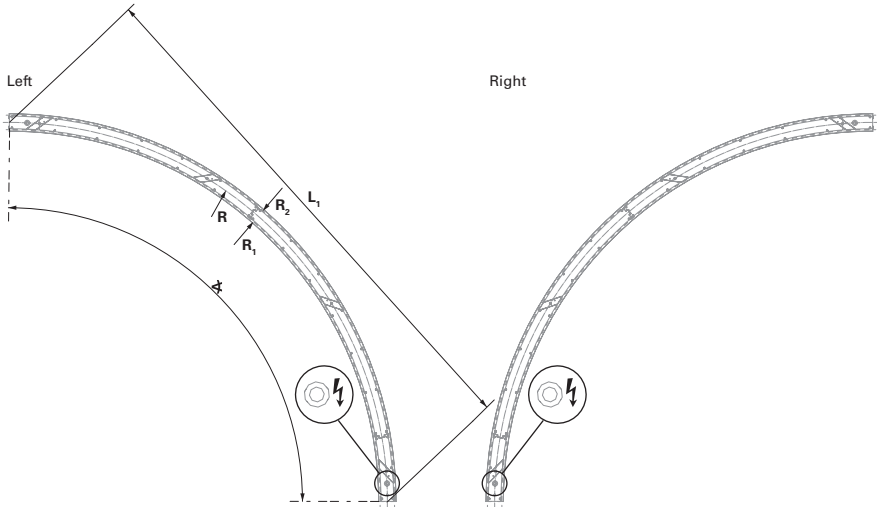

1/2 (180°)



Left and Right module (SRT/MID/END)

CONCEPT S 35 /E					
Ø (mm)	ϕ	R	R ₁	R ₂	L ₁
ø780x58x99,5	180	722	336,5 - 339	383 - 385,5	722
ø1139x58x99,5	180	1081	516 - 518,5	562,5 - 565	1081
ø1497x58x99,5	180	1439	695 - 697,5	741,5 - 744	1439
ø1856x58x99,5	180	1798	874,5 - 877	921 - 923,5	1798

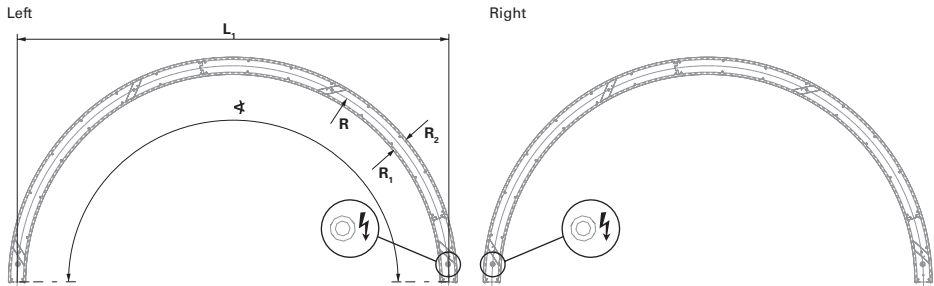

CONCEPT S 35 /E

Linear

(SRT/MID/END)

CONCEPT S 35 /E	
⬡ (mm)	⚡ C
843x58x99,5	44 - 49
1124x58x99,5	
1405x58x99,5	
1686x58x99,5	
1967x58x99,5	
2248x58x99,5	
2529x58x99,5	
2810x58x99,5	

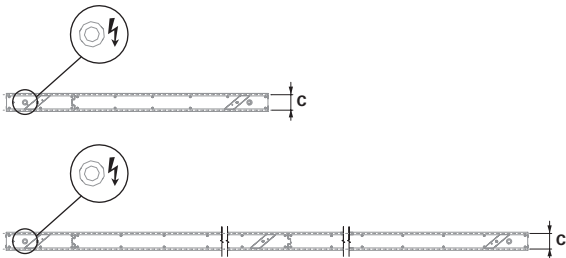

1

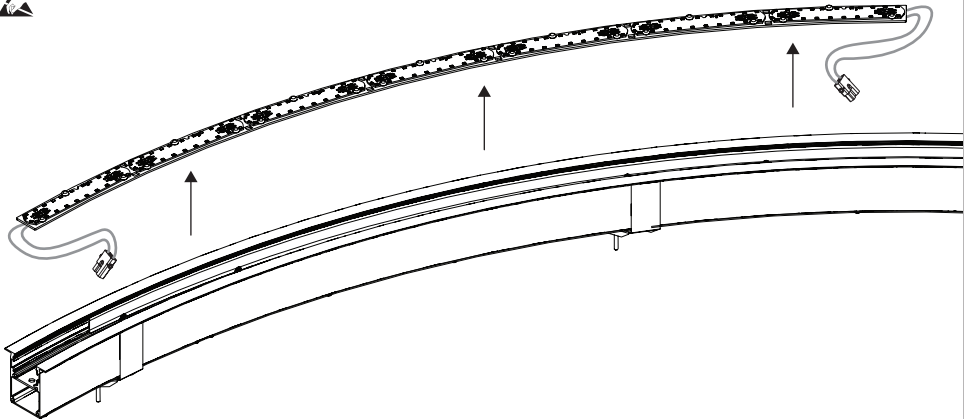

2

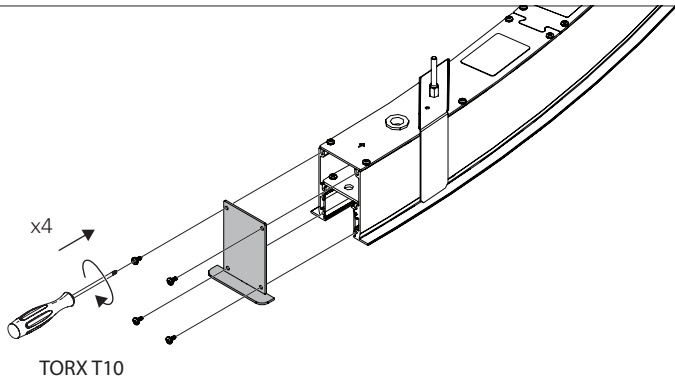

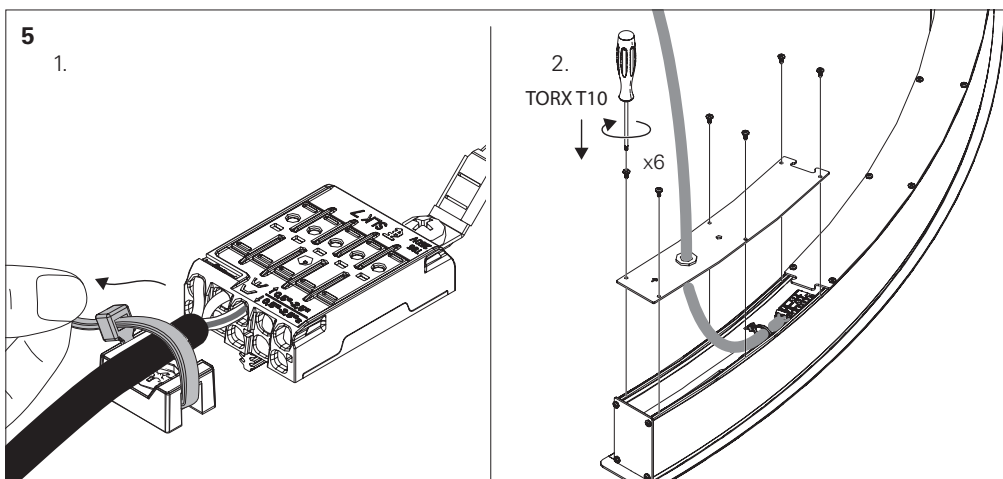
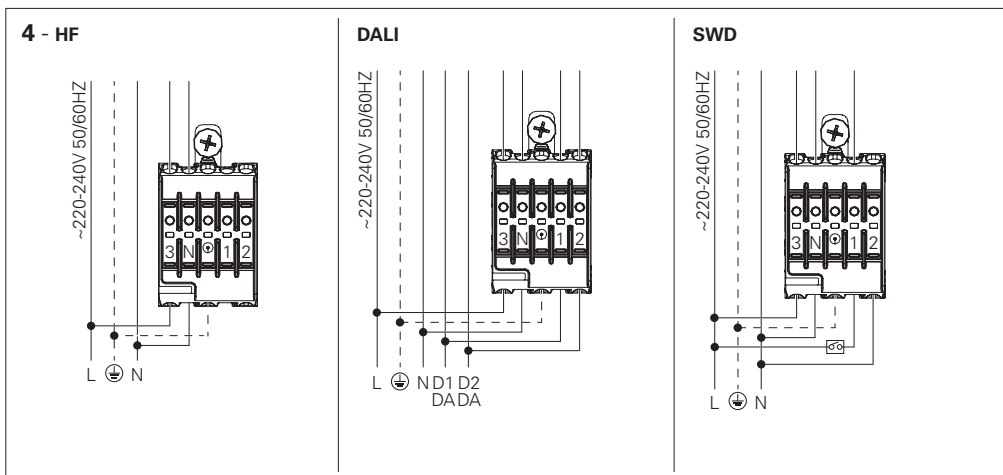
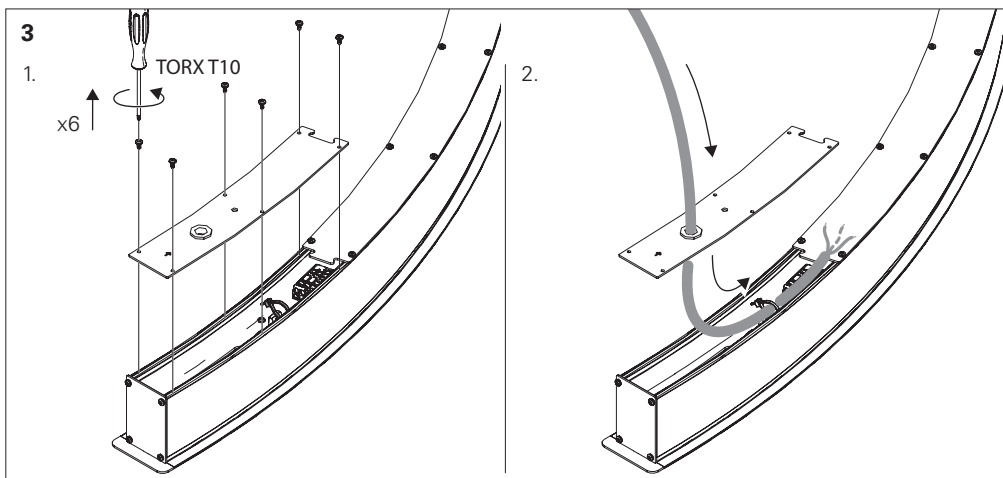

6 - SAFETY CABLE OPTION
 OPTION FILIN D'ACIER
 SICHERHEITSKABEL OPTION
 OPÇÃO CABO DE SEGURANÇA
 OPCIÓN CABLE DE SEGURIDAD

1.

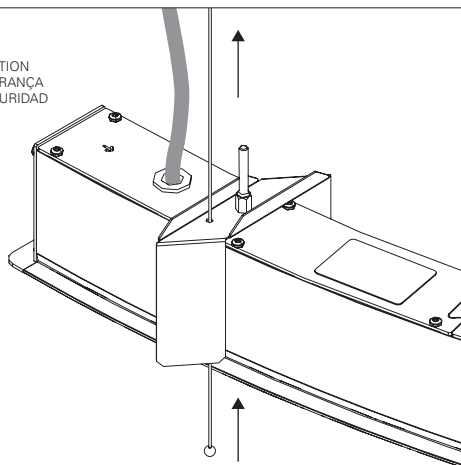

2.



7



EN ASSEMBLE THE MODULE IN THE DIRECTION OF THE ARROW.

FR ASSEMBLEZ LE MODULE DANS LE SENS DE LA FLECHE.

DE MONTIEREN SIE DAS MODUL IN PFEILRICHTUNG.

PT MONTAR O MÓDULO NO SENTIDO DA SETA.

ES MONTE EL MÓDULO EN LA DIRECCIÓN DE LA FLECHA.

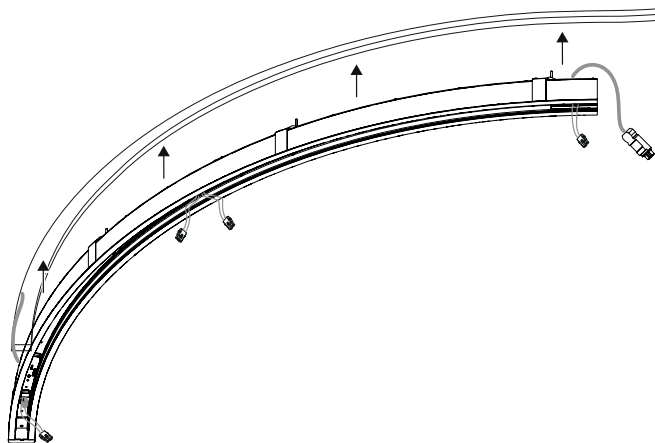

8

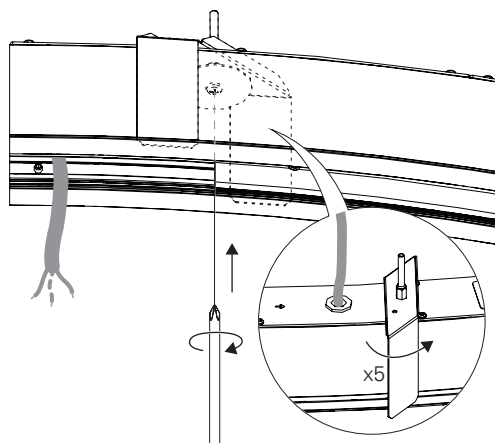

9

1.

2.

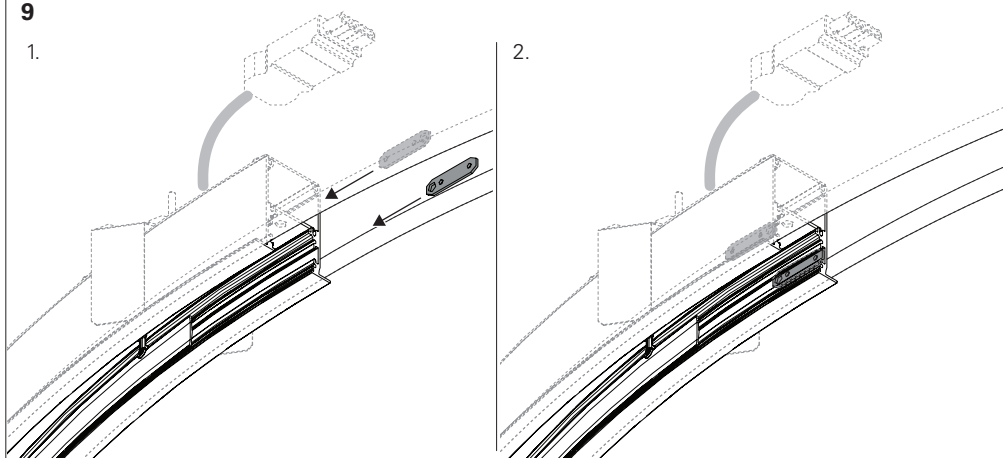

10

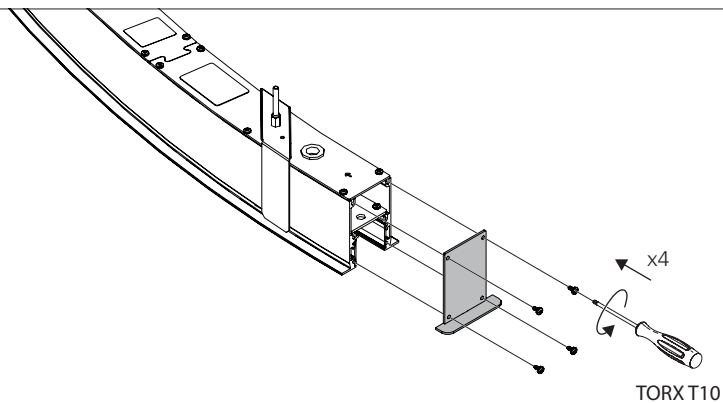

11

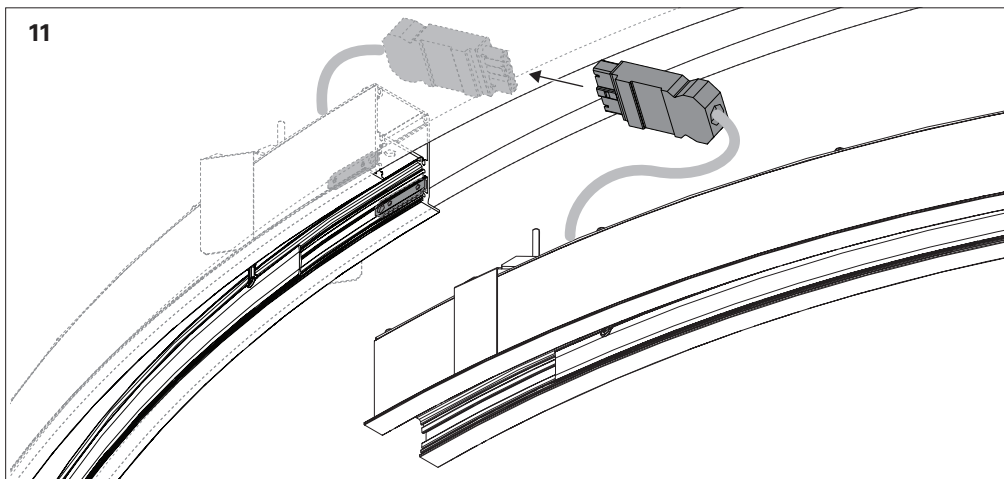

12

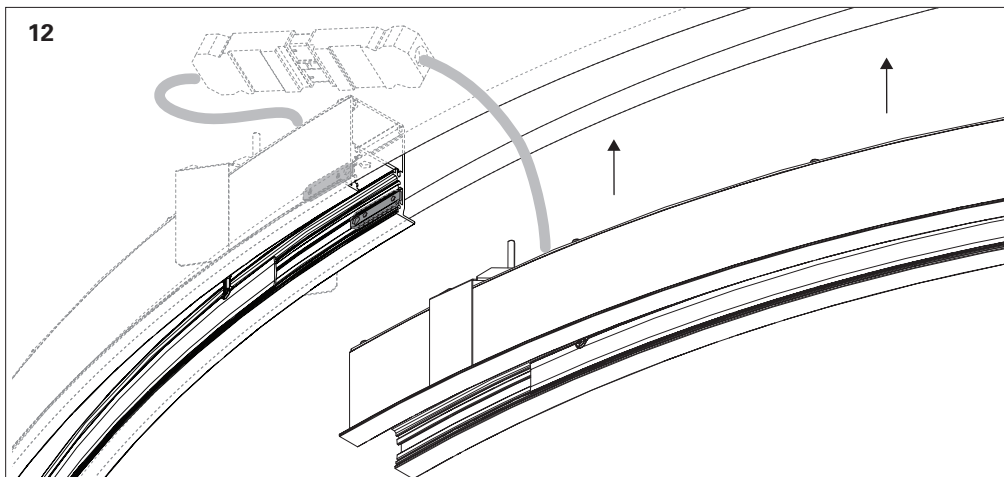

13

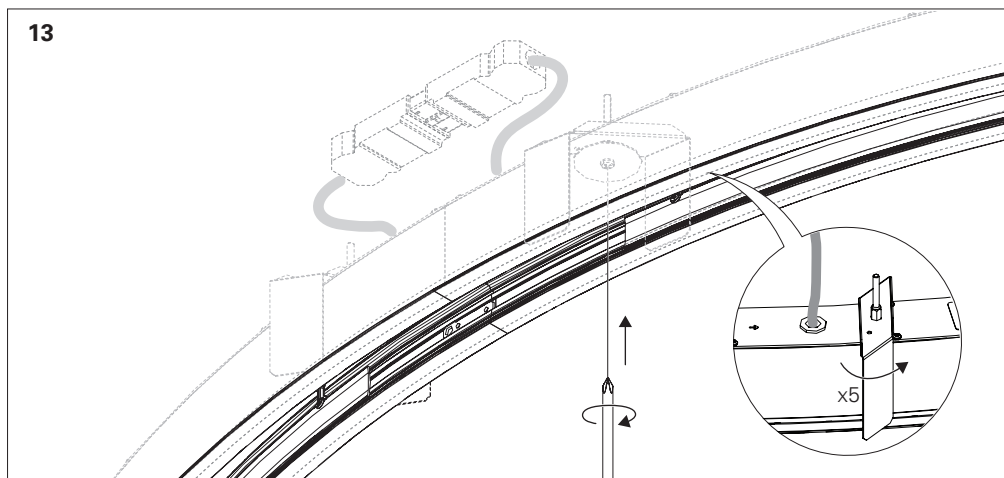

14

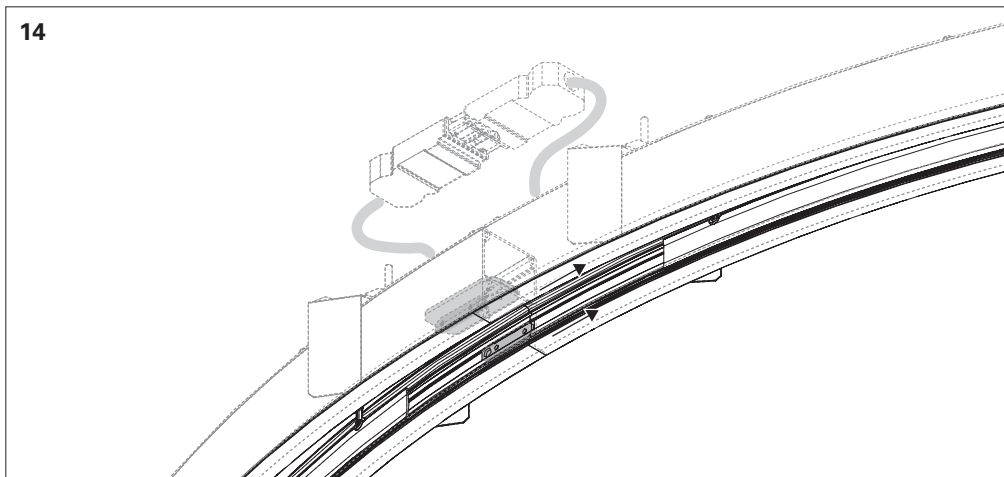

15

1.

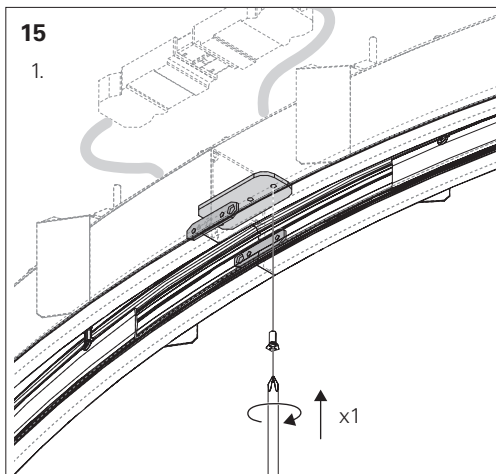

2.

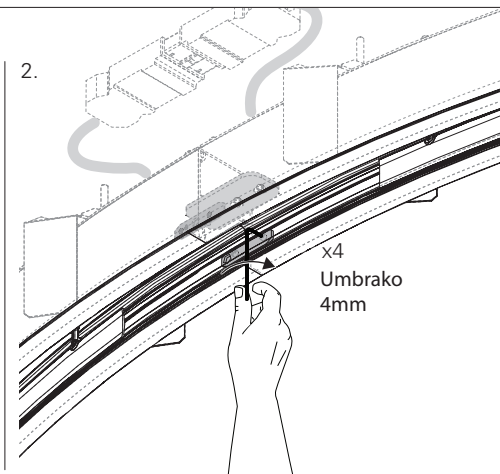

16

1.

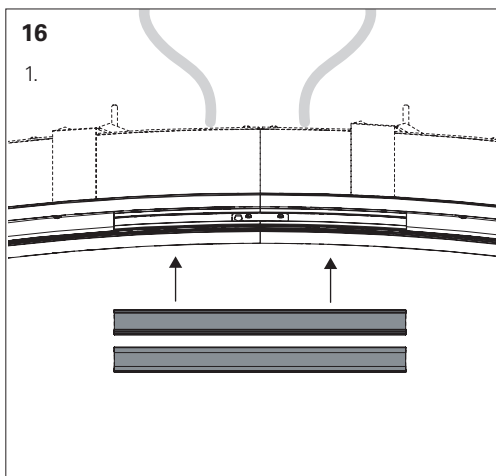

2.

