

CONCEPT O 35 | CONCEPT O 35 D/I**(Ø455 | Ø777 | Ø1136 | Ø1494)****EN** INSTALLATION INSTRUCTIONS**FR** NOTICE DE MONTAGE**DE** MONTAGEANLEITUNG**PT** INSTRUÇÕES DE MONTAGEM**ES** INSTRUCCIONES DE MONTAJE

EN READ THE SUPPLEMENTARY MANUALS.
FR LIRE LES NOTICES DE MONTAGE SUPPLÉMENTAIRES.
DE LESEN SIE DIE ZUSÄTZLICHEN MONTAGEANLEITUNGEN
PT CONSULTE OS MANUAIS COMPLEMENTARES.
ES LEA LOS MANUALES COMPLEMENTARIOS.

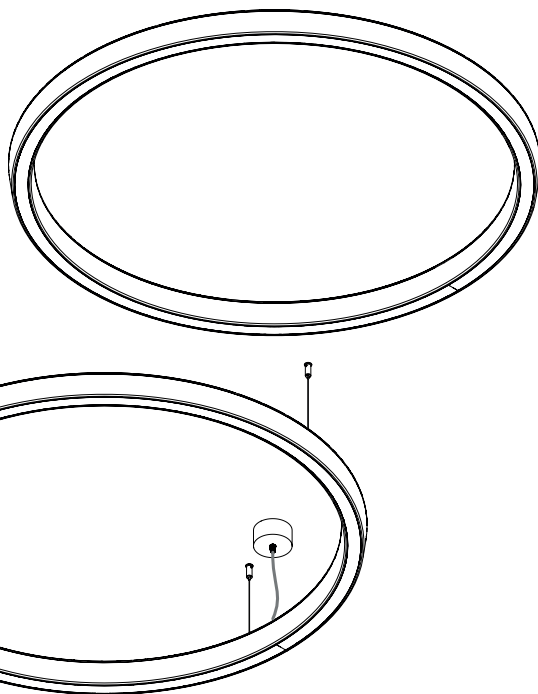

IIV675 | IIV683 |
IIV966 | IIV881 |
IIV882



Order code / Code com. / Bestell-Nr. / Código / Código: 90539L012... | 90539L016... | 90539L024... | 90539L032... |
 90540L016... | 90540L024... | 90540L032...



EN Carefully read the installation instructions provided before installing the device. Safety and Maintenance: Scan here.

FR Lire attentivement les notices de montage avant l'installation de l'appareil. Sécurité et Entretien: Scannez ici.

DE Bitte lesen die mitgelieferte Montageanleitung vor der Montage des Geräts. Sicherheit und Wartung: Hier scannen.

PT Leia atentamente as instruções de montagem fornecidas antes de instalar o aparelho. Segurança e Manutenção: Scan aqui.

ES Lea atentamente las instrucciones de montaje proporcionadas antes de instalar el aparato. Seguridad y Mantenimiento: Escanea aquí.

CONCEPT O 35

CONCEPT O 35 D/I

1/1 (360°)



DxH (mm)
Ø455x56
Ø777x56
Ø1136x56
Ø1494x56



TOOLS | OUTILS | WERKZEUG | FERRAMENTAS | HERRAMIENTAS

TORX T10
Phillips screwdriver
Long nose pliers



EN USE GLOVES.
FR UTILISEZ DES GANTS.
DE HANDSCHUHE BENUTZEN.
PT UTILIZE LUVAS.
ES USE GUANTES.



EN LUMINAIRES WITH 24V DRIVERS DO HAVE AN AUDIBLE NOISE. IT IS NOT A FAILURE; DUE TO THE PWM FREQUENCIES, SOME COMPONENTS GENERATE NOISE. THIS NOISE CAN APPEAR LOUDER IN APPLICATIONS WHERE THE DRIVER IS INSTALLED IN PLACES WHERE THE SOUND BOUNCES, CREATING AN ECHO OR TUNNEL EFFECT.

FR LES LUMINAIRES ÉQUIPÉS DE DRIVERS 24V ÉMETTENT UN BRUIT AUDIBLE DÙ AUX FRÉQUENCES PWM. CE BRUIT PEUT ÊTRE AMPLIFIÉ DANS LES ESPACES OÙ LE SON SE RÉFLÈCHIT, CRÉANT UN EFFET D'ÉCHO OU DE TUNNEL. IL NE S'AGIT CEPENDANT PAS D'UN DÉFAUT, MAIS D'UNE CARACTÉRISTIQUE INTRINSÈQUE DU FONCTIONNEMENT DE CES COMPOSANTS.

DE LEUCHTEN MIT 24-VOLT-TREIBERN GEBEN AUFGRUND VON PWM-FREQUENZEN EIN HÖRBARES GERÄUSCH AB. DIESES GERÄUSCH KANN AN BEREICHEN VERSTÄRKT WERDEN, IN DENEN DER SCHALL REFLEKTIERT WIRD, WODURCH EIN ECHO ODER EIN TUNNELEFFECT ENTSTEHT. DABEI HANDELT ES SICH JEDOCH NICHT UM EINEN DEFECT, SONDERN UM EIN UNVERMEIDBARES MERKMAL DES BETRIEBS DIESER KOMONENTEN.

PT LUMINÁRIAS COM DRIVERS DE 24V EMITEM UM RUÍDO AUDÍVEL DEVIDO ÀS FREQUÊNCIAS PWM. ESSE SOM PODE SER AMPLIFICADO EM LOCAIS ONDE O SOM REFLETE, CRIANDO UM EFEITO DE ECO OU TÚNEL. NO ENTANTO, ISSO NÃO REPRESENTA UMA FALHA, MAS SIM UMA CARACTERÍSTICA INERENTE AO FUNCIONAMENTO DESSES COMPONENTES.

ES LAS LUMINARIAS CON DRIVERS DE 24 V EMITEN UN RUIDO PERCEPTIBLE DEBIDO A LAS FRECUENCIAS PWM. ESTE RUIDO PUEDE AMPLIFICARSE EN LUGARES DONDE EL SONIDO SE REFLEJA, CREANDO UN ECO O EFECTO TÚNEL. SIN EMBARGO, NO SE TRATA DE UN FALLO, SINO DE UNA CARACTERÍSTICA INHERENTE AL FUNCIONAMIENTO DE ESTOS COMPONENTES.

CONCEPT O 35 | CONCEPT O 35 D/I

90539L012... | 90539L016... |
90539L024... | 90539L032... |
90540L016... | 90540L024... |
90540L032...

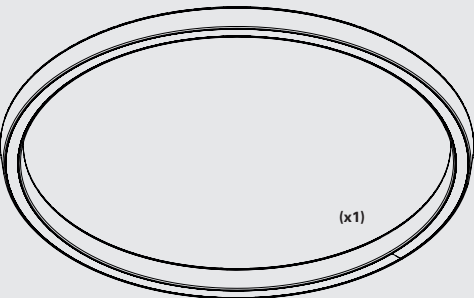
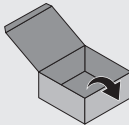

S11 SUSPENSION SUSPENSION S11 SEILABHÄNGUNG S11 SUSPENSÃO S11 SUSPENSIÓN S11

+
IIV675

9129...

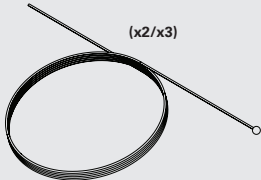
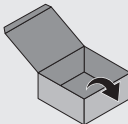

CURRENT SUPPLY CABLE
CÂBLE D'ALIMENTATION
EINSPEISUNGSKABEL
CABO DE ALIMENTAÇÃO
CABLE DE ALIMENTACIÓN

9404... | 9405...

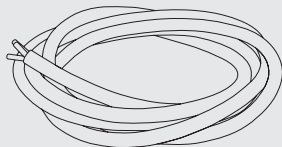

(x1)

CEILING ROSE
PATÈRE DE SUSPENSION
DECKENDOSE
CAIXA DE ALIMENTAÇÃO
BASE DE TETO

971300...

RECESSED CEILING ROSE T5 D90
PATÈRE DE SUSPENSION ENCASTRÉE T5 D90
DECKENDOSE ZUM EINBAU T5 D90
CAIXA DE ALIMENTAÇÃO ENCASTRAR T5 D90
BASE DE TETO DE EMPOTRAR T5 D90



(x1)



(x2/x4/x6)



(x1)



(x1)

CENTRAL CEILING ROSE
PATÈRE DE SUSPENSION CENTRALE
ZENTRALE DECKENDOSE
CAIXA DE ALIMENTAÇÃO CENTRAL
BASE DE TETO CENTRAL

977201 | 977202 | 977204

CENTRAL CEILING ROSET20 / T21
PATÈRE DE SUSPENSION CENTRALE T20 / T21
ZENTRALE DECKENDOSE T20 / T21
CAIXA DE ALIMENTAÇÃO CENTRAL T20 / T21
BASE DE TETO CENTRAL T20 / T21

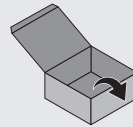

(x1)



(x2/x4/x6)

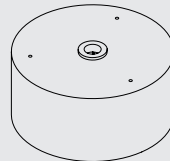

(x1)

+ 
IIV966

978700...

RECESSED CEILING ROSE T27 D90
PATÈRE DE SUSPENSION ENCASTRÉE T27 D90
DECKENDOSEN ZUM EINBAU T27 D90
CAIXA DE ALIMENTAÇÃO ENCASTRAR T27 D90
BASE DE TETO DE EMPOTRAR T27 D90



(x2)



(x8)



(x1)

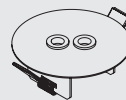

(x1)

979000...

SURFACE MOUNTED CEILING ROSE T64 D85
 PATÈRE DE SUSPENSION SAILLIET64 D85
 DECKENDOSE ZUM ANBAUT64 D85
 CAIXA DE ALIMENTAÇÃO SALIENTE T64 D85
 BASE DE TECHO DE SUPERFICIE T64 D85

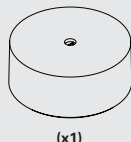

979003...

SURFACE MOUNTED CEILING ROSE T69 D85
 PATÈRE DE SUSPENSION SAILLIET69 D85
 DECKENDOSE ZUM ANBAU T69 D85
 CAIXA DE ALIMENTAÇÃO SALIENTE T69 D85
 BASE DE TECHO DE SUPERFICIE T69 D85

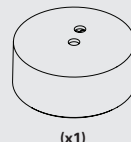

979001...

CENTRAL CEILING ROSET67
 PATÈRE DE SUSPENSION CENTRALE T67
 ZENTRALE DECKENDOSE T67
 CAIXA DE ALIMENTAÇÃO CENTRAL T67
 BASE DE TECHO CENTRAL T67

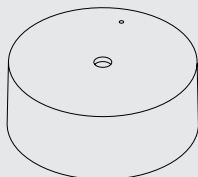

979002...

CENTRAL CEILING ROSE T68
 PATÈRE DE SUSPENSION CENTRALE T68
 ZENTRALE DECKENDOSE T68
 CAIXA DE ALIMENTAÇÃO CENTRAL T68
 BASE DE TECHO CENTRAL T68

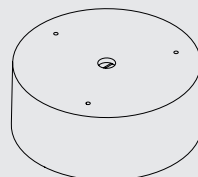

CONCEPT O 35

SURFACE MOUNTED
SAILLIE
ANBAU
SALIENTE
SUPERFICIE

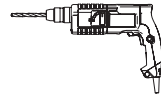

CONCEPT O 35							
	R	\varnothing_1	\varnothing_2	A	B	C	Fixings
$\varnothing 455 \times 56$	200	120	-	346	-	38,5	3
$\varnothing 777 \times 56$	361	80,4	99,6	466	552	85	4
$\varnothing 1136 \times 56$	540,5	83,6	96,4	721	806	131	4
$\varnothing 1494 \times 56$	719,5	56	68	676	805	377	6

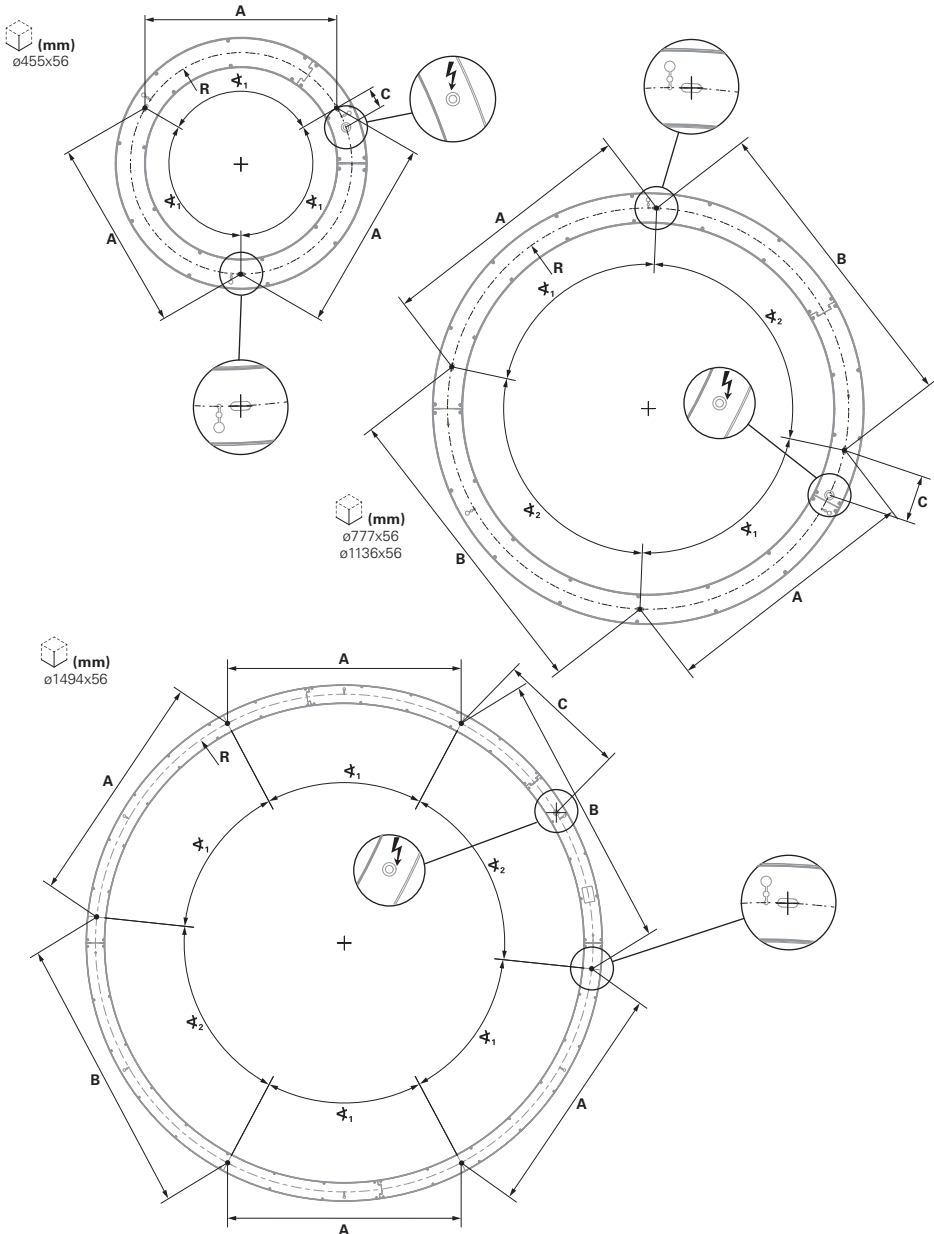

CONCEPT O 35



EN SURFACE MOUNTED

FR SAILLIE

DE ANBAU

PT SALIENTE

ES SUPERFICIE

1

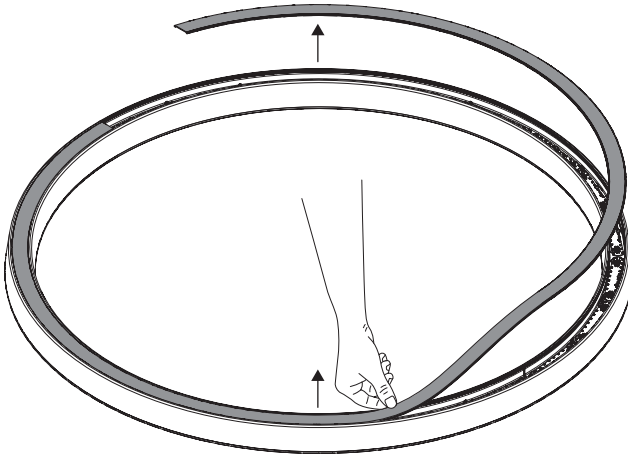

1.1

1.

press
presse
pressione
pressa



2.

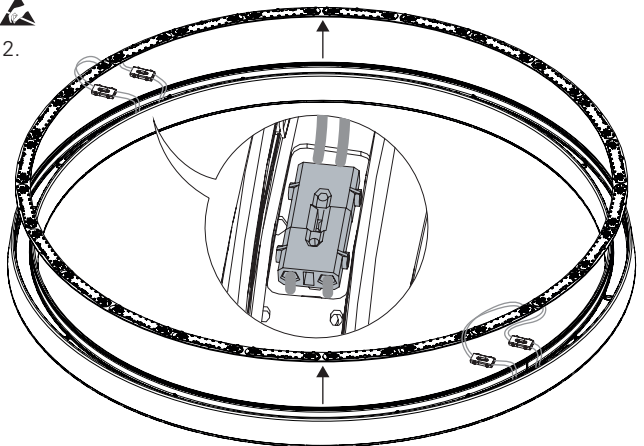

1.2

1.

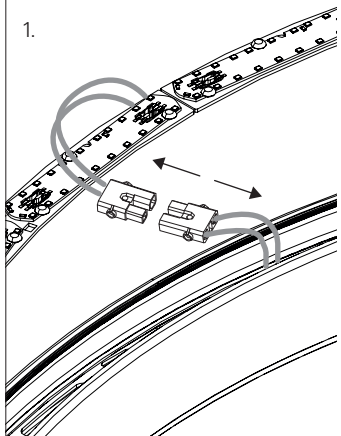

2.

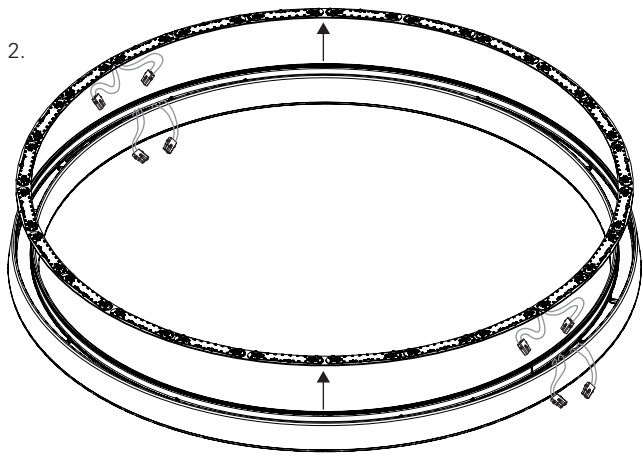

1.3

1.

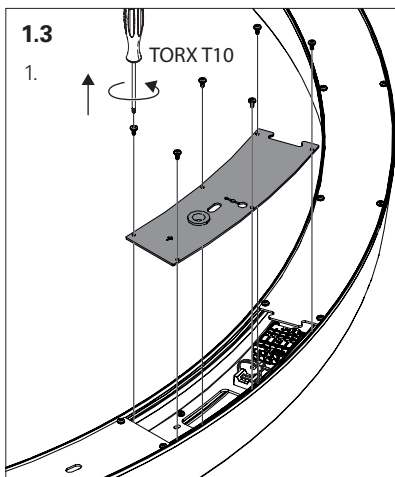

2.

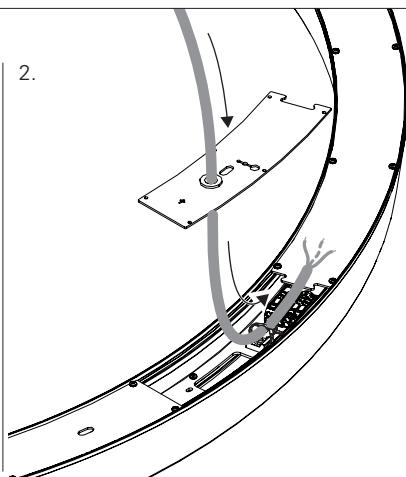

1.4 - HF

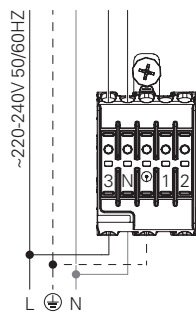

DALI

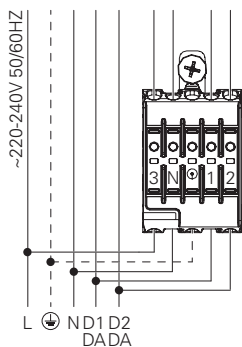

SWD

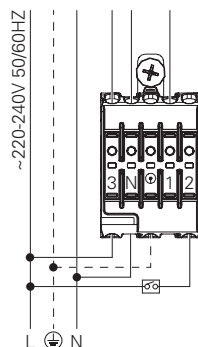

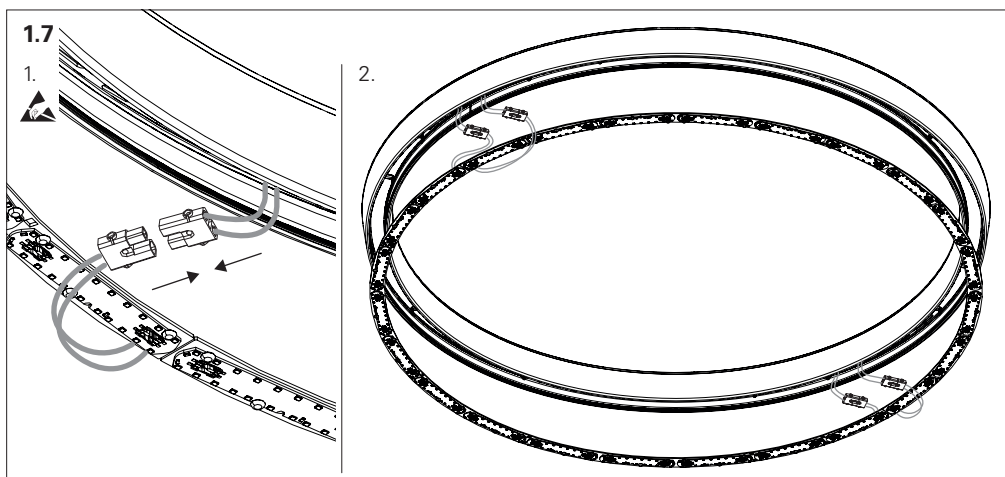
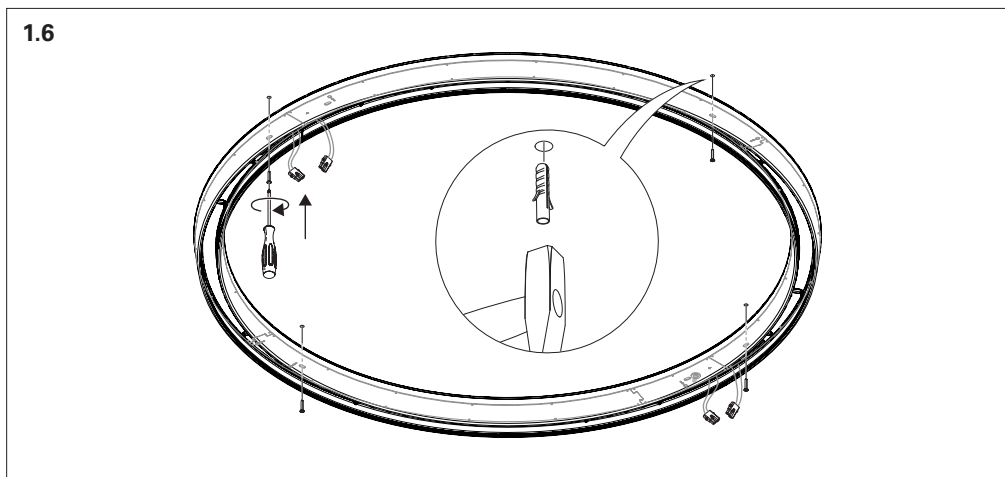
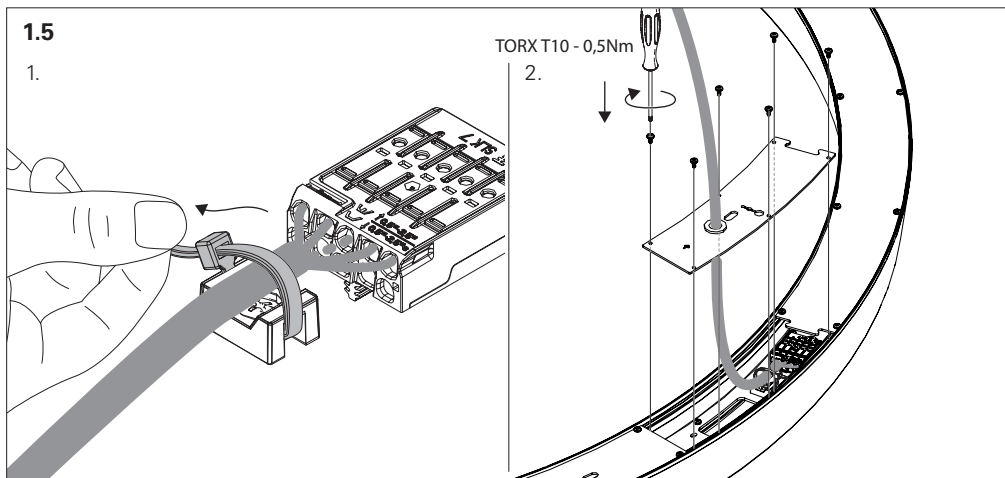

1.8

1. 

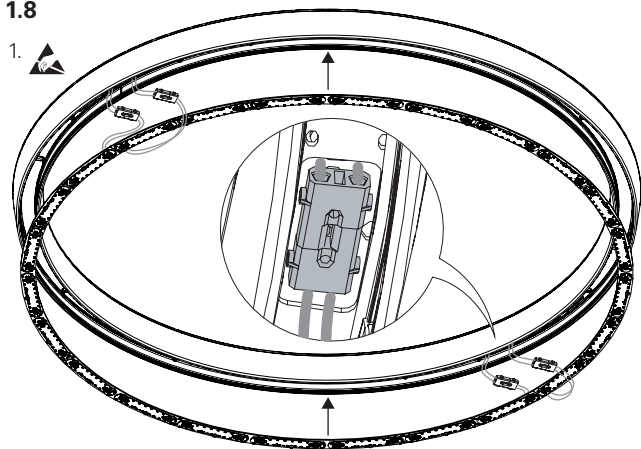

2.

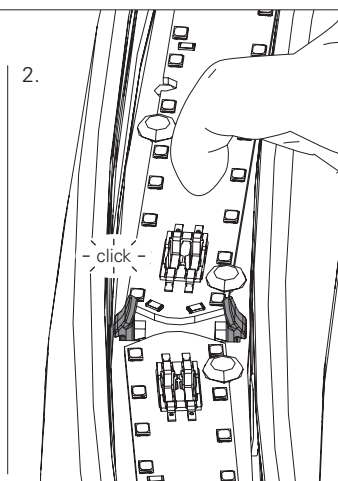

1.9

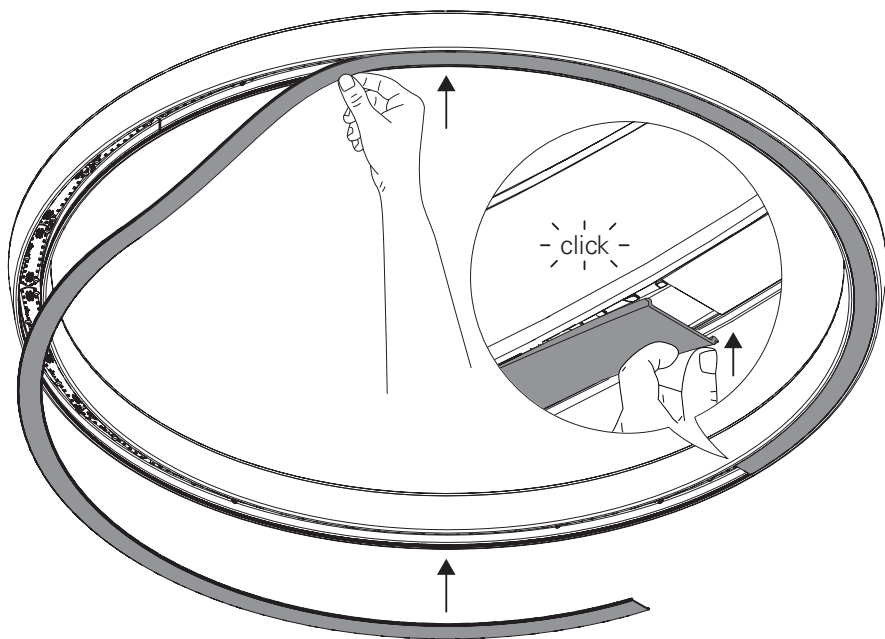

CONCEPT O 35 | CONCEPT O 35 D/I

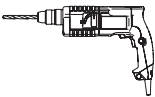

SUSPENDED
SUSPENDU
PENDEL
SUSPENSO
SUSPENDIDO

CONCEPT O 35		CONCEPT O 35 D/I		Suspensions	
 $\varnothing 455 \times 56$	R 200	ϕ_1 120	A 346	B 21	3
$\varnothing 777 \times 56$	361	120	625	28	3
$\varnothing 1136 \times 56$	540,5	90	764	34	4
$\varnothing 1494 \times 56$	719,5	60	720	20	6

 (mm)
 $\varnothing 455 \times 56$
 $\varnothing 777 \times 56$

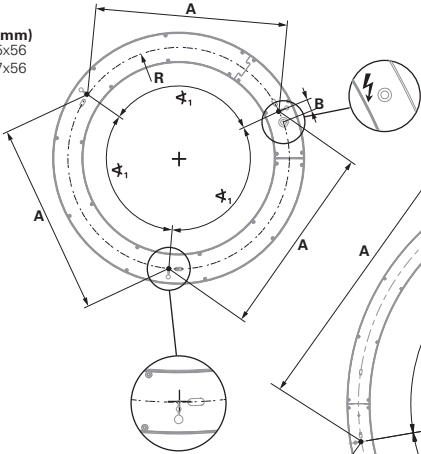

 (mm)
 $\varnothing 1136 \times 56$

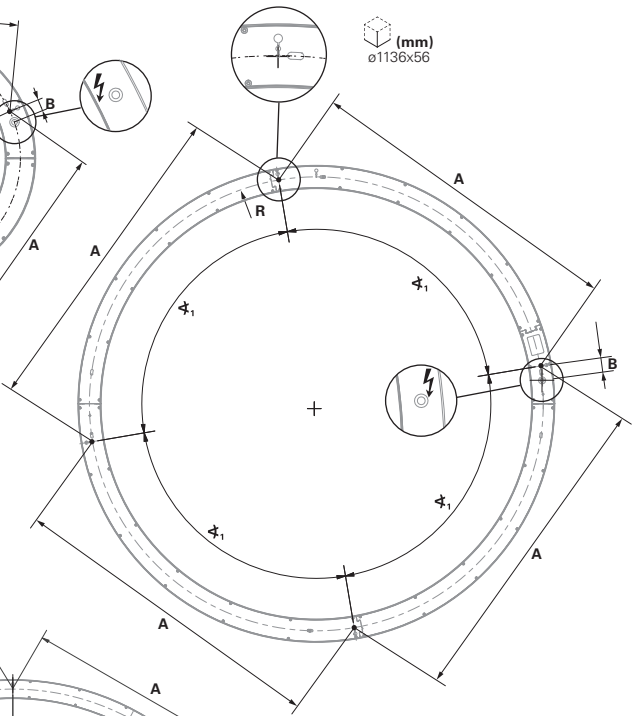

 (mm)
 $\varnothing 1494 \times 56$

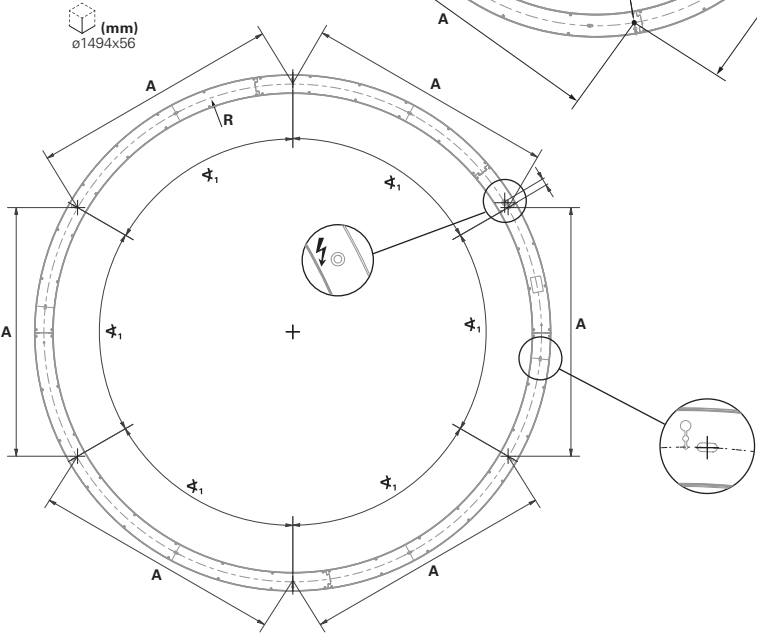

CONCEPT O 35 | CONCEPT O 35 D/I



EN SUSPENDED
FR SUSPENDU
DE PENDEL
PT SUSPENSO
ES Suspendido



TO INSTALL THE SUSPENSION AND THE CEILING SEE:
POUR MONTAGE DE LA SUSPENSION ET PÂTERE DE SUSPENSION LIRE:
ZUM EINBAU DER SEILABHÄNGUNG UND DER DECKENDOSE BITTE
LESEN SIE:
PARA INSTALAR SUSPENSÃO E CAIXA DE ALIMENTAÇÃO LER:
PARA INSTALAR LA SUSPENSIÓN Y LA BASE DE TECHO LEER:



IIV675
IIV683
IIV966
IIV881
IIV882

OR /
OU /
ODER /
OU / O

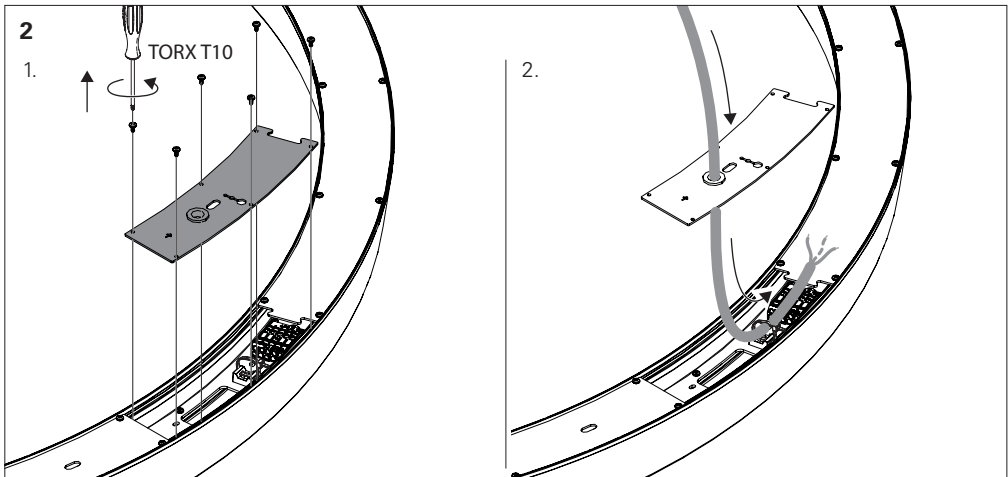

2.1 - HF

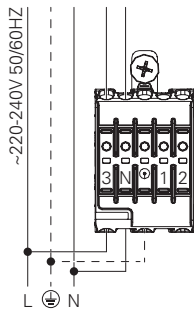

DALI

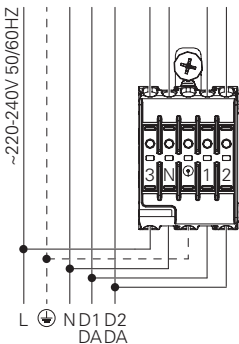

SWD

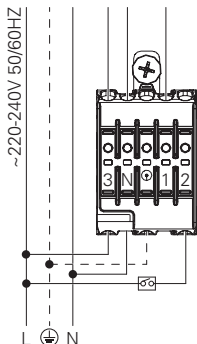

2.2

1.

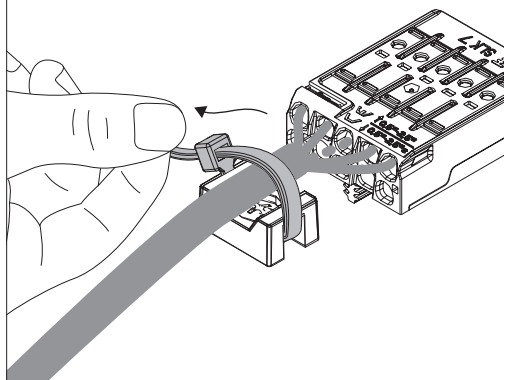

TORX T10 - 0,5Nm

2.

