

ROFY 85 IP /C

EN INSTALLATION INSTRUCTIONS

FR NOTICE DE MONTAGE

DE MONTAGEANLEITUNG

PT INSTRUÇÕES DE MONTAGEM

ES INSTRUCCIONES DE MONTAJE

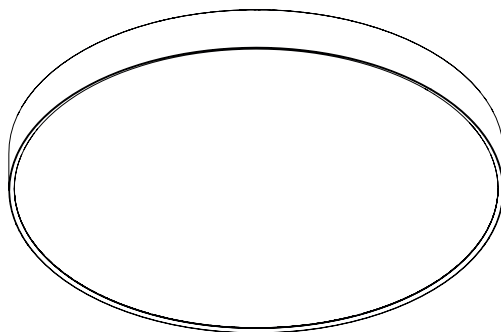

Order code / Code com. / Bestell-Nr. / Código / Código: 90581L...



EN Carefully read the instalation instructions provided before installing the device. Safety and Maintenance: Scan here.

FR Lire attentivement les notices de montage avant l'installation de l'appareil. Sécurité et Entretien: Sancez ici.

DE Bitte lesen die mitgelieferte Montageanleitungen vor de Montage des Geräts. Sicherheit und Wartung: Hier scannen.

PT Leia atentamente as instruções de montagem fornecidas antes de instalar o aparelho. Segurança e Manutenção: Scan aqui.

ES Lea atentamente las instrucciones de montaje proporcionadas antes de instalar el aparato. Seguridad y Mantenimiento: Escanea aqui.



ROFY 85 IP /C

(mm) 2px
Ø300x85
Ø400x85
Ø600x85 ▶ 

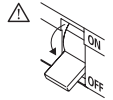

TOOLS | OUTILS | WERKZEUG | FERRAMENTAS | HERRAMIENTAS

Phillips screwdriver
Long nose pliers



EN USE GLOVES.
FR UTILISEZ DES GANTS.
DE HANDSCHUHE BENUTZEN.
PT UTILIZE LUVAS.
ES USE GUANTES.



EN DO NOT PRESS – RISK OF BREAKAGE.
FR NICHT DRÜCKEN – BRUCHGEFAHR.
DE NE PAS APPUYER – RISQUE DE CASSE.
PT NÃO PRESSIONE – RISCO DE QUEBRA.
ES NO PRESIONAR – RIESGO DE ROTURA.

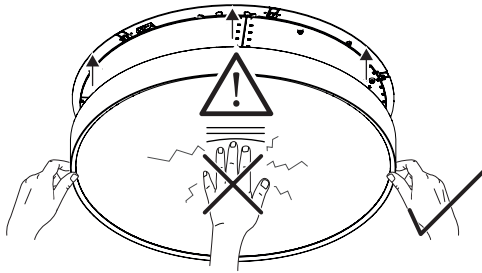

ROFY 85 IP /C

90581L...

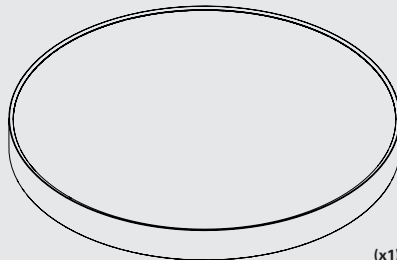



(x2/x3)

(x1)

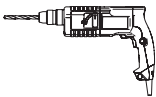
ROFY 85 IP /C

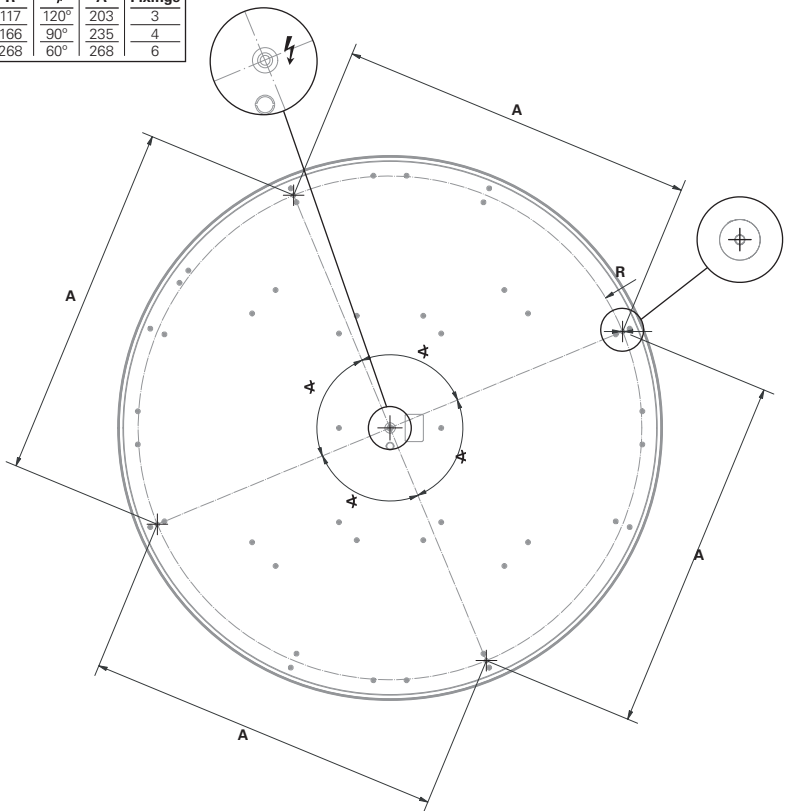

ROFY 85 IP /C				
(mm)	R	φ	A	Fixings
ø300x85	117	120°	203	3
ø400x85	166	90°	235	4
ø600x85	268	60°	268	6



1

1.

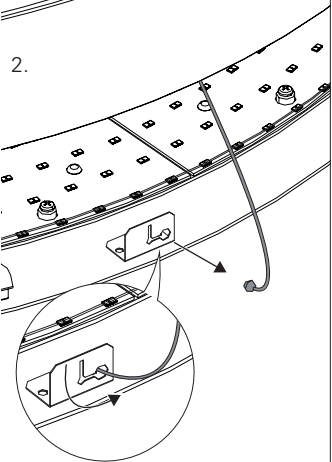
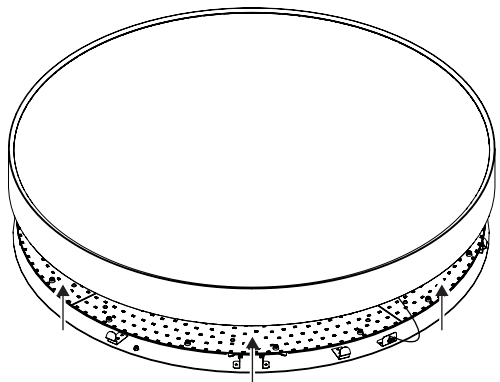

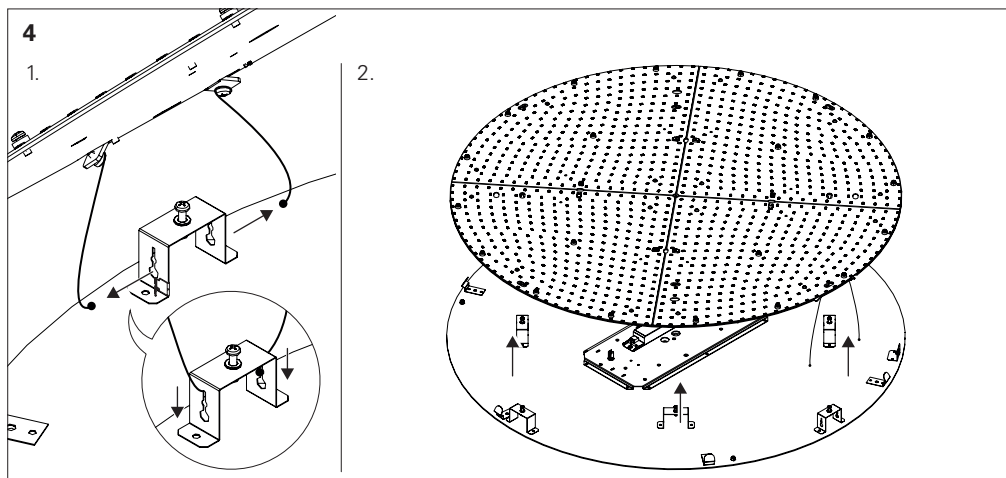
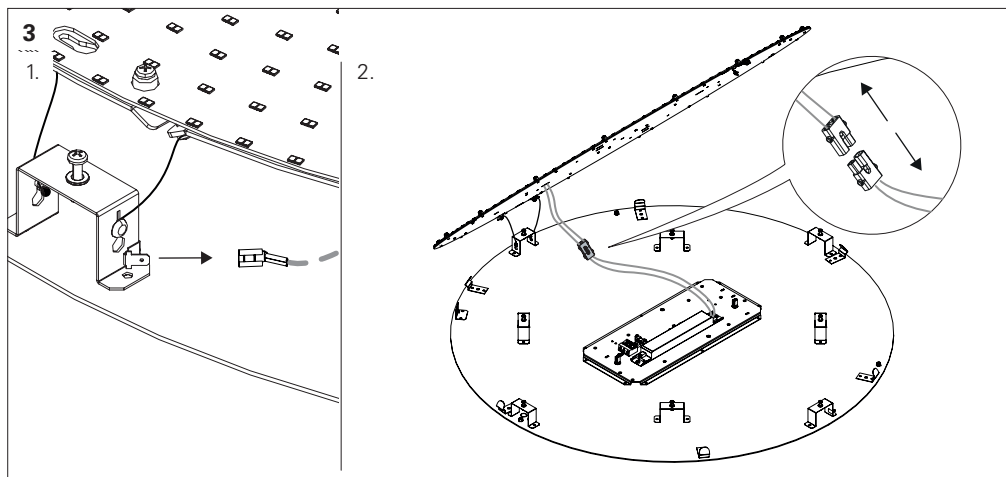
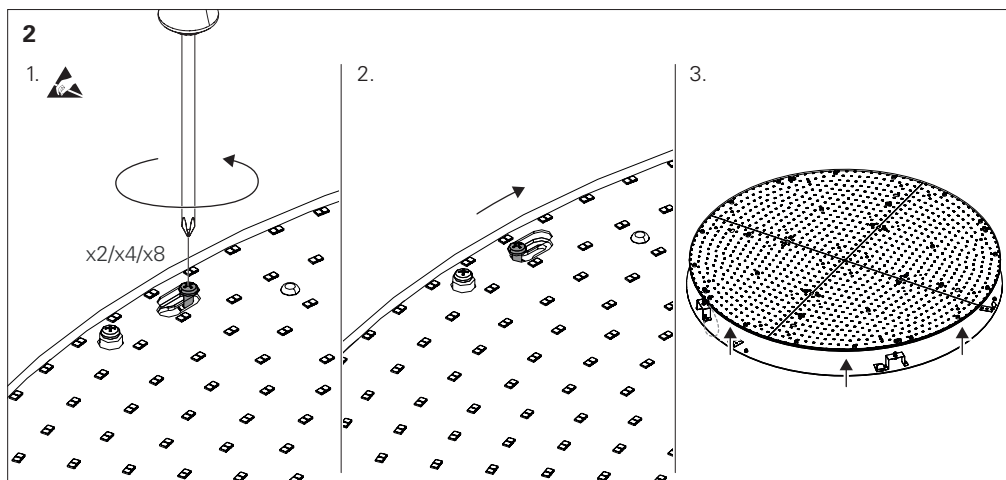

5

1.

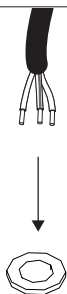

2.

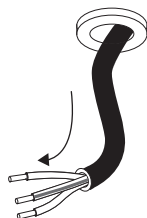

6

2px
Ø600x85

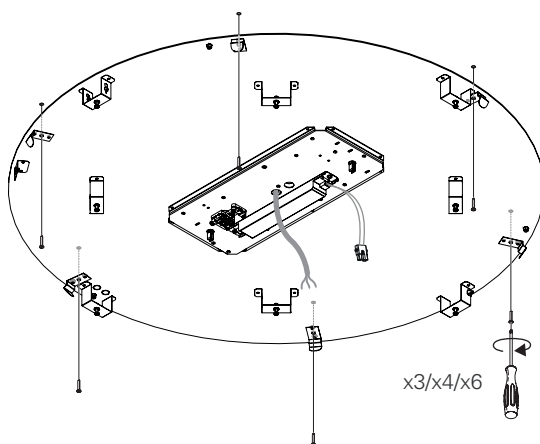

x3/x4/x6

7

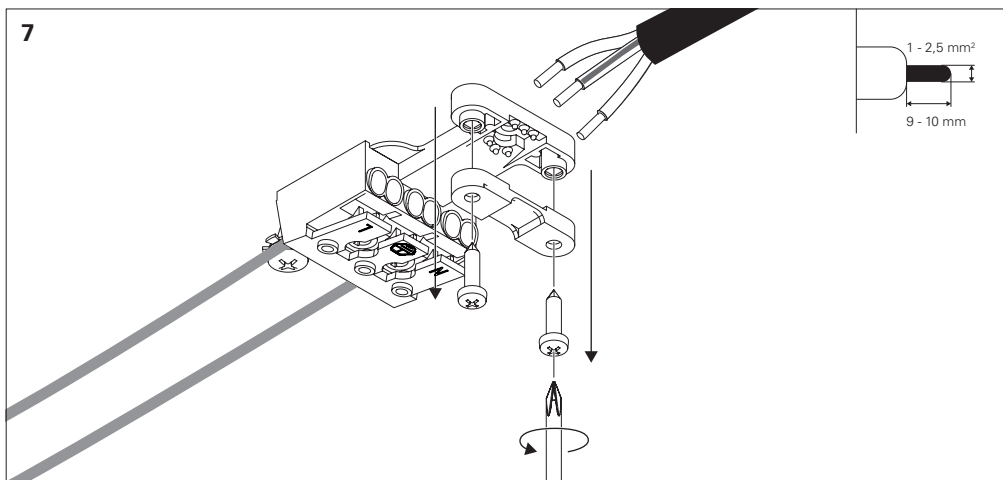

1 - 2,5 mm²
9 - 10 mm

8 - HF

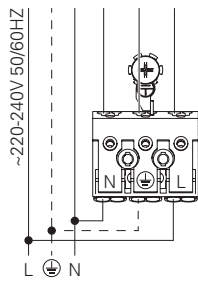

DALI

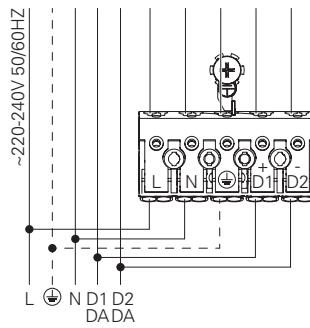

8 - HF + K3 + TEL.

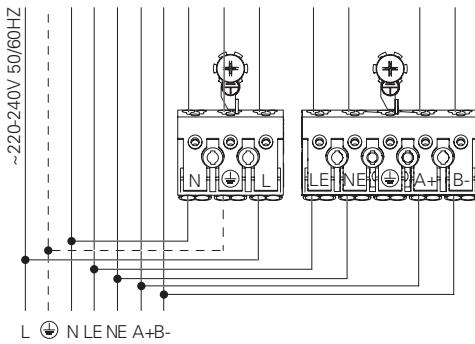

8 - DALI + K3 + TEL.

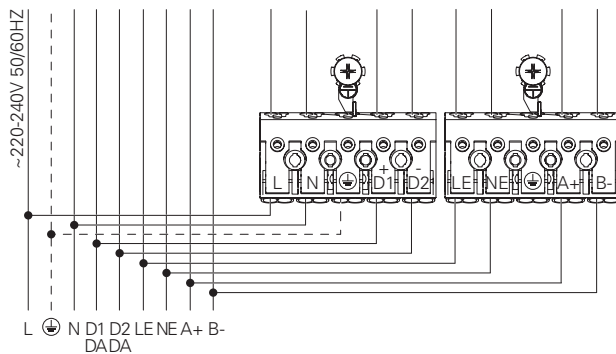

9

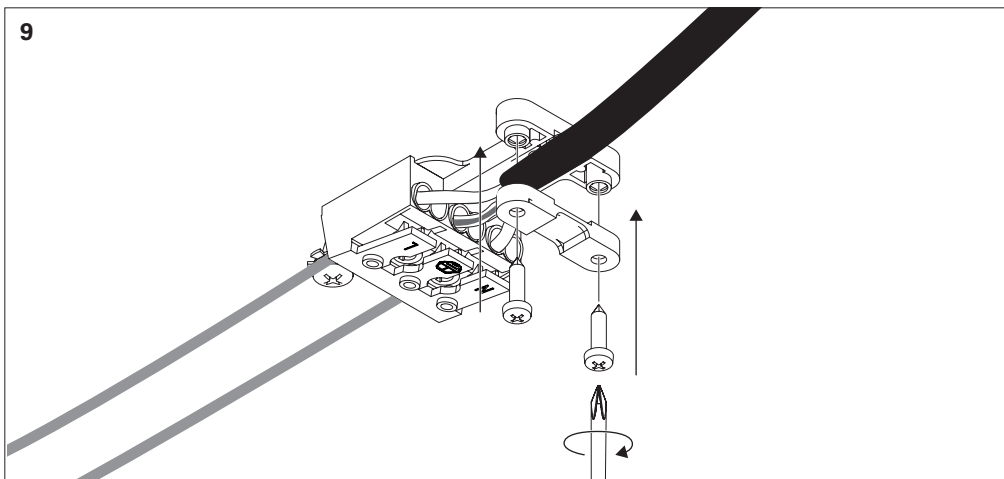

10

1.

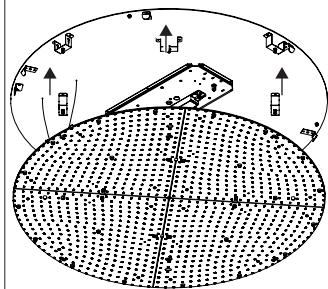

2.

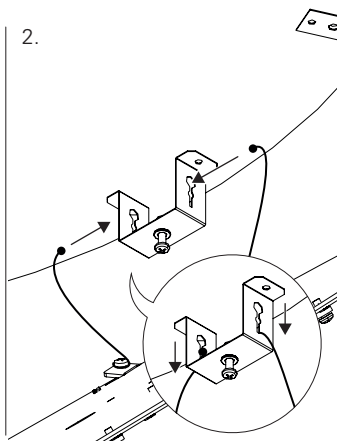

3.

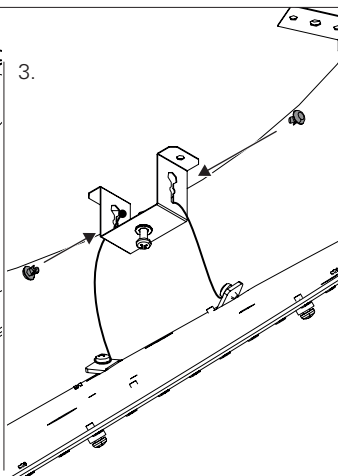

11

1.

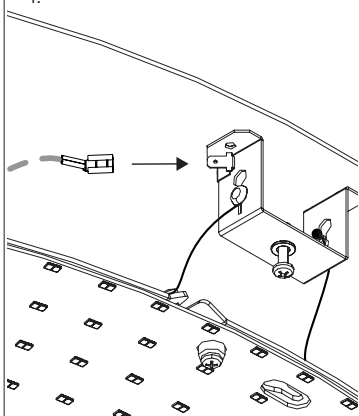

2.

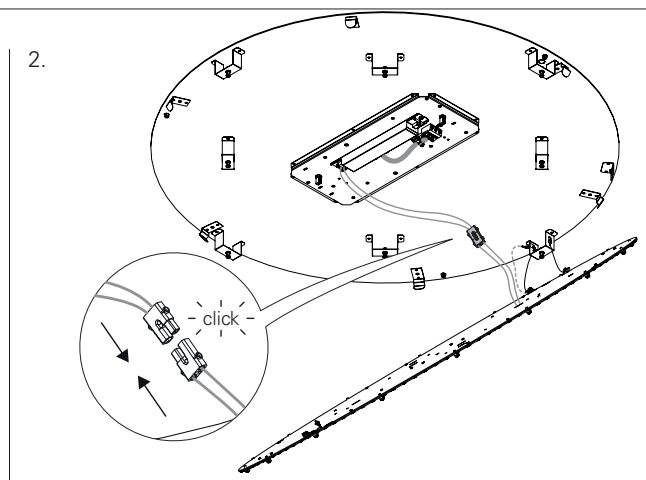

1. 

2.

The diagram shows a curved path with an arrow indicating direction. A vector field of small squares is shown, with an arrow pointing to the right. A particle trajectory is shown as a series of circles moving along the path.

3.

A diagram of a 2D hexagonal lattice. A central unit cell is highlighted with a thick black border. This unit cell contains a small circle with a dot in the center and a small square with a dot in the center. The lattice is composed of many such unit cells. A curved line passes through the lattice, and a small circle with a dot is shown on this line. Below the lattice, a vertical line with a curved arrow indicates a direction of movement or a path.

$x2/x4/x8$

 $x^2/x^4/x^8$

1.

1.

2.



Ø600x85

 $2p_x$ 

- click -