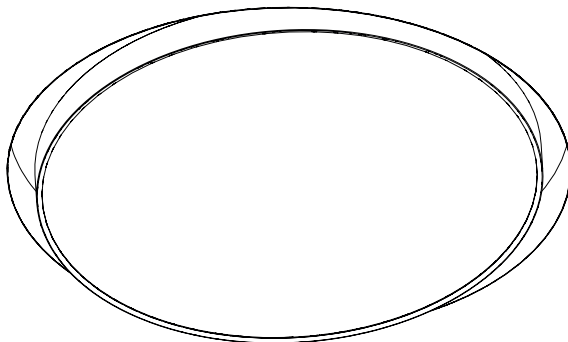
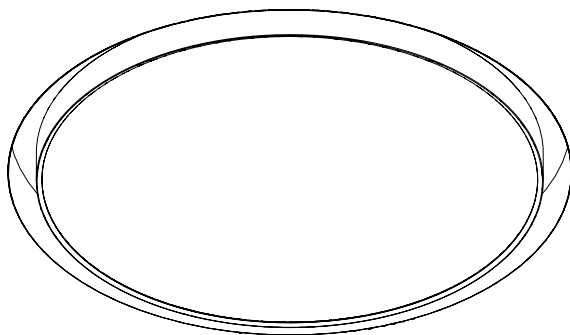
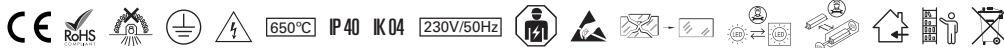

ROFY 60 /T D/I**EN** INSTALLATION INSTRUCTIONS**FR** NOTICE DE MONTAGE**DE** MONTAGEANLEITUNG**PT** INSTRUÇÕES DE MONTAGEM**ES** INSTRUCCIONES DE MONTAJE

Order code / Code com. / Bestell-Nr. / Código / Código: 90591L... | 90593L...

**EN** Carefully read the installation instructions provided before installing the device. Safety and Maintenance: Scan here.**FR** Lire attentivement les notices de montage avant l'installation de l'appareil. Sécurité et Entretien: Saluez ici.**DE** Bitte lesen die mitgelieferte Montageanleitung vor der Montage des Geräts. Sicherheit und Wartung: Hier scannen.**PT** Leia atentamente as instruções de montagem fornecidas antes de instalar o aparelho. Segurança e Manutenção: Scan aqui.**ES** Lea atentamente las instrucciones de montaje proporcionadas antes de instalar el aparato. Seguridad y Mantenimiento: Escanea aquí.

ROFY 60 /T D/I

(mm)
 Ø400x119
 Ø600x119
 Ø900x135
 Ø1150x135

Ø523 - Ø528
 Ø723 - Ø728
 Ø1023 - Ø1208
 Ø1273 - Ø1278

2px

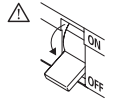
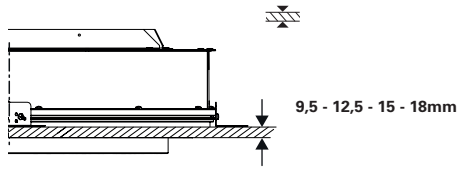

TOOLS | OUTILS | WERKZEUG | FERRAMENTAS | HERRAMIENTAS

Phillips screwdriver

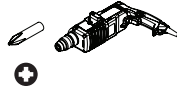

EN USE GLOVES.
FR UTILISEZ DES GANTS.
DE HANDSCHUHE BENUTZEN.
PT UTILIZE LUVAS.
ES USE GUAANTES.



EN DO NOT PRESS – RISK OF BREAKAGE.
FR NICHT DRÜCKEN – BRUCHGEFAHR.
DE NE PAS APPUYER – RISQUE DE CASSE.
PT NÃO PRESSIONE – RISCO DE QUEBRA.
ES NO PRESIONAR – RIESGO DE ROTURA.

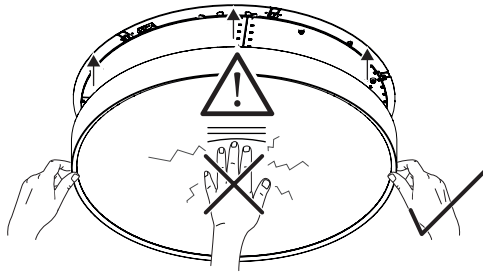

ROFY 60 / T D/I

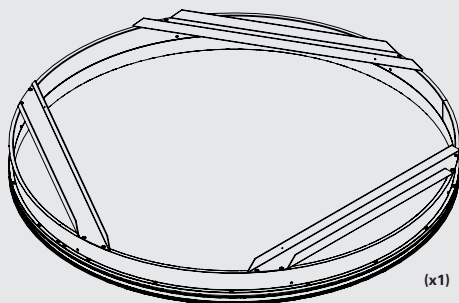
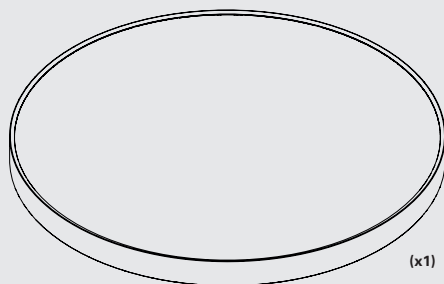

90591L...| 90593L...

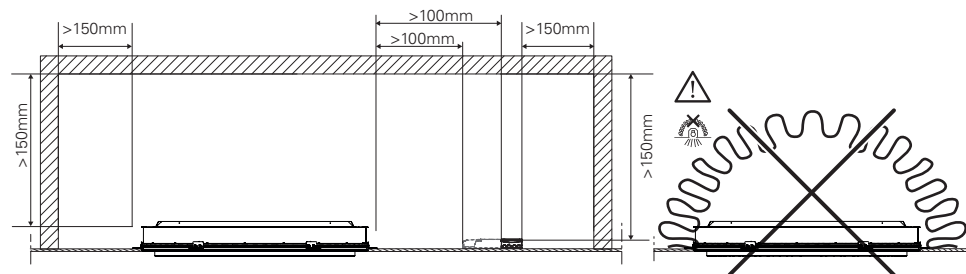
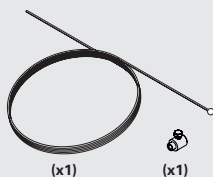

SAFETY CABLE FILIN D'ACIER SICHERHEITSKABEL OPTION CABO DE SEGURANÇA CABLE DE SEGURIDAD

955000



ROFY 60 /T D/I			
 (mm)	 D	Fixings	 (mm)
Ø400x119	[Ø523 - Ø528]	4	9,5-12,5-15-18
Ø600x119	[Ø723 - Ø728]	4	
Ø900x135	[Ø1023 - Ø1208]	6	
Ø1150x135	[Ø1273 - Ø1278]	6	

Bracket	
Mounting	Thickness T (mm)
1	9,5
2	12,5
3	15
4	18

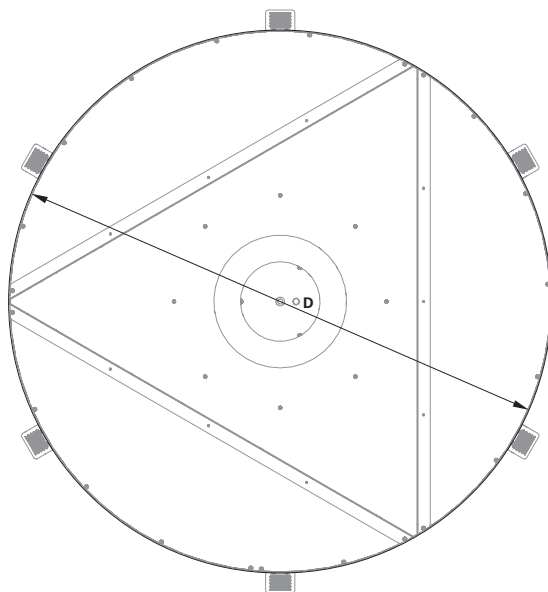
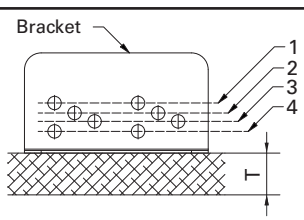

1

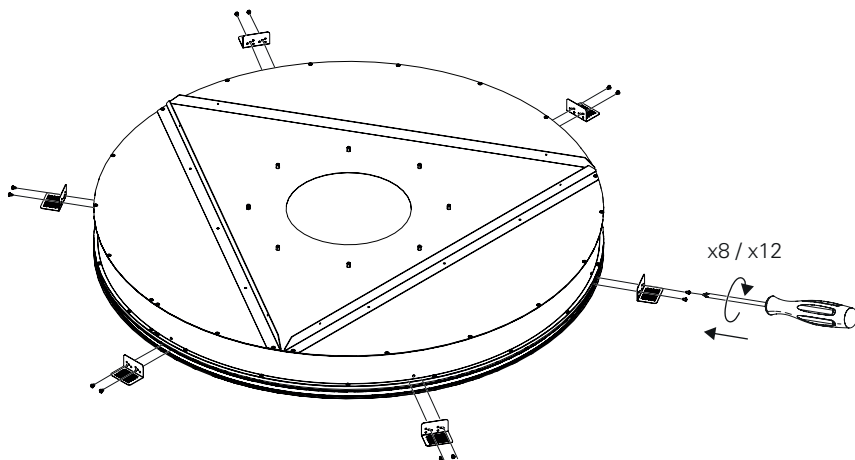

2 - SAFETY CABLE OPTION
 OPTION FILIN D'ACIER
 OPTIONEN STAHL SICHERHEITSKABEL
 OPÇÃO CABO DE SEGURANÇA
 OPCIÓN CABLE DE SEGURIDAD

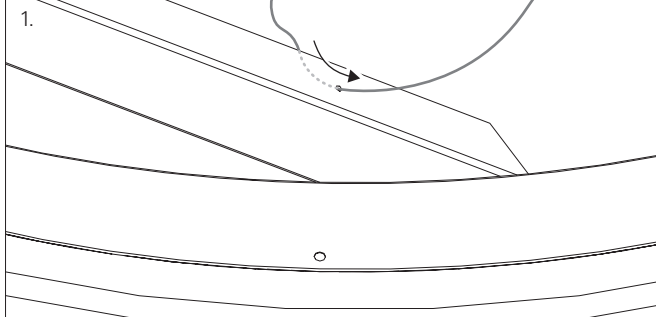

2



3

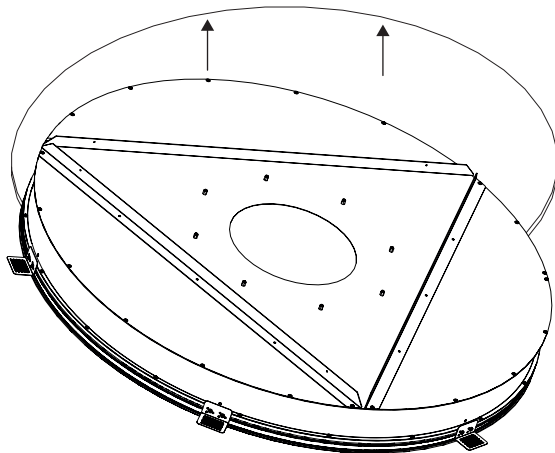

4

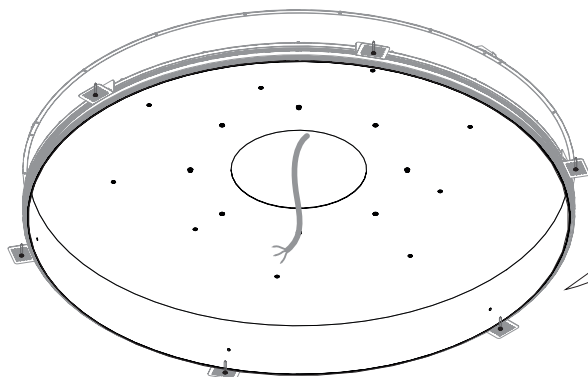

x4 / x6

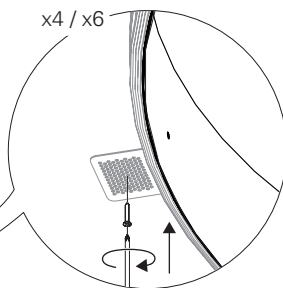

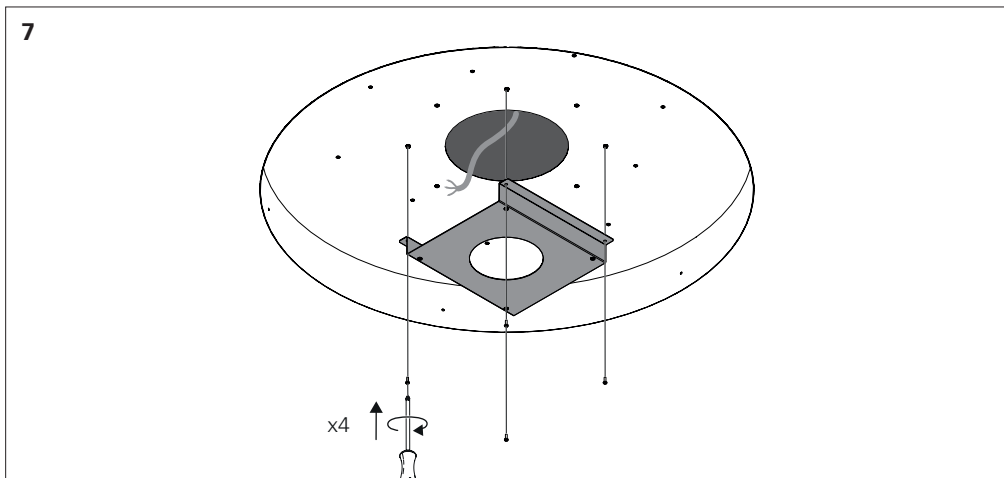
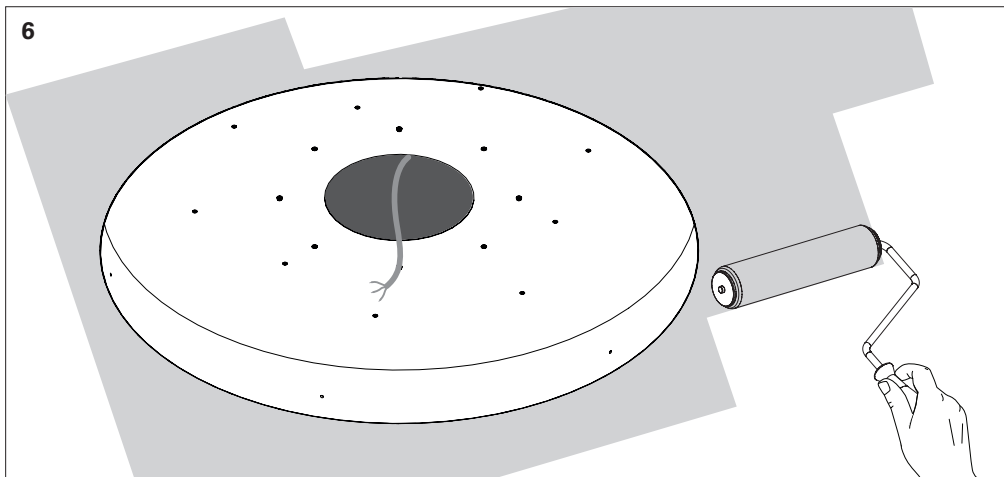
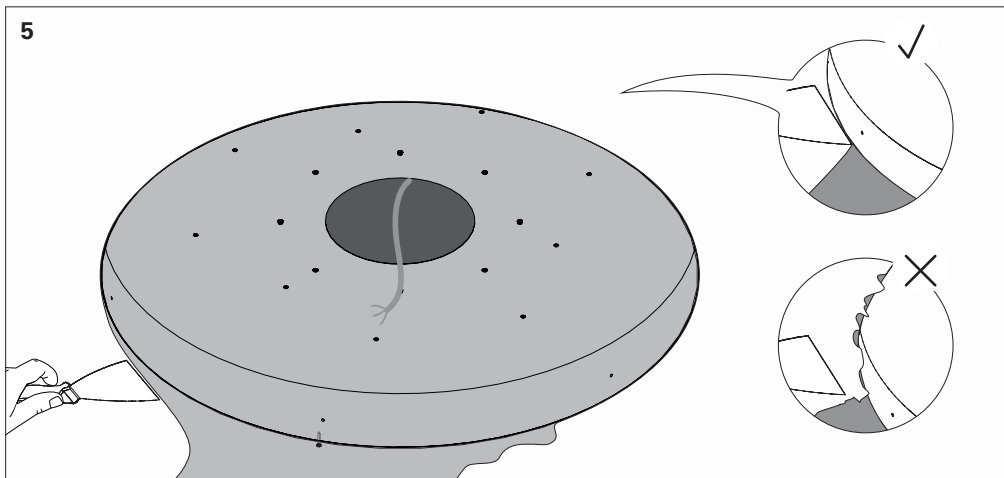

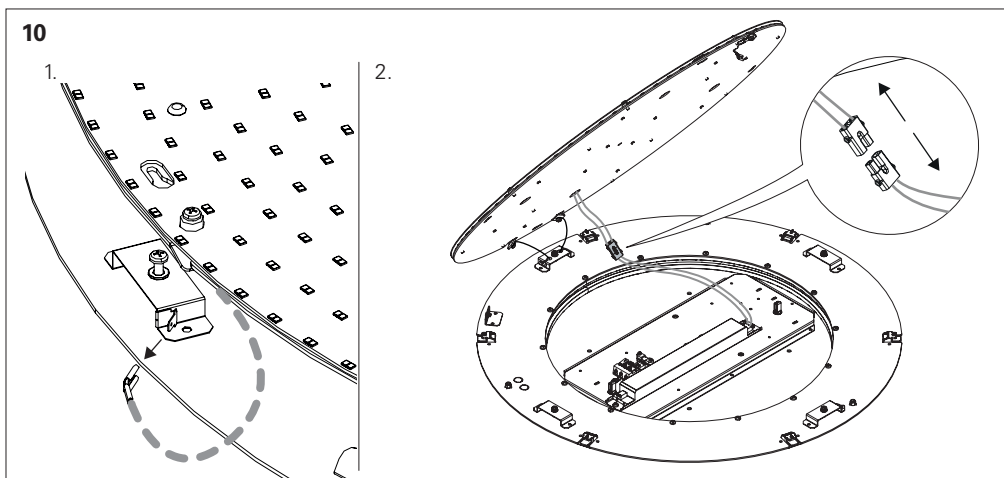
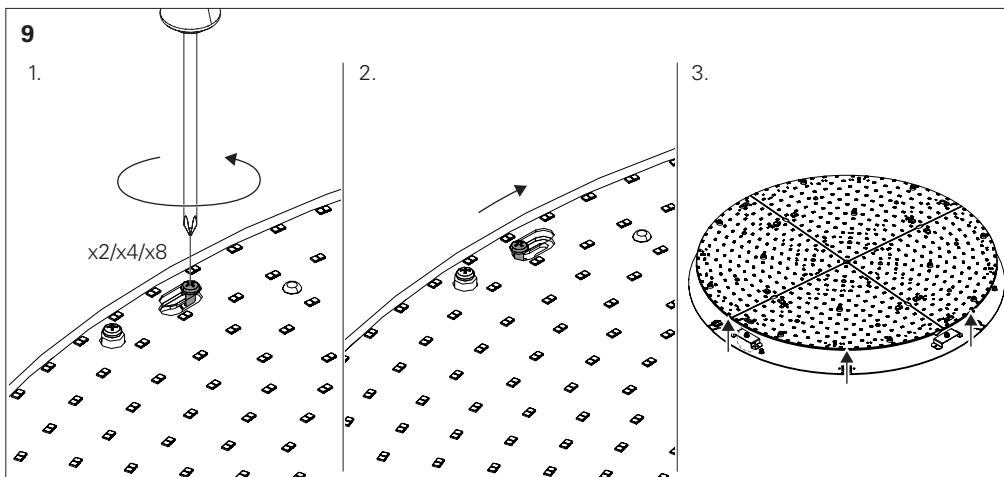
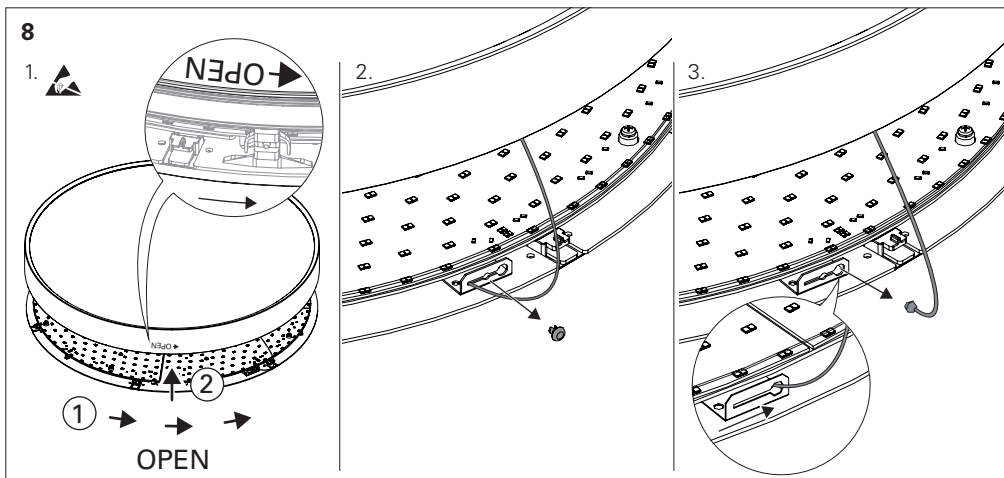

11

1.

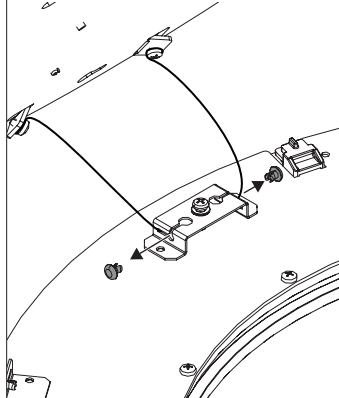

2.

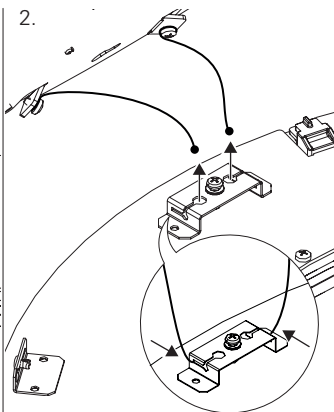

3.

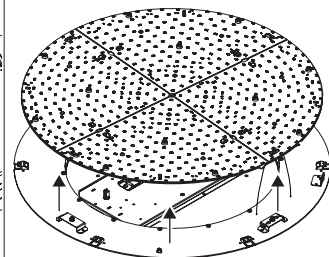

12

1.

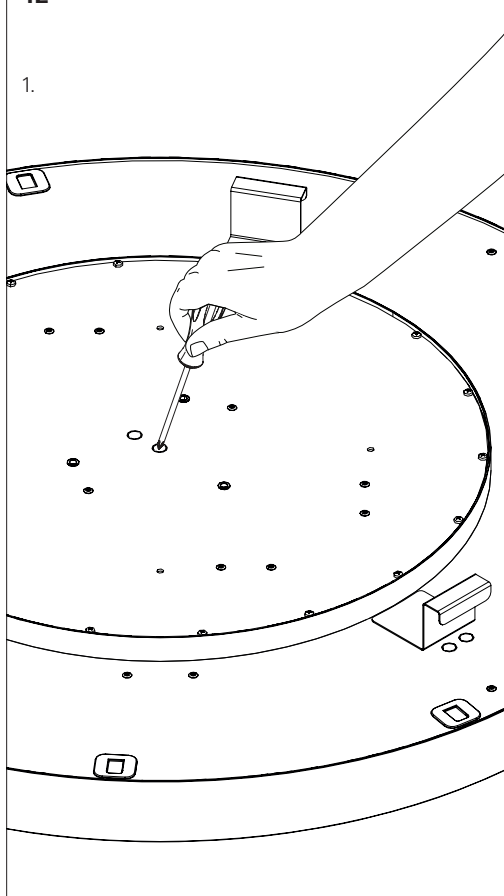

2.

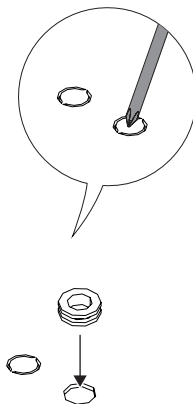

3.

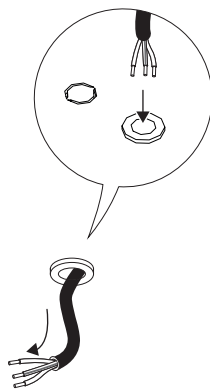

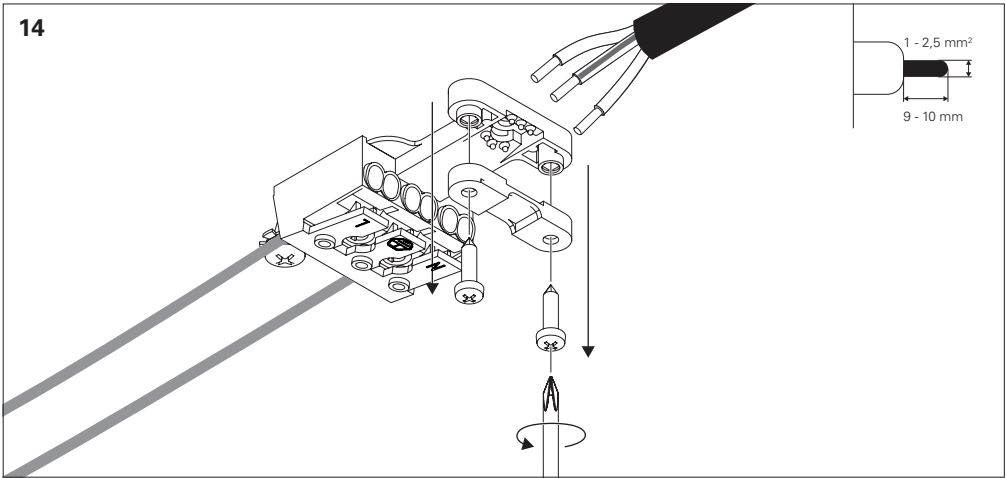
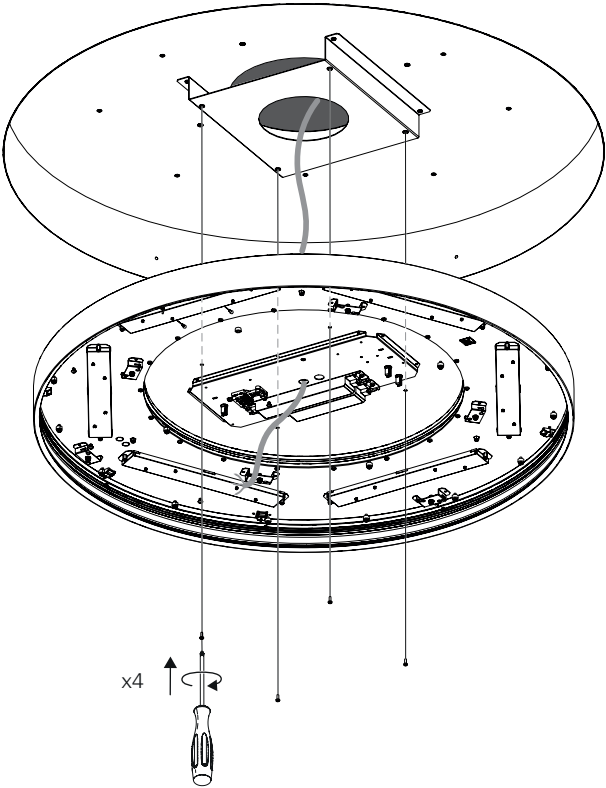

15 - HF + CD + K3 + TEL.

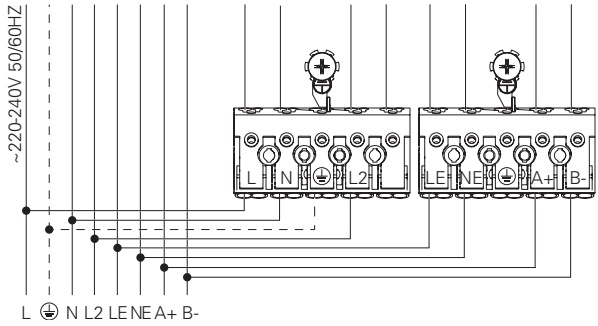

15 - HF + K3 + TEL.

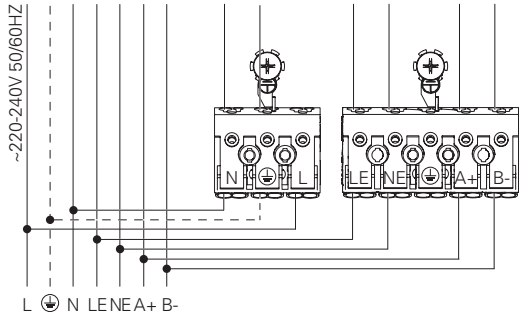

15 - DALI

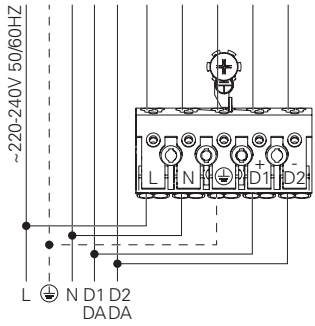

DALI + K3 + TEL.

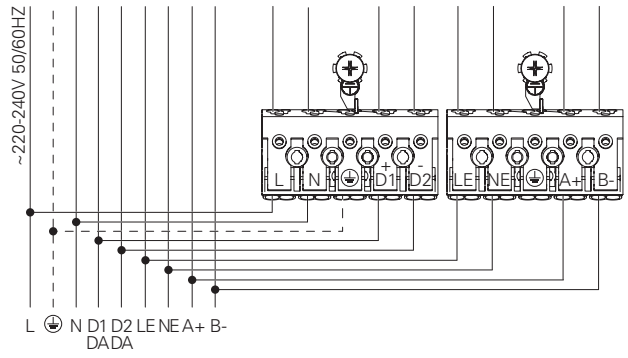

15 - SWD

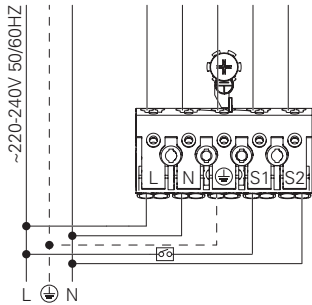

SWD + CD

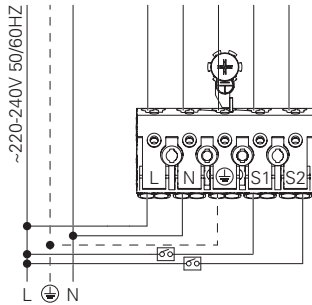

15 - SWD + CD + K3 + TEL

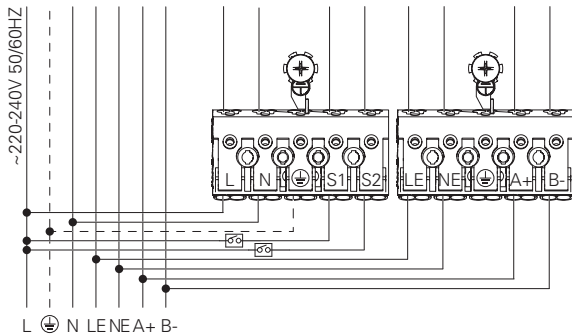

15 - HF

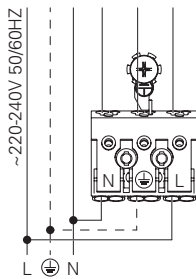

HF + CD

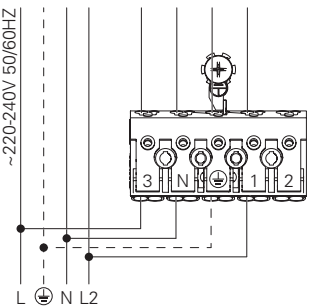

16

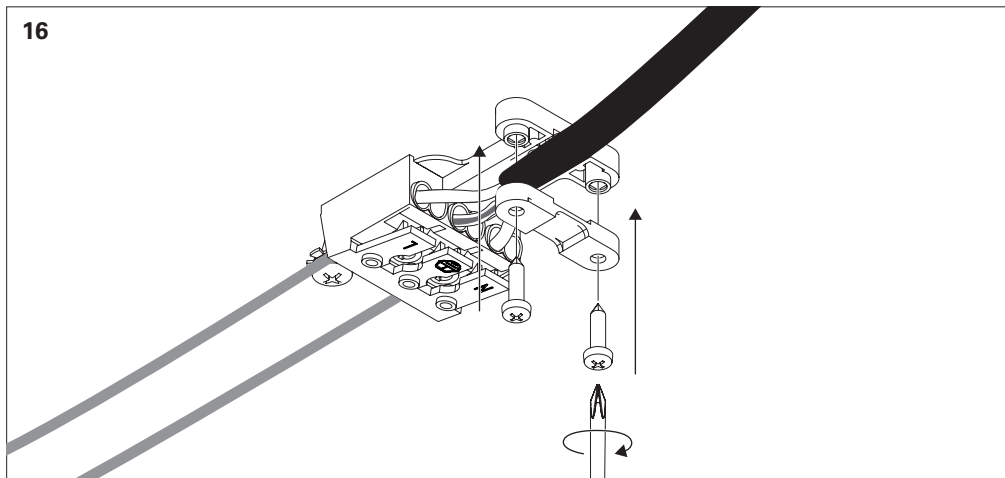

17

1.

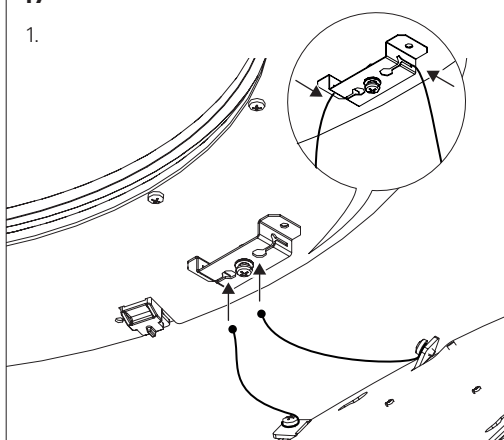

2.

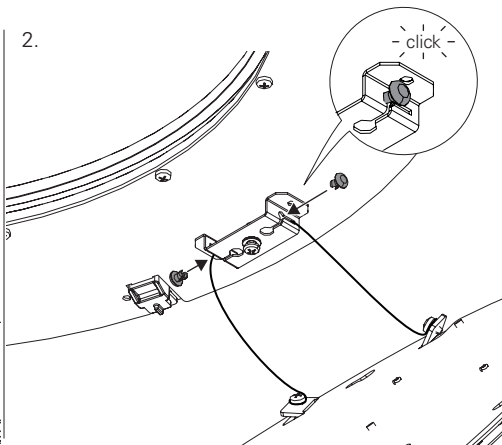

18

1.

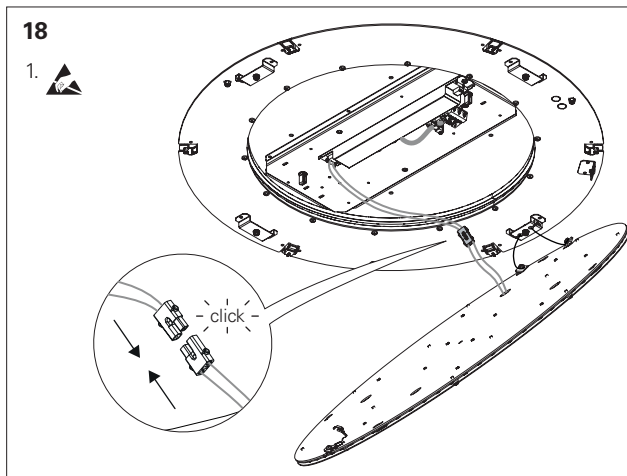

2.

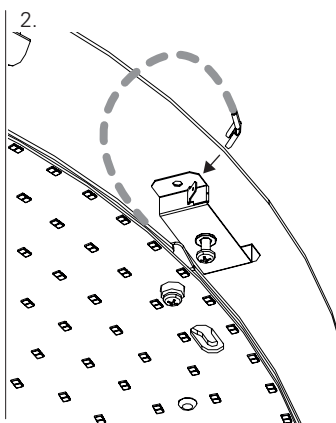

19

1. 

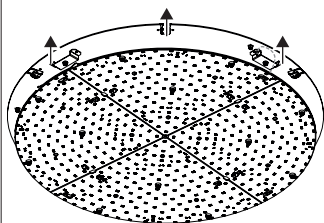

2.

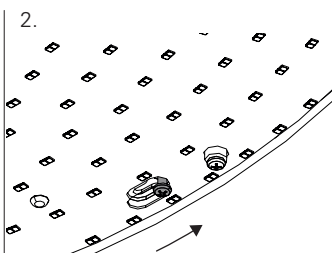

3.

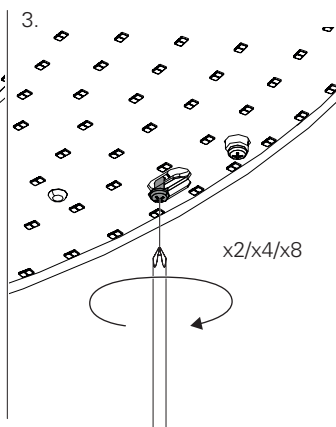

20

1.

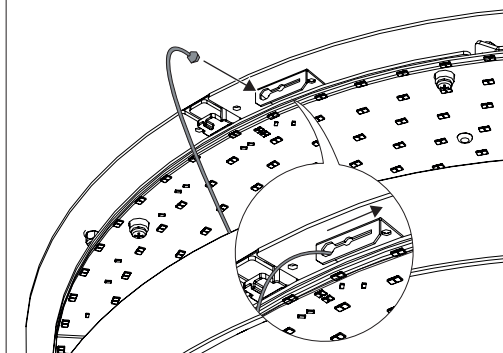

2.

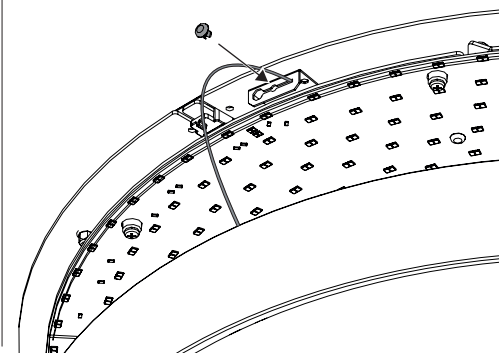

21

1.

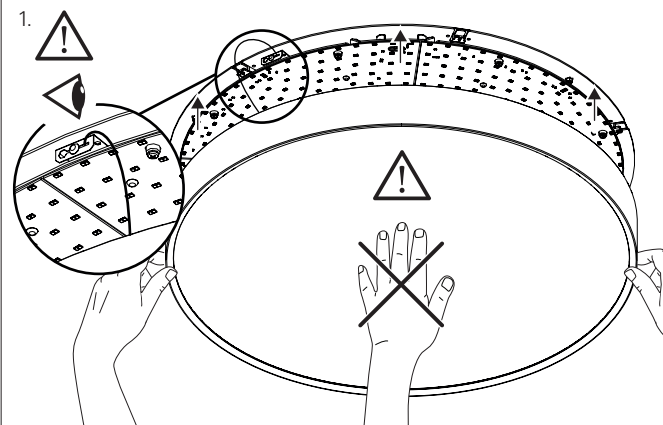

2.

