

CORA /C**EN** INSTALLATION INSTRUCTIONS**FR** NOTICE DE MONTAGE**DE** MONTAGEANLEITUNG**PT** INSTRUÇÕES DE MONTAGEM**ES** INSTRUCCIONES DE MONTAJE

Order code / Code com. / Bestell-Nr. / Código / Código: 90728L... | 90728Q... | 90725L... | 90725Q...

**EN** Carefully read the installation instructions provided before installing the device. Safety and Maintenance: Scan here.**FR** Lire attentivement les notices de montage avant l'installation de l'appareil. Sécurité et Entretien: Sancez ici.**DE** Bitte lesen die mitgelieferte Montageanleitung vor de Montage des Geräts. Sicherheit und Wartung: Hier scannen.**PT** Leia atentamente as instruções de montagem fornecidas antes de instalar o aparelho. Segurança e Manutenção: Scan aqui.**ES** Lea atentamente las instrucciones de montaje proporcionadas antes de instalar el aparato. Seguridad y Mantenimiento: Escanea aqui.

CORA /C

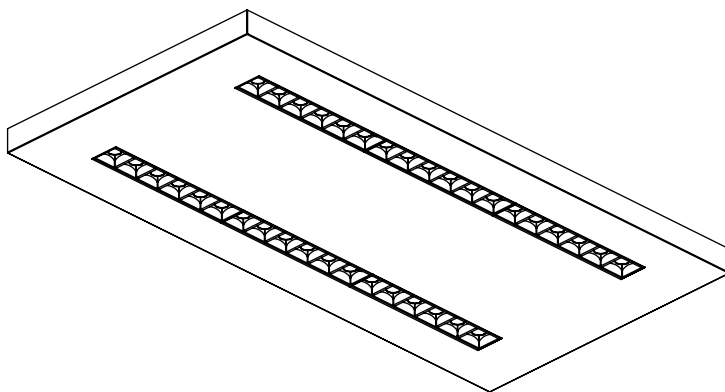
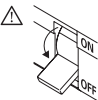

TOOLS | OUTILS | WERKZEUG | FERRAMENTAS | HERRAMIENTAS

Phillips screwdriver



EN USE GLOVES.
FR UTILISEZ DES GANTS.
DE HANDSCHUHE BENUTZEN.
PT UTILIZE LUVAS.
ES USE GUANTES.



CORA /C

90728L... | 90728Q... | 90725L... | 90725Q...

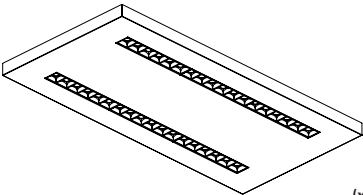
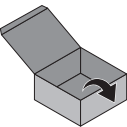

(x1)

SURFACE MOUNTED
SAILLIE
OBERFLÄCHENMONTAGE
SALIENTE
SUPERFICIE

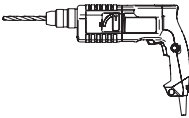

FOR PROPER ASSEMBLY, EVALUATE THE COMPATIBILITY OF THE PLUGS AND FIXING SCREWS WITH THE MOUNTING SURFACE.

POUR UN MONTAGE CORRECT, ÉVALUER LA COMPATIBILITÉ DES CHEVILLES ET VIS DE FIXATION À LA SURFACE DE MONTAGE.

FÜR EINE KORREKTE MONTAGE PRÜFEN SIE BITTE DIE KOMPATIBILITÄT DER BEFESTIGUNGSBUCHSE UND DER SCHRAUBEN MIT DER BEFESTIGUNGSOBERFLÄCHE.

PARA UMA CORRECTA MONTAGEM, AVALIAR A COMPATIBILIDADE DA BUCHA E PARAFUSOS DE FIXAÇÃO COM A SUPERFÍCIE DE MONTAGEM.

PARA EL MONTAJE CORRECTO, EVALUAR LA COMPATIBILIDAD DE LOS TACOS Y TORNILLOS DE FIJACIÓN CON LA SUPERFICIE DE MONTAJE.

CORA /C			
	A	B	Fixings
597x297x30	475	68	4
897x297x30	775		4
1197x297x30	1075		4
1497x297x30	1375		4
597x597x30	475	368	4

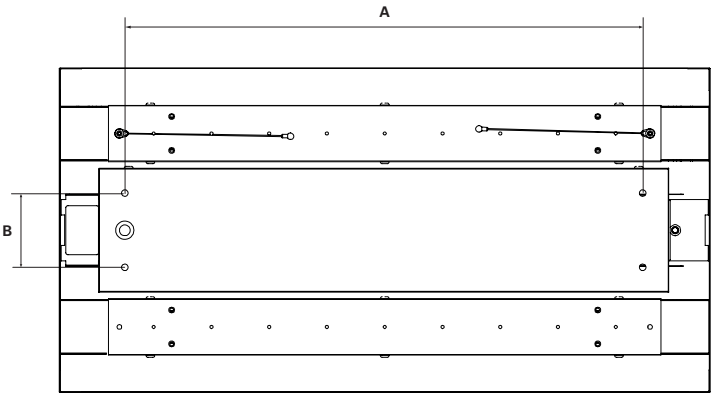

1

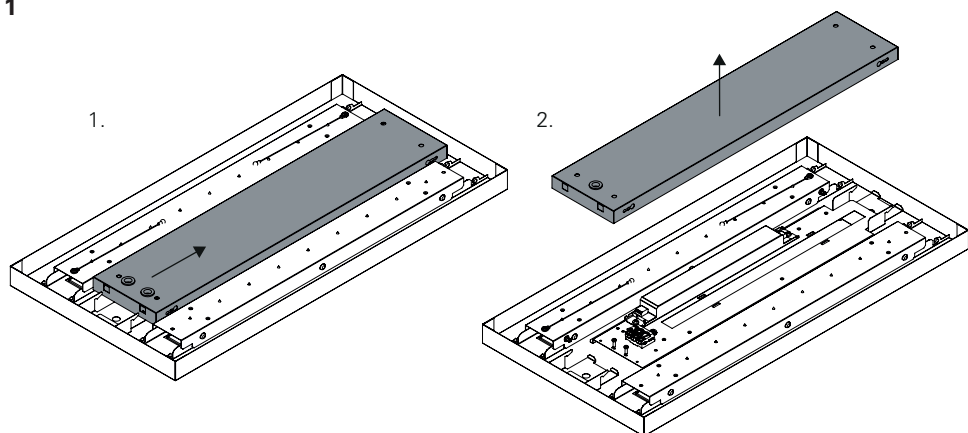

2

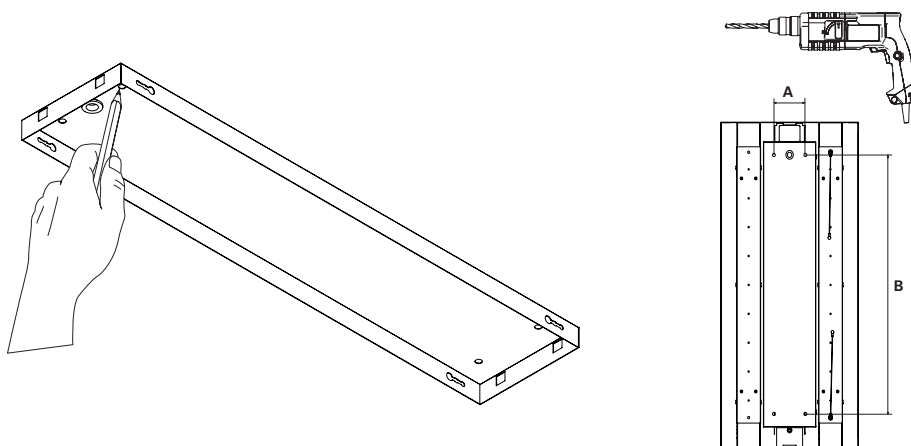

3

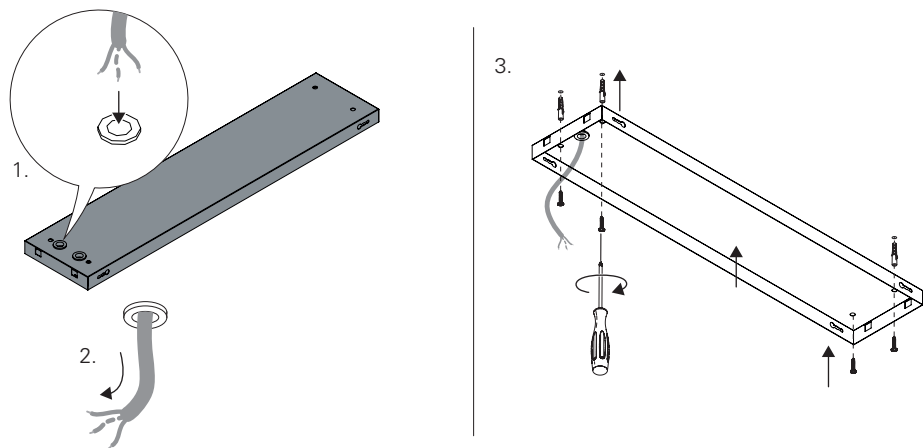

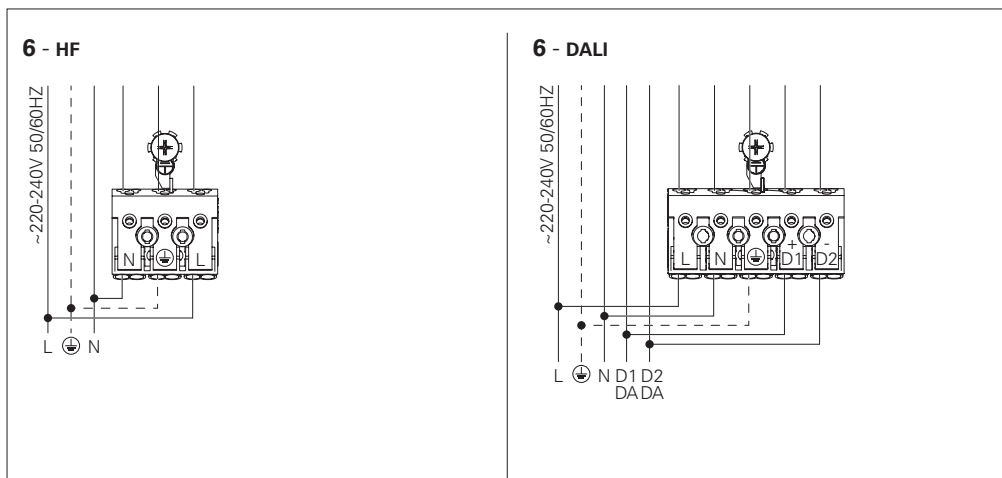
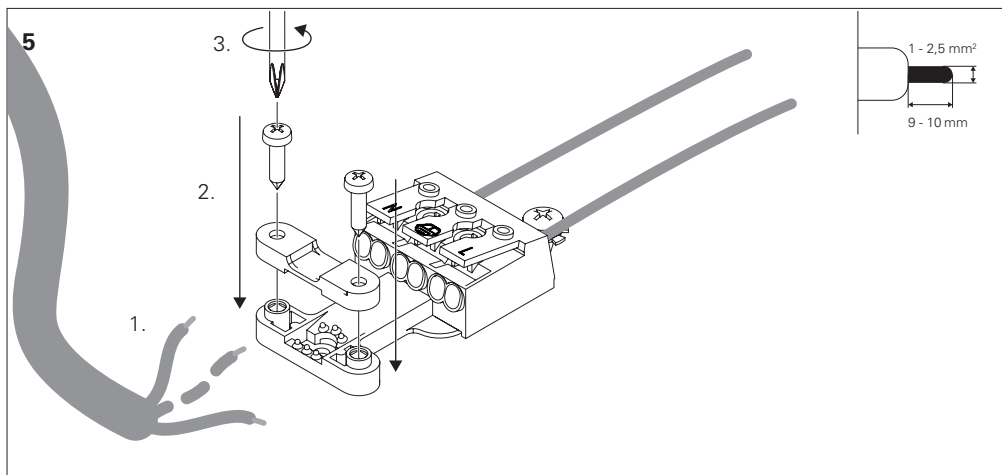
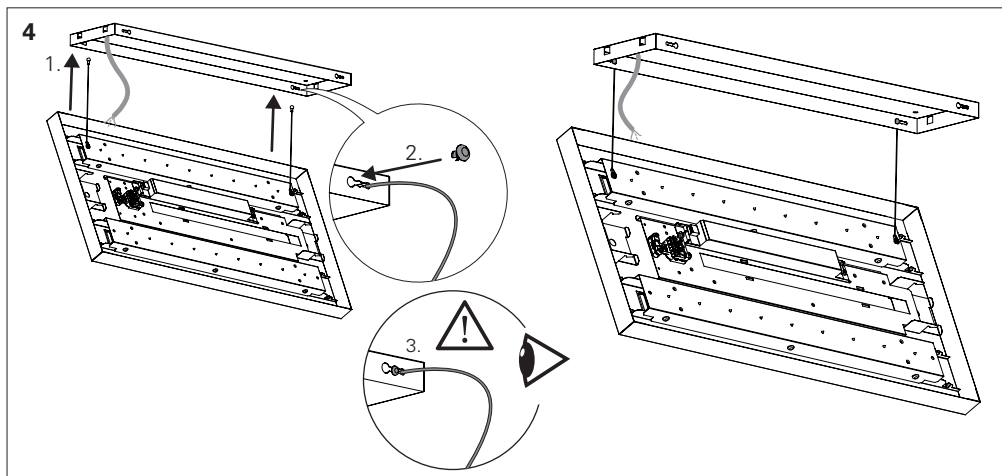

6 - HF + K3 + TEL.

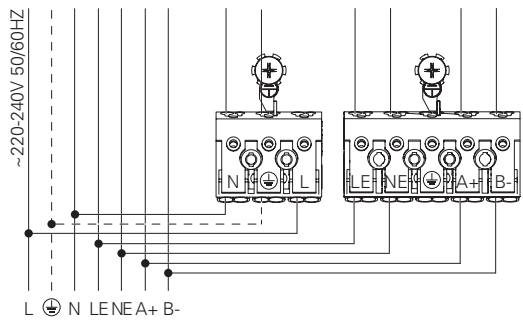

6 - SWD

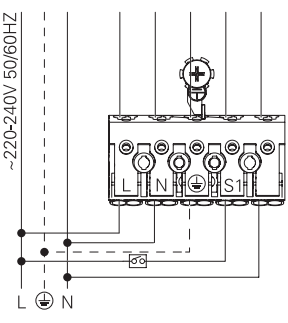

6 - DALI + K3 + TEL.

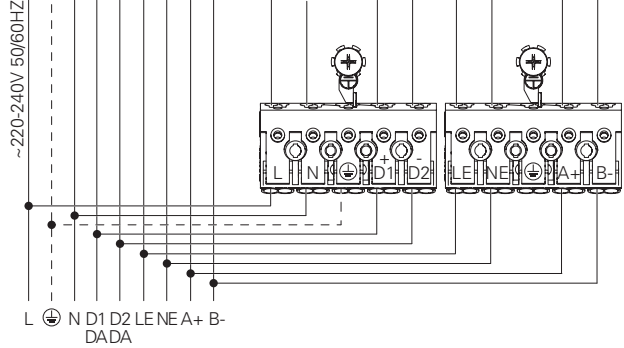

6 - SWD + K3 + TEL.

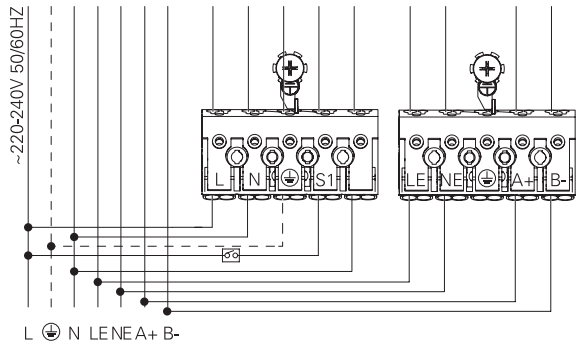

7

