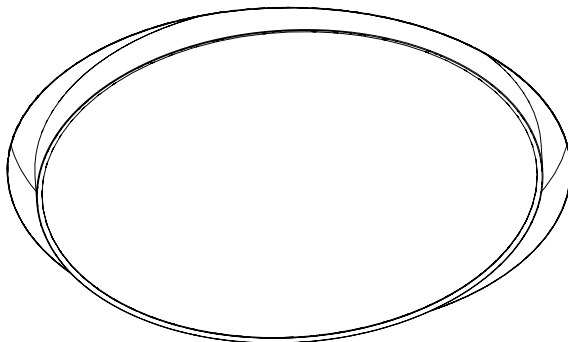
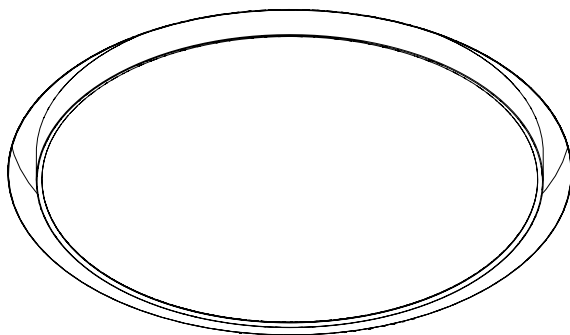
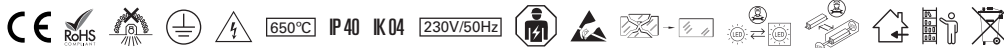

**ROFY 60 /T D/I****EN** INSTALLATION INSTRUCTIONS**FR** NOTICE DE MONTAGE**DE** MONTAGEANLEITUNG**PT** INSTRUÇÕES DE MONTAGEM**ES** INSTRUCCIONES DE MONTAJE

Order code / Code com. / Bestell-Nr. / Código / Código: 90591L... | 90593L...

**EN** Carefully read the installation instructions provided before installing the device. Safety and Maintenance: Scan here.**FR** Lire attentivement les notices de montage avant l'installation de l'appareil. Sécurité et Entretien: Saluez ici.**DE** Bitte lesen die mitgelieferte Montageanleitungen vor de Montage des Geräts. Sicherheit und Wartung: Hier scannen.**PT** Leia atentamente as instruções de montagem fornecidas antes de instalar o aparelho. Segurança e Manutenção: Scan aqui.**ES** Lea atentamente las instrucciones de montaje proporcionadas antes de instalar el aparato. Seguridad y Mantenimiento: Escanea aqui.

# ROFY 60 /T D/I

(mm)  
Ø400x119  
Ø600x119  
Ø900x135  
Ø1150x135

Ø523 - Ø528  
Ø723 - Ø728  
Ø1023 - Ø1208  
Ø1273 - Ø1278

2px

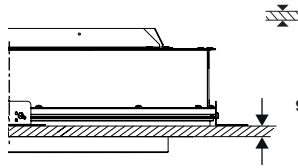

9,5 - 12,5 - 15 - 18mm

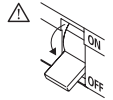

## TOOLS | OUTILS | WERKZEUG | FERRAMENTAS | HERRAMIENTAS

Phillips screwdriver

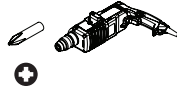

**EN** USE GLOVES.  
**FR** UTILISEZ DES GANTS.  
**DE** HANDSCHUHE BENUTZEN.  
**PT** UTILIZE LUVAS.  
**ES** USE GUANTES.



**EN** DO NOT PRESS – RISK OF BREAKAGE.  
**FR** NICHT DRÜCKEN – BRUCHGEFAHR.  
**DE** NE PAS APPUYER – RISQUE DE CASSE.  
**PT** NÃO PRESSIONE – RISCO DE QUEBRA.  
**ES** NO PRESIONAR – RIESGO DE ROTURA.

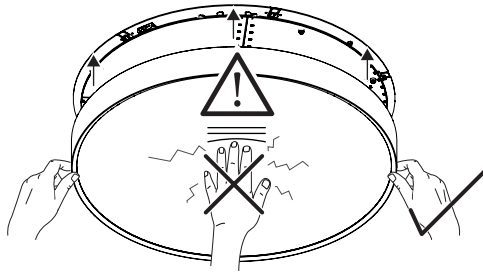

# ROFY 60 / T D/I

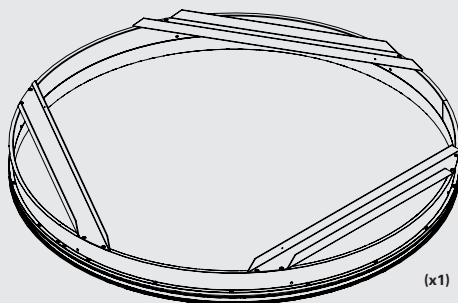
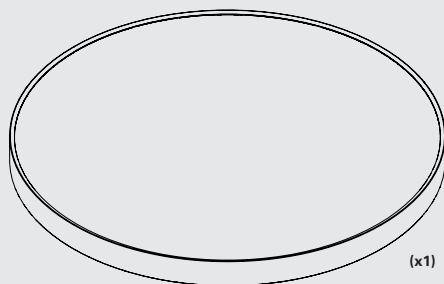

90591L...| 90593L...

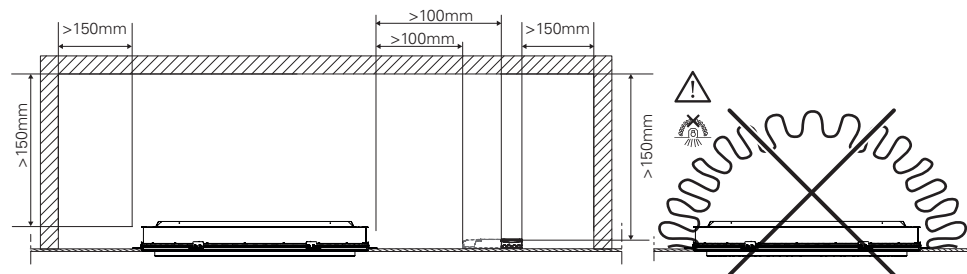
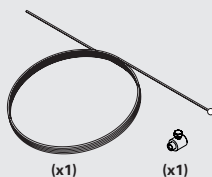

## SAFETY CABLE FILIN D'ACIER SICHERHEITSKABEL OPTION CABO DE SEGURANÇA CABLE DE SEGURIDAD

955000



| ROFY 60 /T D/I  |   |         |  |
|---|---|---------|--|
|  (mm) |  D | Fixings |  (mm) |
| Ø400x119  | [Ø523 - Ø528]   | 4       | 9,5-12,5-15-18   |
| Ø600x119  | [Ø723 - Ø728]   | 4       |  |
| Ø900x135  | [Ø1023 - Ø1208]   | 6       |  |
| Ø1150x135   | [Ø1273 - Ø1278]   | 6       |  |

| Bracket  |                  |
|----------|------------------|
| Mounting | Thickness T (mm) |
| 1        | 9,5              |
| 2        | 12,5             |
| 3        | 15               |
| 4        | 18               |

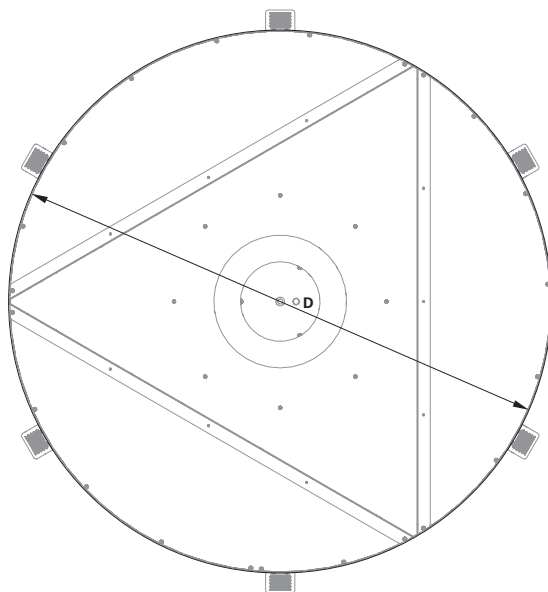
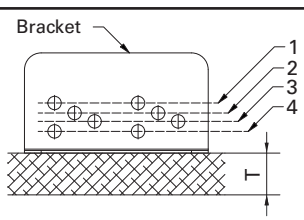

1

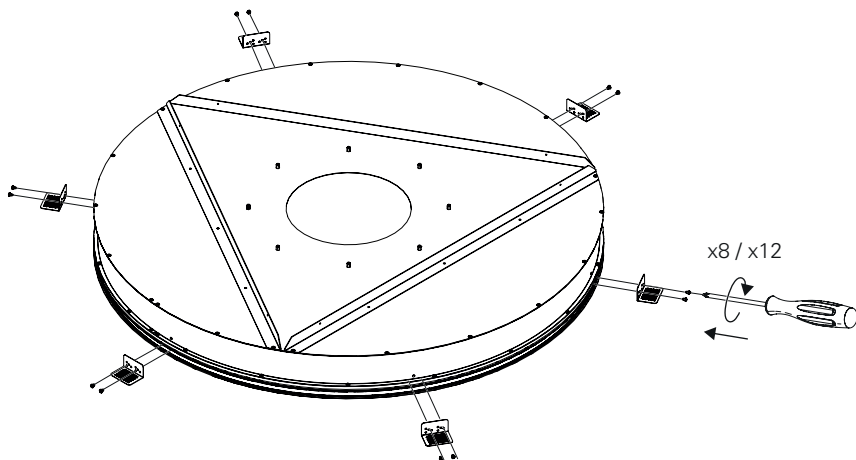

**2** - SAFETY CABLE OPTION  
 OPTION FILIN D'ACIER  
 OPTIONEN STAHL SICHERHEITSKABEL  
 OPÇÃO CABO DE SEGURANÇA  
 OPCION CABLE DE SEGURIDAD

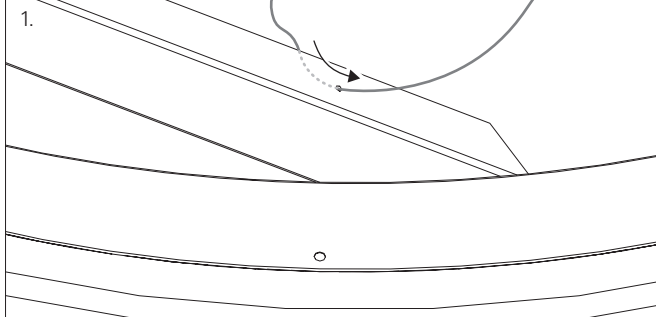

2



**3**

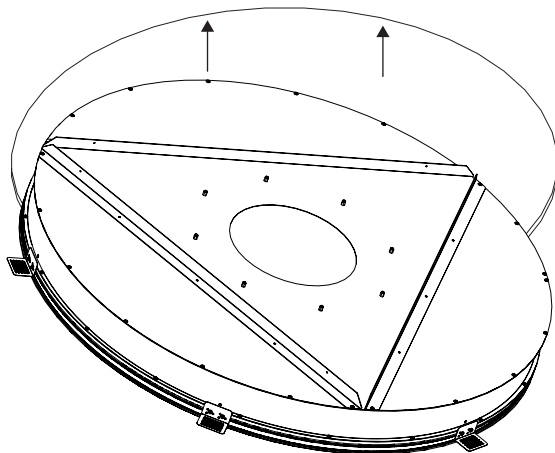

**4**

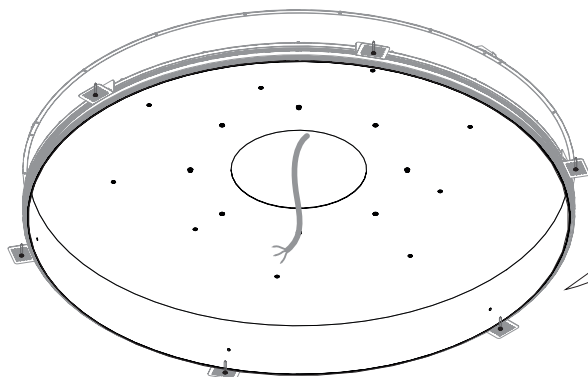

x4 / x6

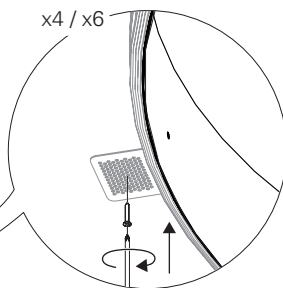

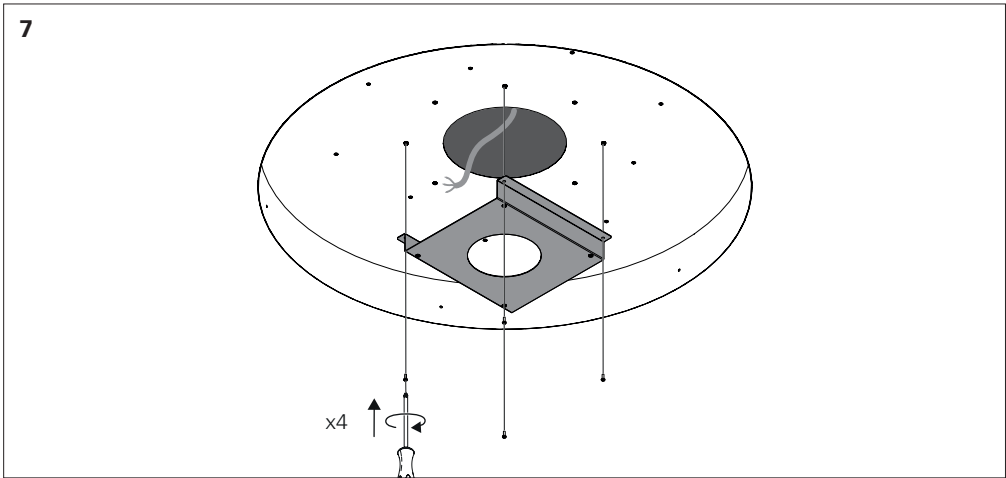
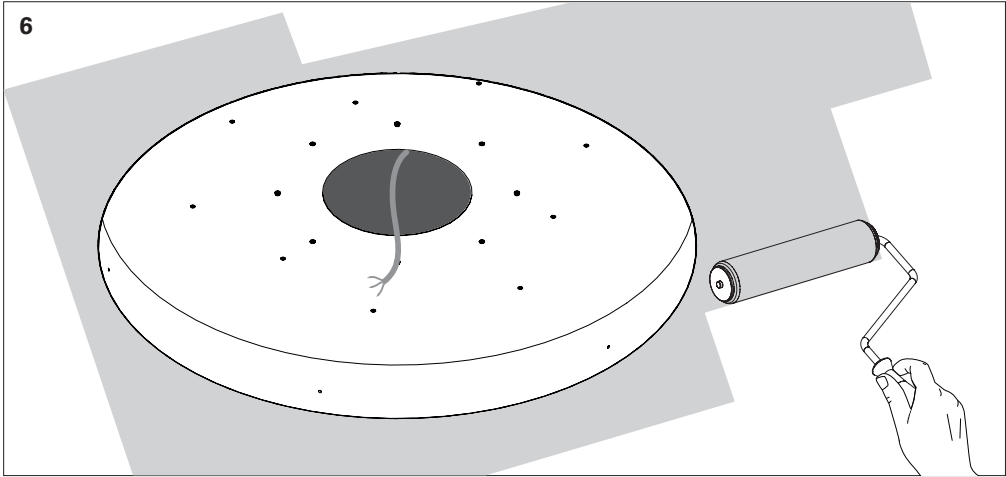
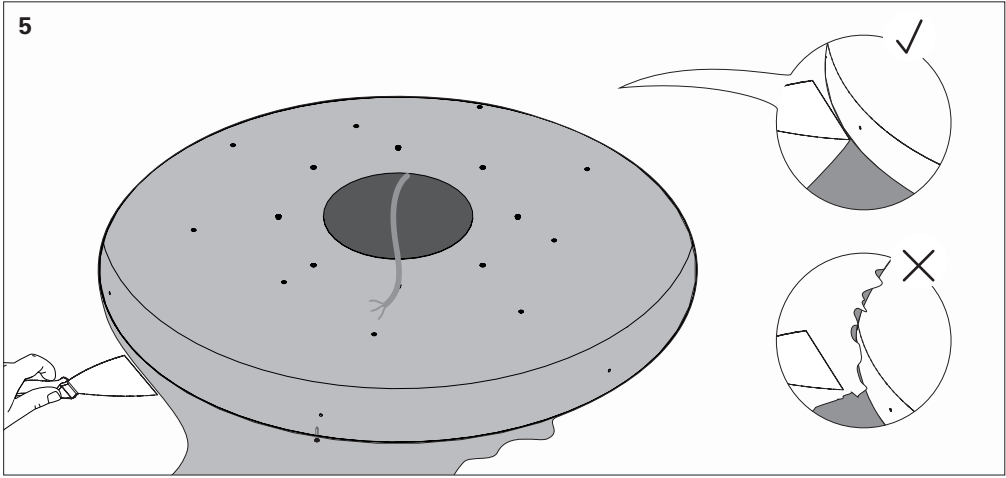

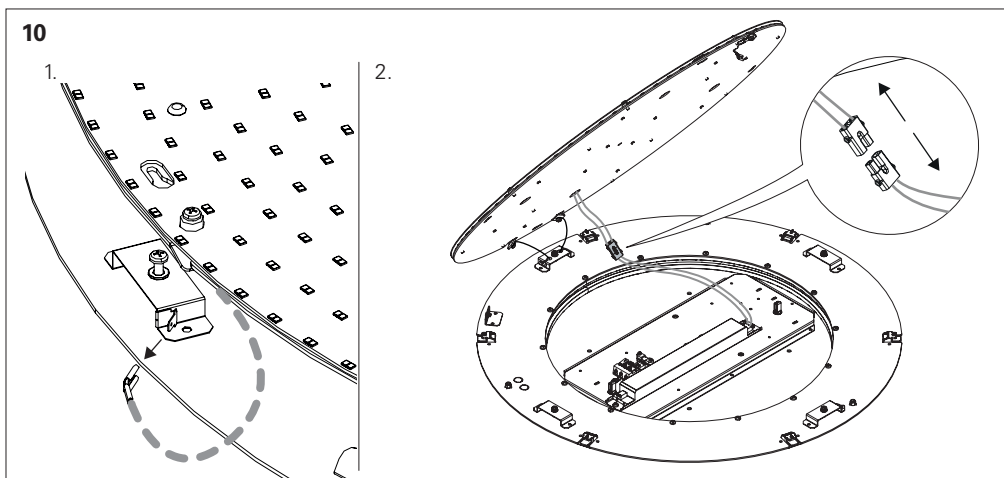
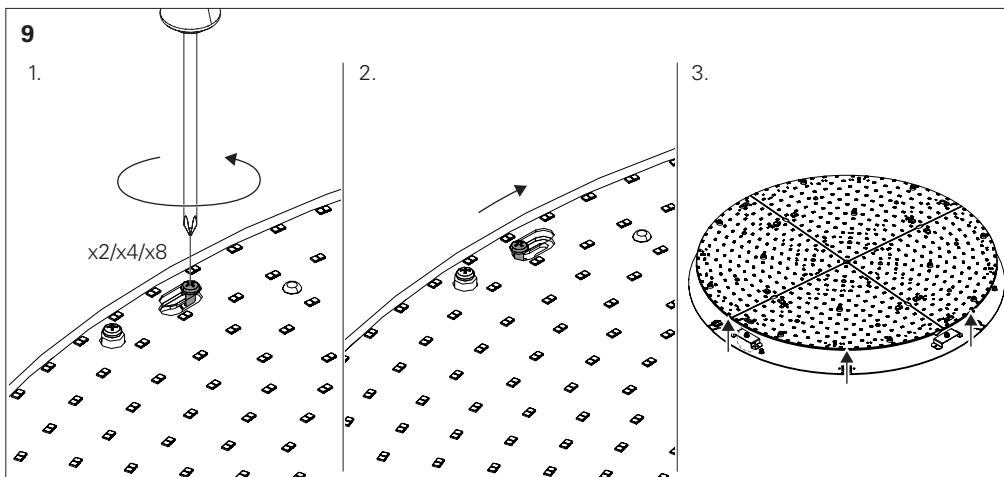
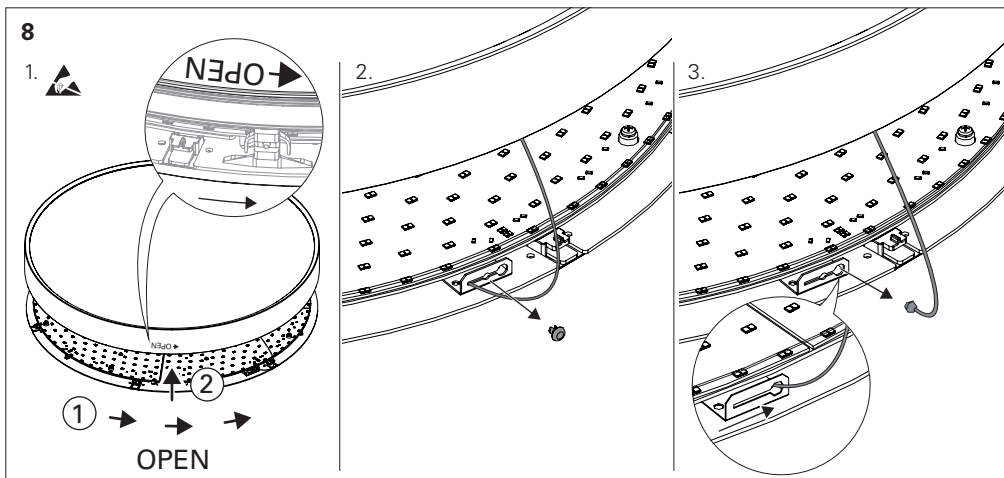

11

1.

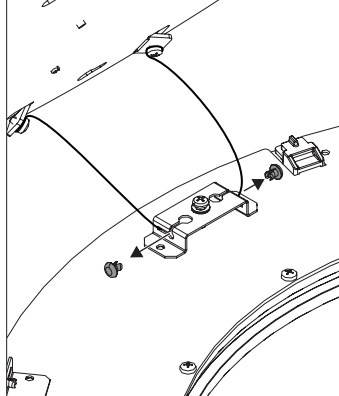

2.

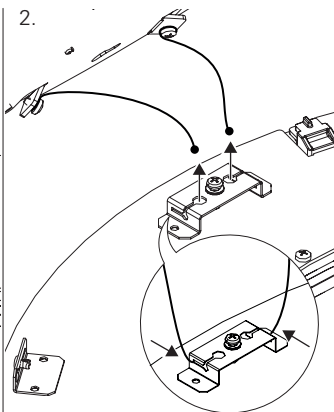

3.

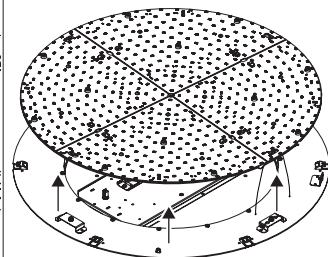

12

1.

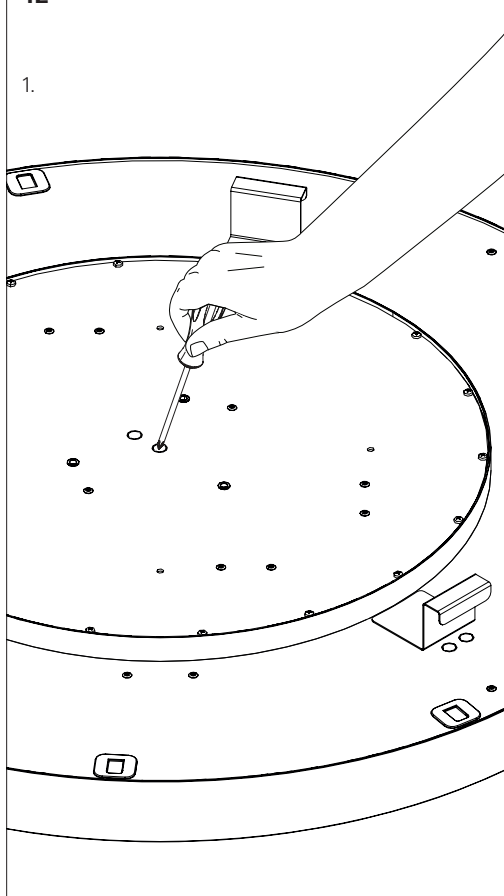

2.

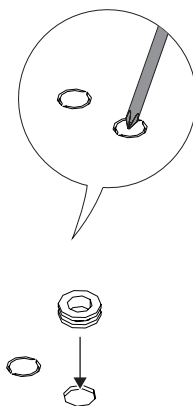

3.

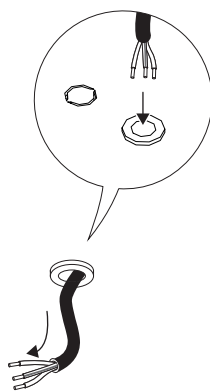



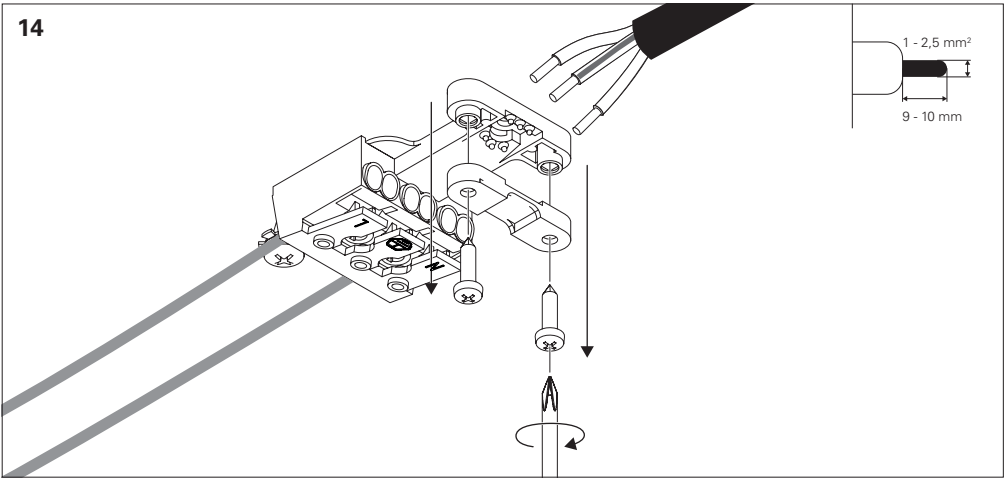
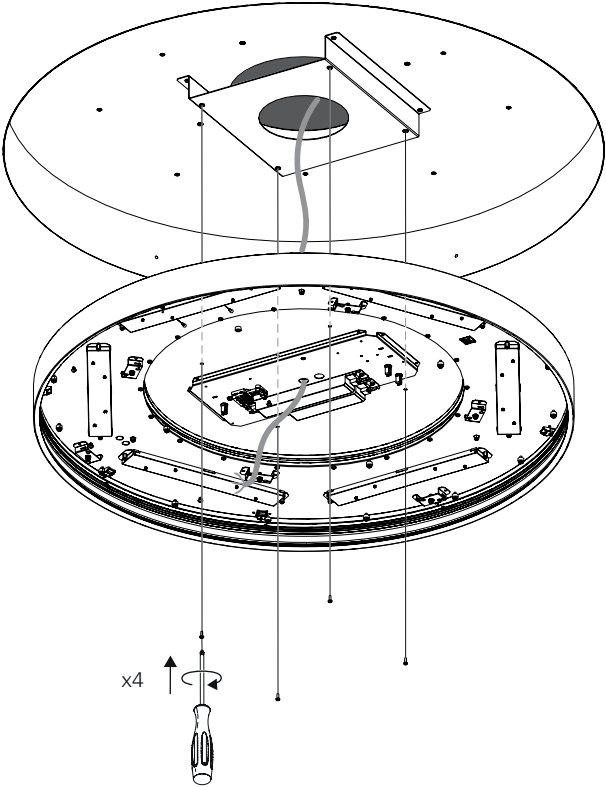

**15 - HF + CD + K3 + TEL.**

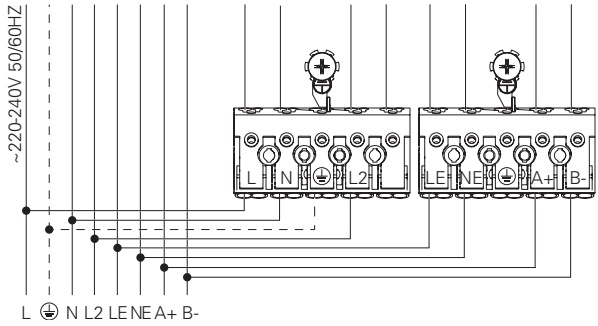

**15 - HF + K3 + TEL.**

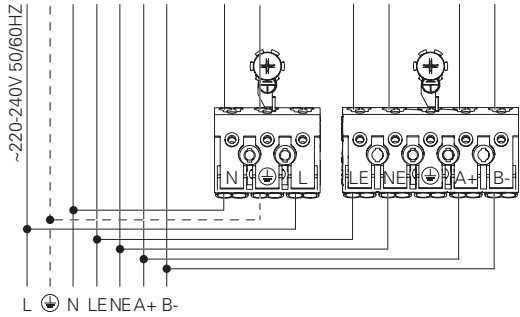

**15 - DALI**

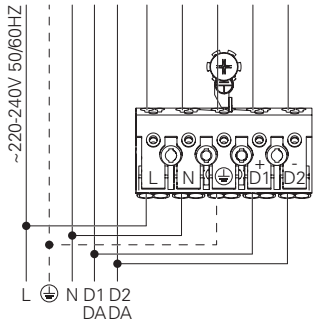

**DALI + K3 + TEL.**

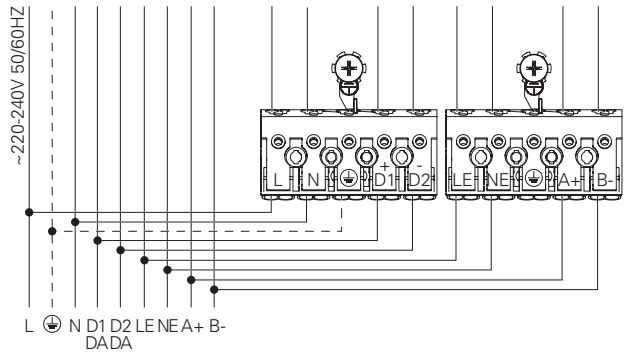

**15 - SWD**

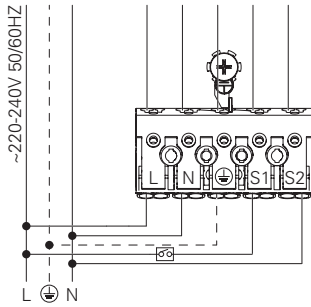

**SWD + CD**

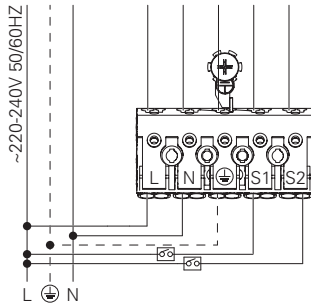

**15 - SWD + CD + K3 + TEL**

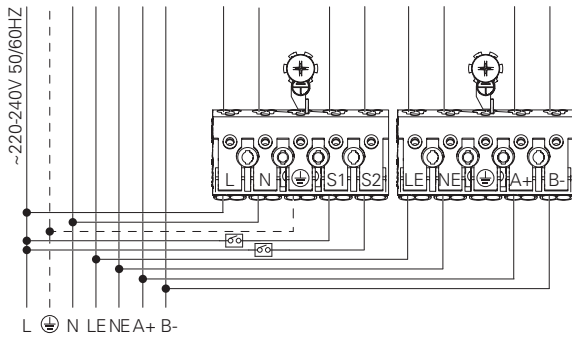

**15 - HF**

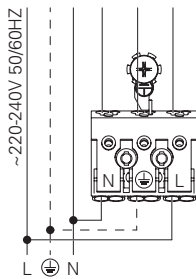

**HF + CD**

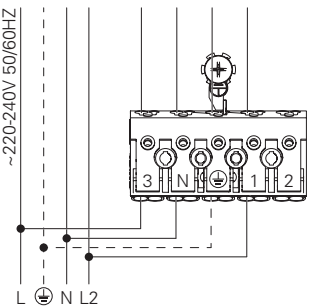

16

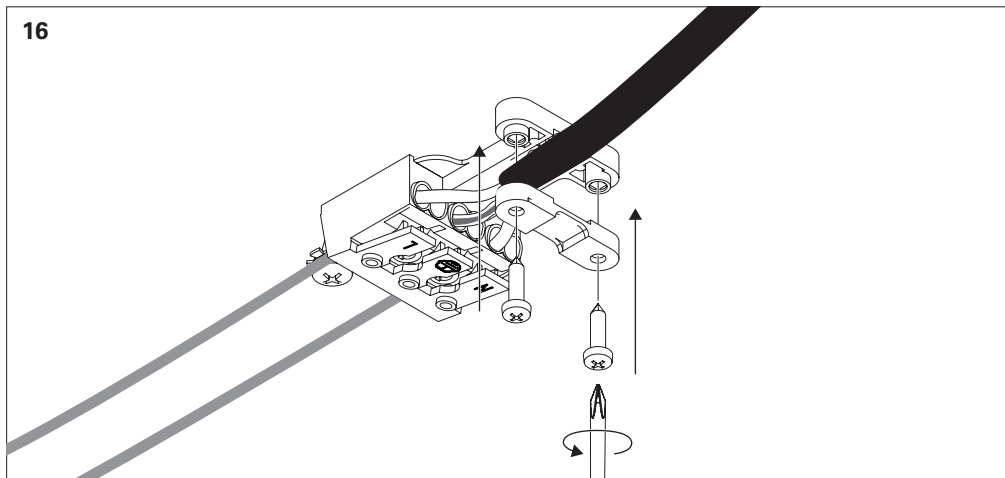

17

1.

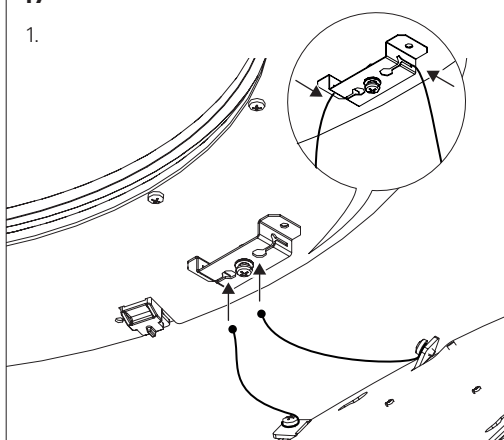

2.

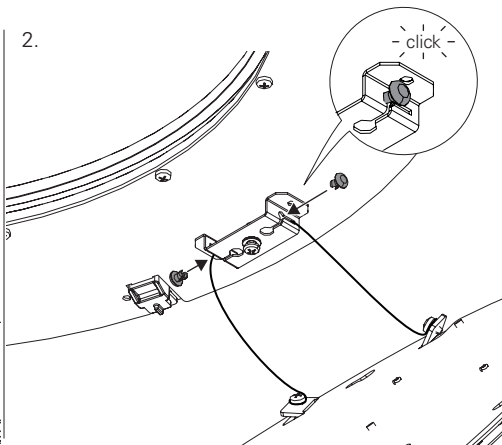

18

1.

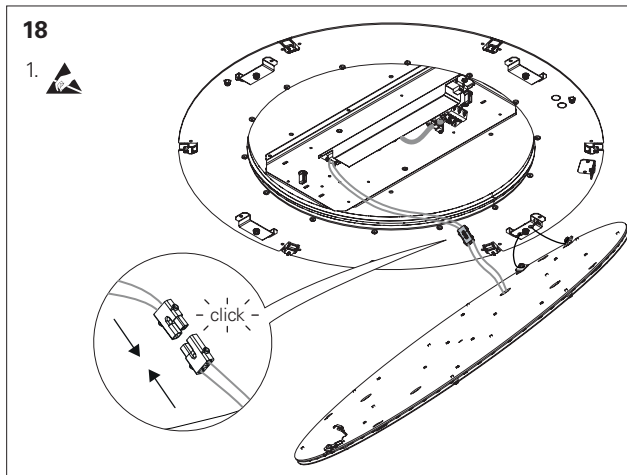

2.

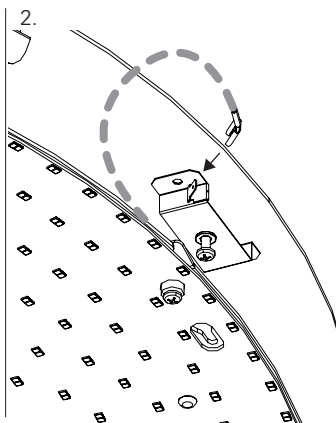

19

1. 

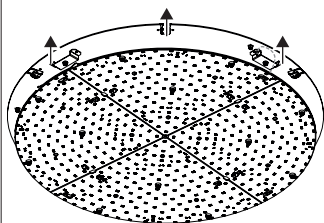

2.

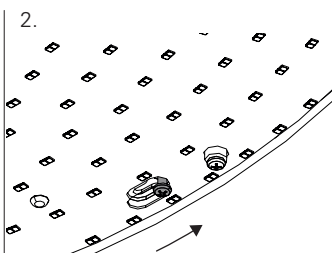

3.

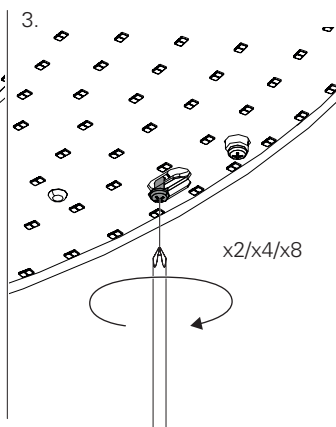

20

1.

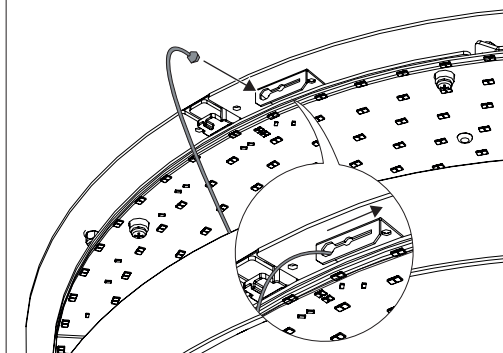

2.

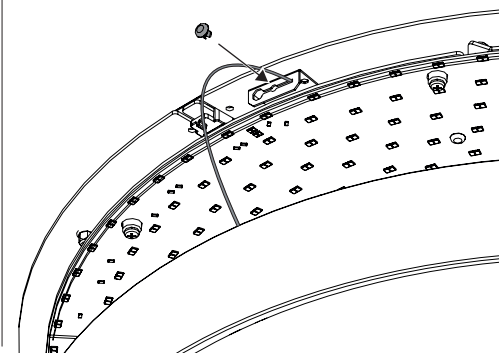

21

1.

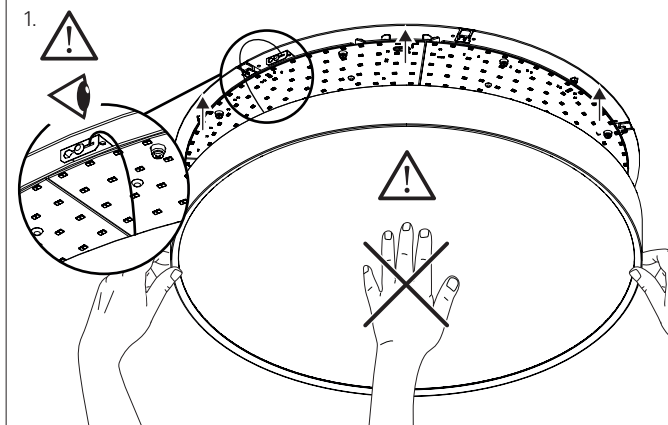

2.

