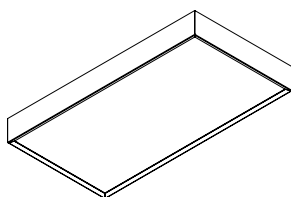
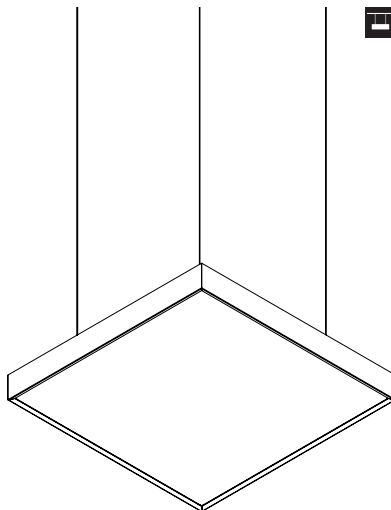

ROFY 60 Sq | ROFY 60 Sq D/I**EN** INSTALLATION INSTRUCTIONS**FR** NOTICE DE MONTAGE**DE** MONTAGEANLEITUNG**PT** INSTRUÇÕES DE MONTAGEM**ES** INSTRUCCIONES DE MONTAJE

EN READ THE SUPPLEMENTARY MANUALS.
FR LIRE LES NOTICES DE MONTAGE SUPPLÉMENTAIRES.
DE LESEN SIE DIE ZUSÄTZLICHEN MONTAGEANLEITUNGEN
PT CONSULTE OS MANUAIS COMPLEMENTARES.
ES LEA LOS MANUALES COMPLEMENTARIOS.

**IIV675 | IIV809**

Order code / Code com. / Bestell-Nr. / Código / Código: 90718L... | 90720L... | 90714L... | 90716L...

**EN** Carefully read the installation instructions provided before installing the device. Safety and Maintenance: Scan here.**FR** Lire attentivement les notices de montage avant l'installation de l'appareil. Sécurité et Entretien: Scannez ici.**DE** Bitte lesen die mitgelieferte Montageanleitung vor der Montage des Geräts. Sicherheit und Wartung: Hier scannen.**PT** Leia atentamente as instruções de montagem fornecidas antes de instalar o aparelho. Segurança e Manutenção: Scan aqui.**ES** Lea atentamente las instrucciones de montaje proporcionadas antes de instalar el aparato. Seguridad y Mantenimiento: Escanea aquí.

ROFY 60 Sq | ROFY 60 Sq D/I



(mm)
286x286x85
550x550x85
550x286x85
814x286x85
1078x286x85
1342x286x85

TOOLS | OUTILS | WERKZEUG | FERRAMENTAS | HERRAMIENTAS

Phillips screwdriver



EN USE GLOVES.
FR UTILISEZ DES GANTS.
DE HANDSCHUHE BENUTZEN.
PT UTILIZE LUVAS.
ES USE GUANTES.



EN DO NOT PRESS – RISK OF BREAKAGE.
FR NICHT DRÜCKEN – BRUCHGEFAHR.
DE NE PAS APPUYER – RISQUE DE CASSE.
PT NÃO PRESSIONE – RISCO DE QUEBRA.
ES NO PRESIONAR – RIESGO DE ROTURA.

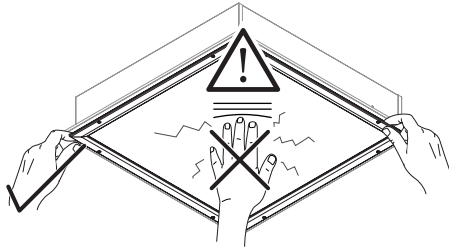

ROFY 60 Sq | ROFY 60 Sq D/I

90718L... | 90720L... | 90714L... | 90716L...

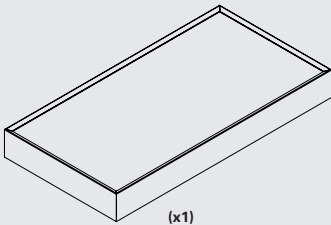

(x1)

**CURRENT SUPPLY CABLE
CÂBLE D'ALIMENTATION
EINSPEISUNGSKABEL
CABO DE ALIMENTAÇÃO
CABLE DE ALIMENTACIÓN**

9404... | 9405... | 9406...

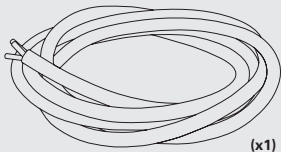

(x1)

**S11 SUSPENSION
SUSPENSION S11
SEILABHÄNGUNG S11
SUSPENSÃO S11
SUSPENSIÓN S11**

912904...

SUSPENSIONTYPE "I"
SUSPENSIONTYPE "I"
AUFHÄNGUNG TYP "I"
SUSPENSÃO DO TIPO "I"
SUSPENSIÓN TIPO "I"

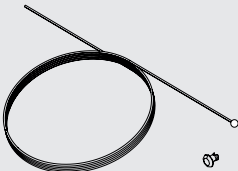

(x4)



(x4)



(x4)



(x4)



IIV675

**CEILING ROSE
PATÈRE DE SUSPENSION
DECKENDOSE
CAIXA DE ALIMENTAÇÃO
BASE DE TECHO**

9714...

RECESSED CEILING ROSE T7 / T59
PATÈRE DE SUSPENSION ENCASTRÉE T7 / T59
DECKENDLOSEN ZUM EINBAUT5 T7 / T59
CAIXA DE ALIMENTAÇÃO ENCASTRAR T7 / T59
BASE DE TECHO DE EMPOTRAR T7 / T59



(x1)



(x2/x4/x6)



(x1)

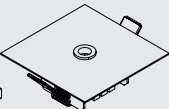

(x1)

9786...

SURFACE MOUNTED CEILING ROSE T25 / T29
PATÈRE DE SUSPENSION SAILLIET25 / T29
DECKENDOSE ZUM ANBAUT25 / T29
CAIXA DE ALIMENTAÇÃO SALIENTE T25 / T29
BASE DE TECHO DE SUPERFICIE T25 / T29



(x2/x4/x6)



(x1)

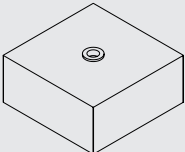

(x1)



IIV809

ROFY 60 Sq

SURFACE MOUNTED
SAILLIE
OBERFLÄCHENMONTAGE
SALIENTE
SUPERFICIE

ROFY 60 Sq			
 (mm)	A	B	Fixings
286x286	126	--	2
550x550	330	330	4
550x286	88	366	4
814x286	88	594	4
1078x286	88	858	4
1342x286	88	1122	4

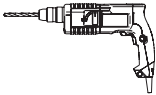

 (mm)
286x286

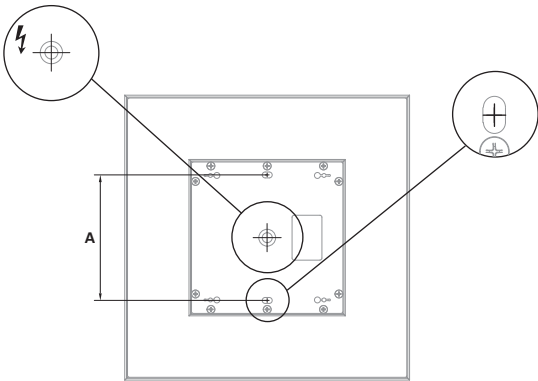

 (mm)
550x550
550x286
814x286
1078x286
1342x286

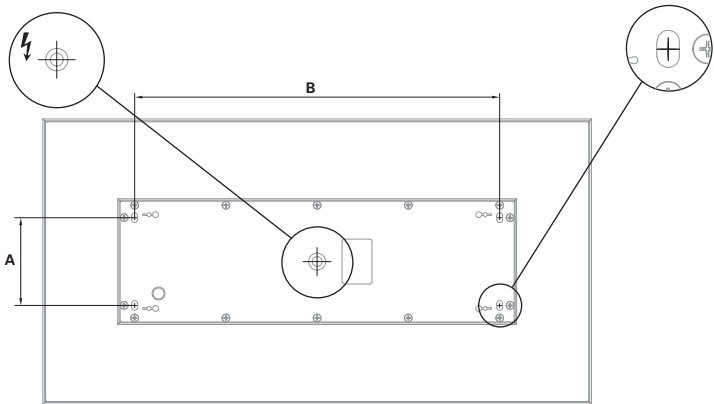

ROFY 60 Sq | ROFY 60 Sq D/I

SUSPENDED
SUSPENDU
SUSPENDIERT
SUSPENSO
SUSPENDIDO

ROFY 60 Sq ROFY 60 Sq D/I			
(mm)	A	B	Fixings
286x286	125	125	4
550x550	358	358	
550x286	94	348	
814x286	94	622	
1078x286	94	886	
1342x286	94	1150	

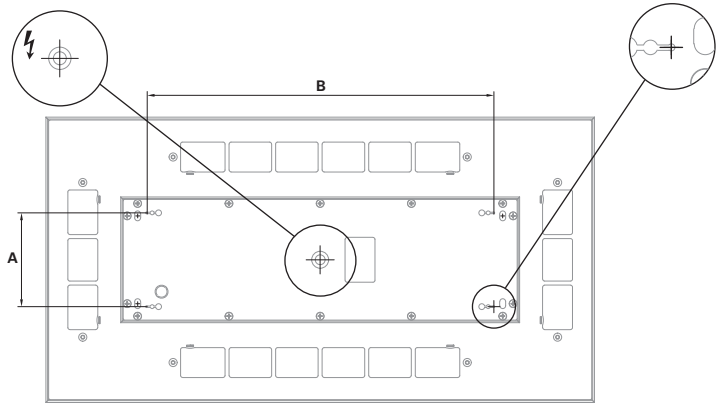
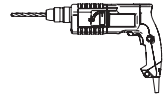

1

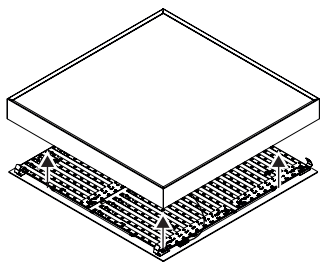

2.

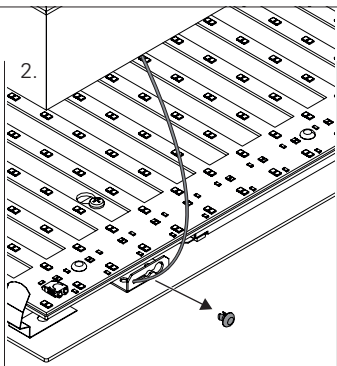

3.

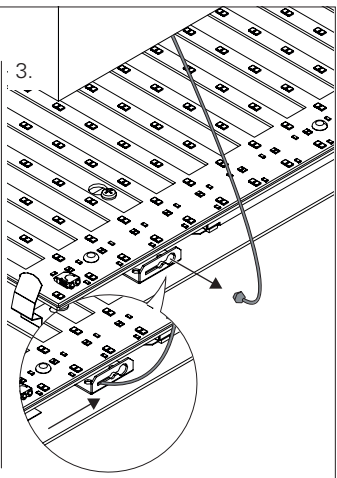

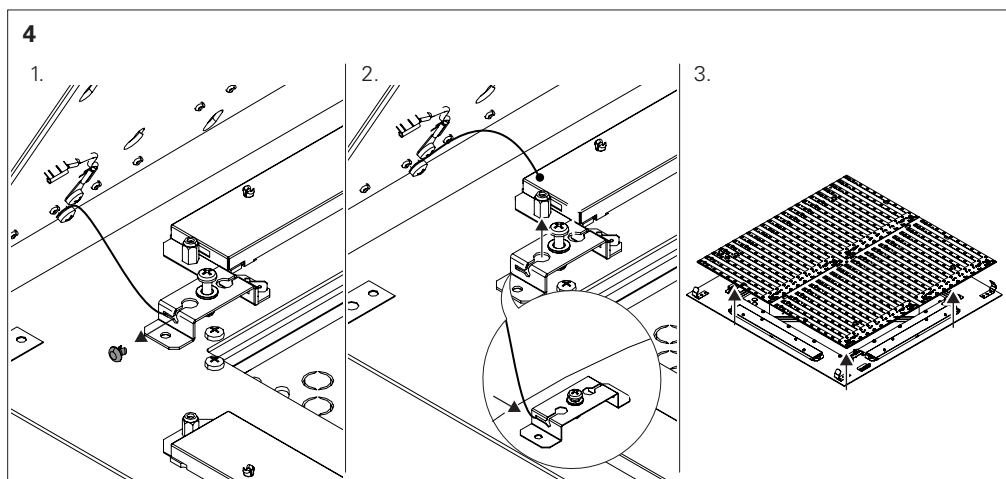
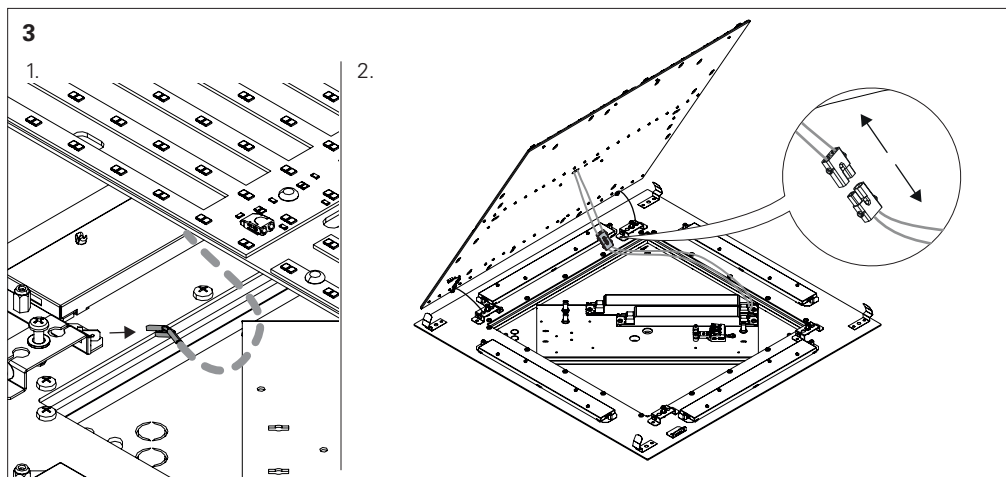
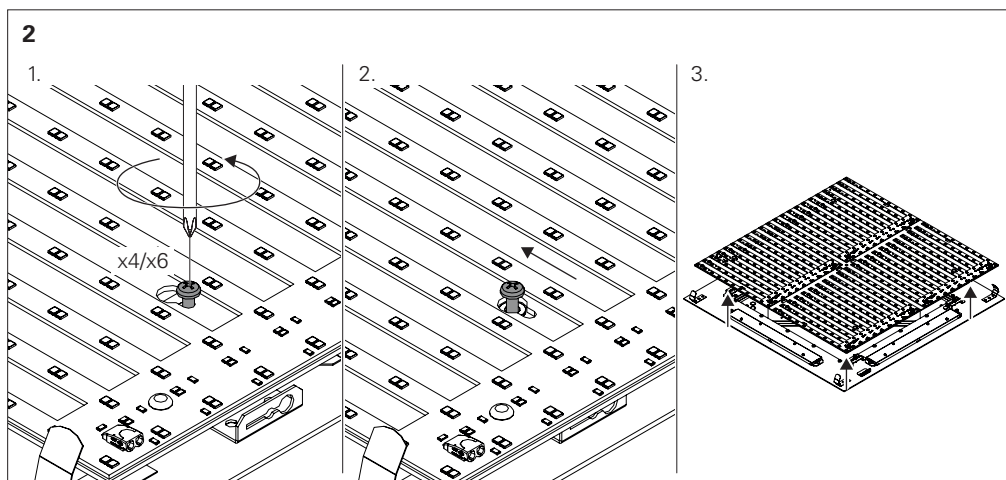

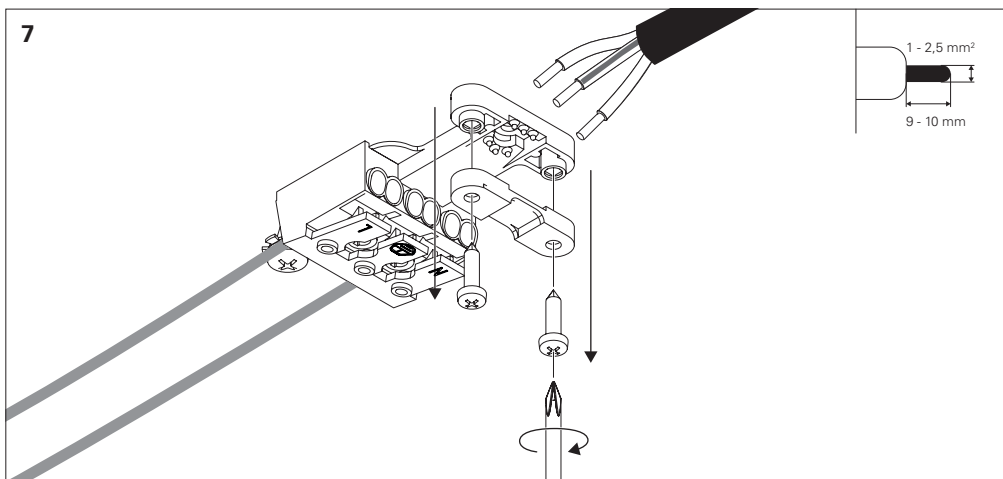
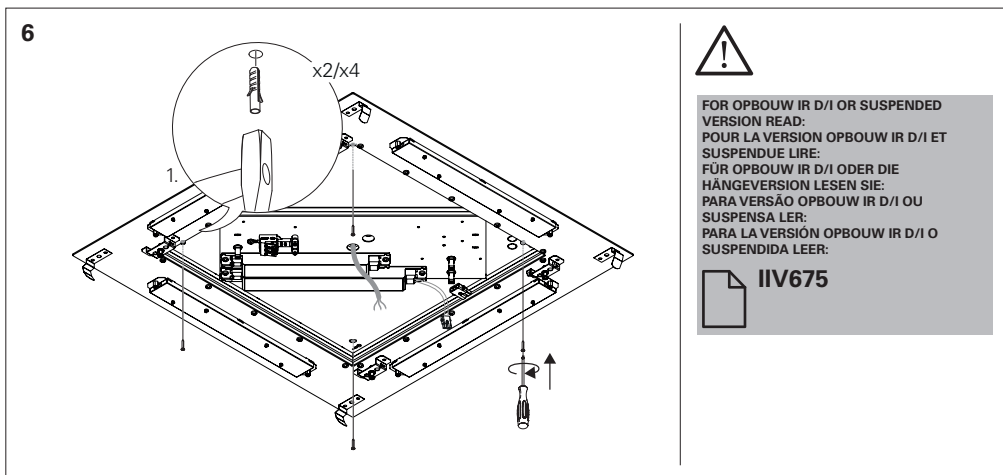
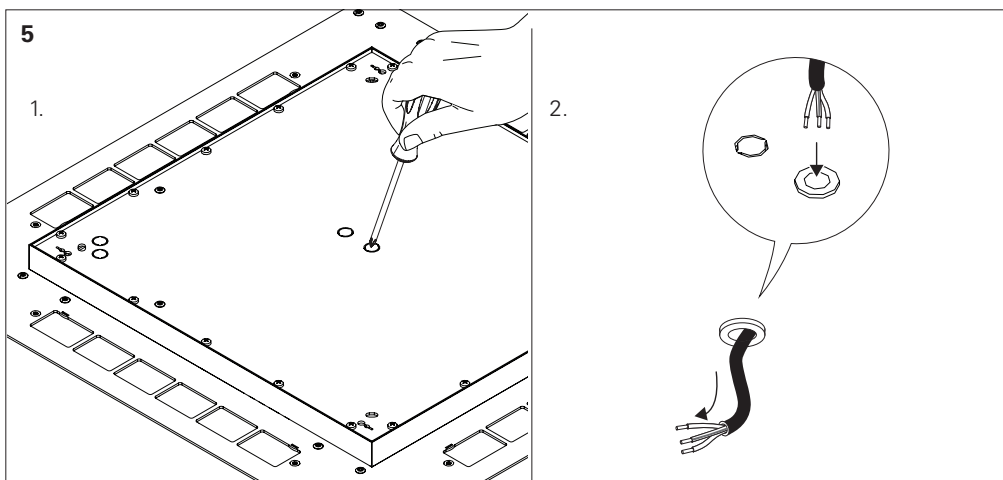

8 - HF

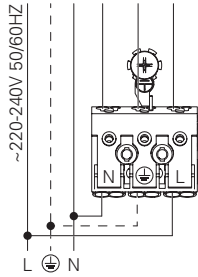

HF + CD

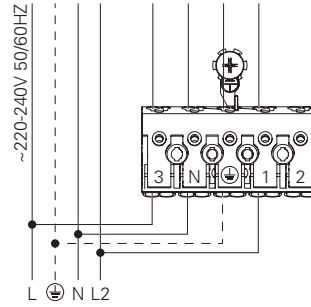

8 - HF + CD + K3 + TEL.

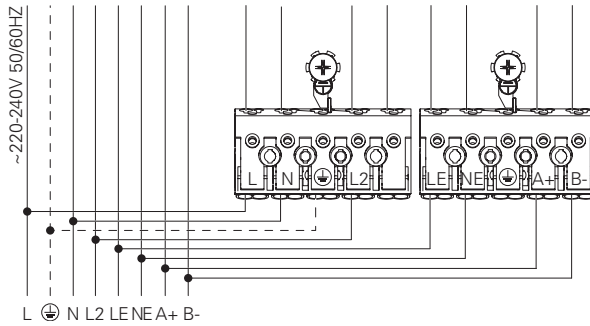

8 - HF + K3 + TEL.

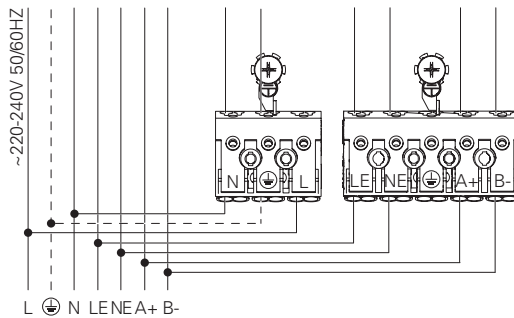

8 - DALI

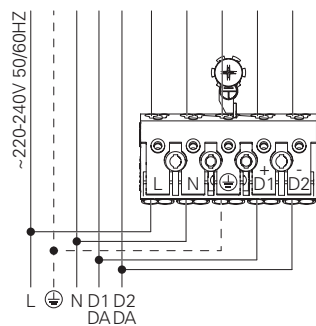

DALI + K3 + TEL.

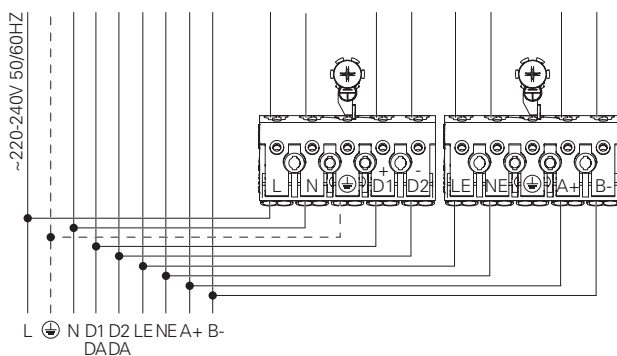

8 - SWD (ROFY 60 Sq D/I)

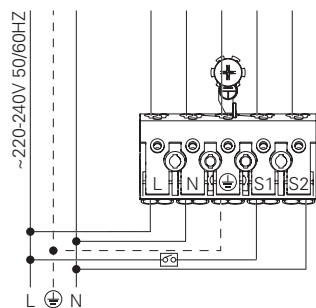

SWD + CD (ROFY 60 Sq D/I)

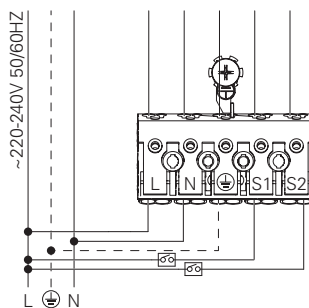

8 - SWD + CD + K3 + TEL (ROFY 60 Sq D/I)

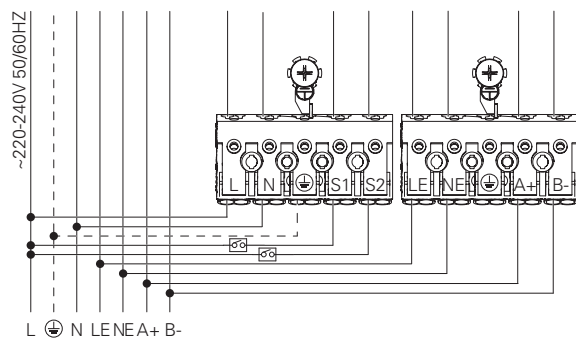

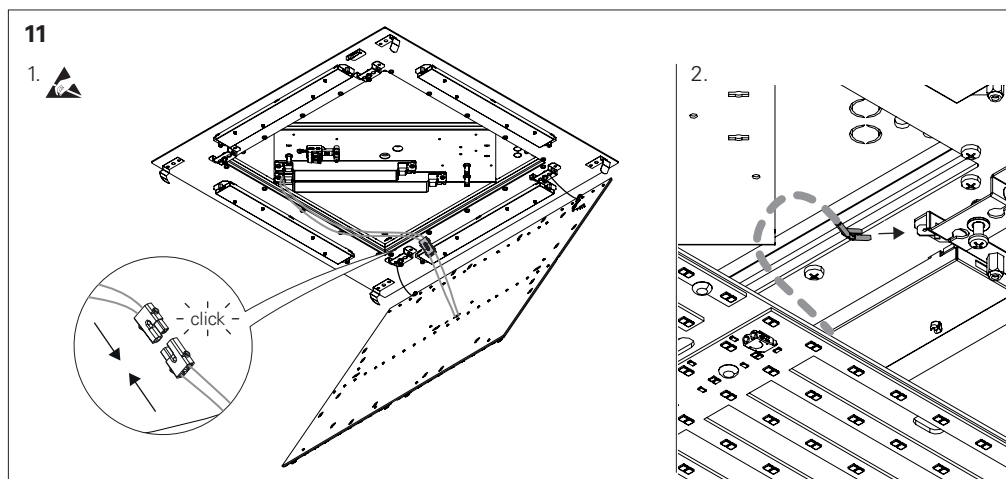
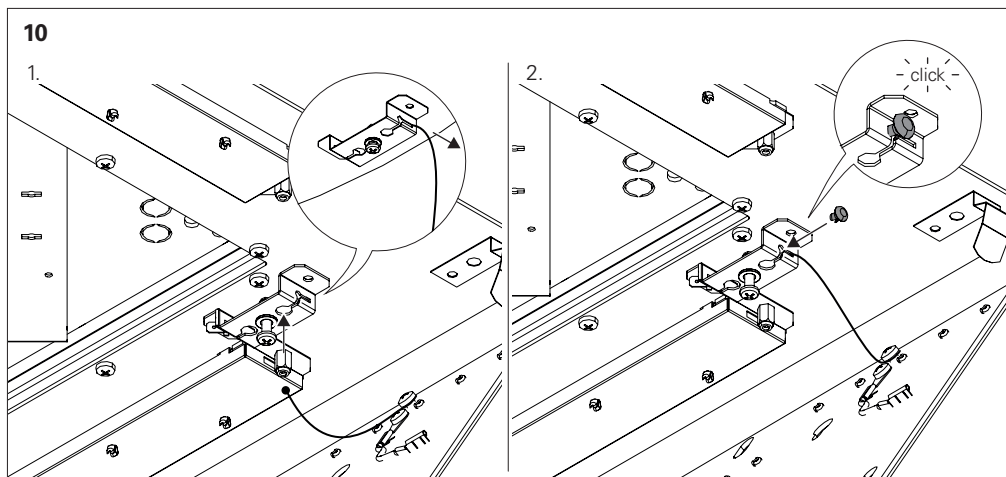
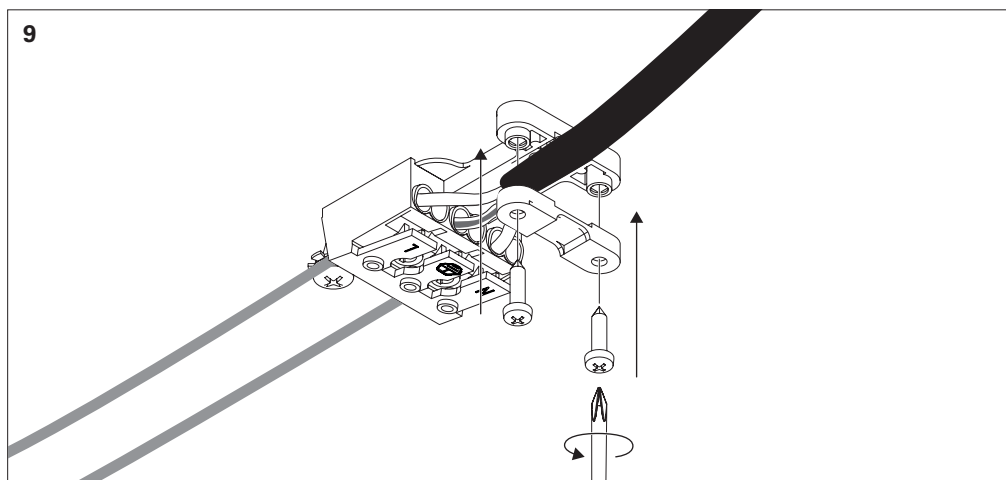

12

1. 

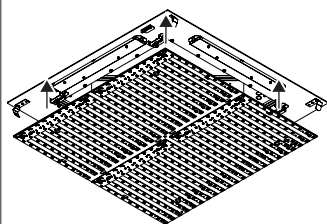

2.

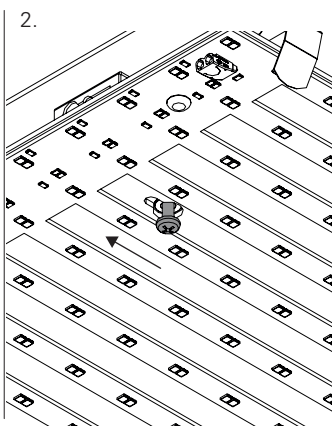

3.

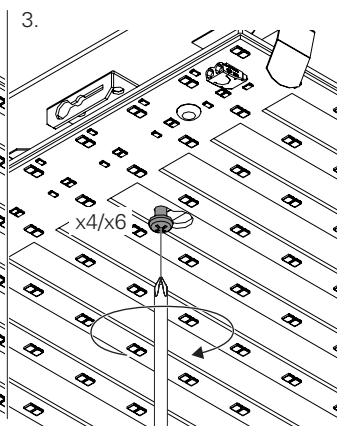

13

1.

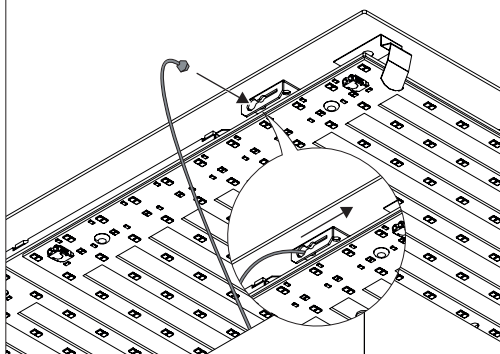

2.

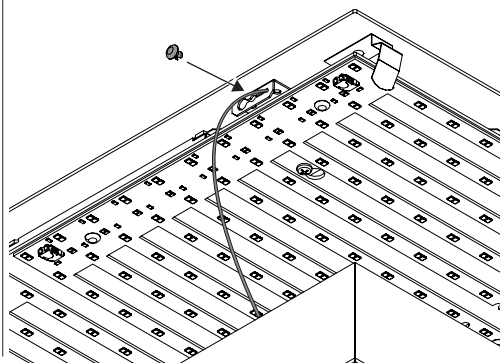

14

