

**REBA 50 BOPTICS INT****EN** INSTALLATION INSTRUCTIONS**FR** NOTICE DE MONTAGE**DE** MONTAGEANLEITUNG**PT** INSTRUÇÕES DE MONTAGEM**ES** INSTRUCCIONES DE MONTAJE

bOPTICS

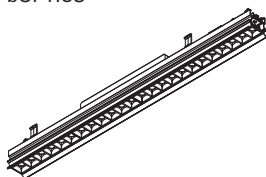

bFLEX

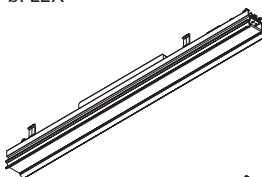

Blind Cover

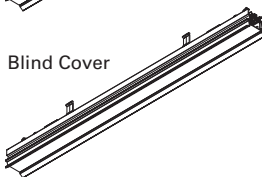

SPOT

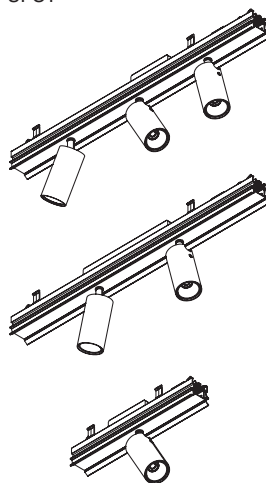

Order code / Code com. / Bestell-Nr. / Código / Código: 90747...| 90748...| 90749...| 90750...| 90751...

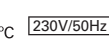
**EN** Carefully read the installation instructions provided before installing the device. Safety and Maintenance: Scan here. |**FR** Lire attentivement les notices de montage avant l'installation de l'appareil. Sécurité et Entretien: Saluez ici. |**DE** Bitte lesen die mitgelieferte Montageanleitung vor de Montage des Geräts. Sicherheit und Wartung: Hier scannen. |**PT** Leia atentamente as instruções de montagem fornecidas antes de instalar o aparelho. Segurança e Manutenção: Scan aqui. |**ES** Lea atentamente las instrucciones de montaje proporcionadas antes de instalar el aparato. Seguridad y Mantenimiento: Escanea aquí. |

# REBA 50 BOPTICS INT

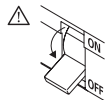

## REBA 50 bOPTICS INT

### bOPTICS / bFLEX

	L (mm)
67	637
47	955
	1273
	1591
	1910
	2228
	2547
	2865

### SPOT



### L (mm)

318 / 637 - **Spot 1**  
318 / 637 - **Spot 2**  
637 - **Spot 3**

## TOOLS | OUTILS | WERKZEUG | FERRAMENTAS | HERRAMIENTAS

Phillips screwdriver



**EN** USE GLOVES.  
**FR** UTILISEZ DES GANTS.  
**DE** HANDSCHUHE BENUTZEN.  
**PT** UTILIZE LUVAS.  
**ES** USE GUANTES.



**EN** AVAILABLE MODULES  
**FR** MODULES DISPONIBLES  
**DE** VERFÜGBARE MODULE  
**PT** MÓDULOS DISPONÍVEIS  
**ES** MÓDULOS DISPONIBLES

90747..| 90748...| 90749...|  
90750...| 90751...

BOPTICS



BFLEX



SPOT



BLIND COVER



## 1 - SRT / END

1.

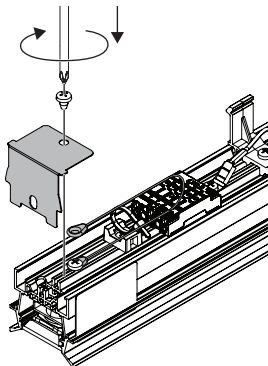

2.

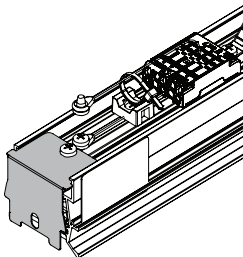

**ONLY FOR LINE VERSION**  
**UNIQUEMENT POUR LA VERSION LINE**  
**NUR FÜR DIE LINE-VERSION**  
**SÓ PARA A VERSÃO LINE**  
**SOLO PARA LA VERSIÓN LINE**

## 2

1.

a)

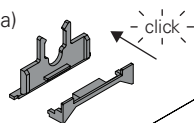

b)

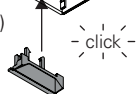

click

## 3

1.

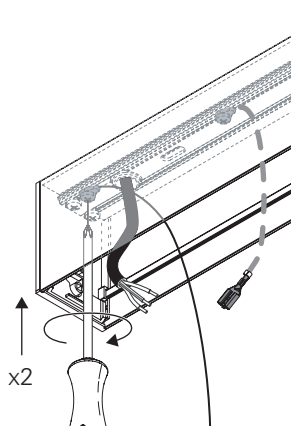

2.

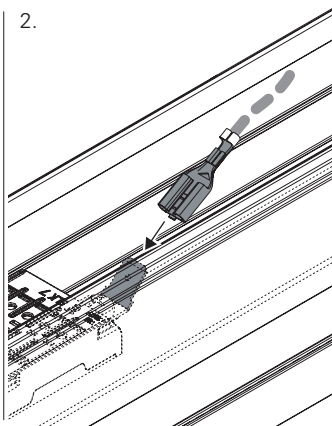

3.

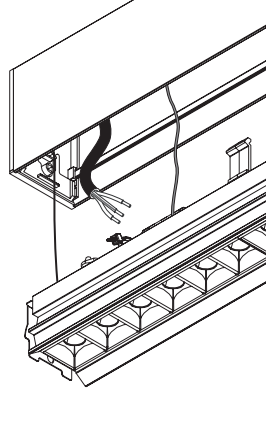

## 4

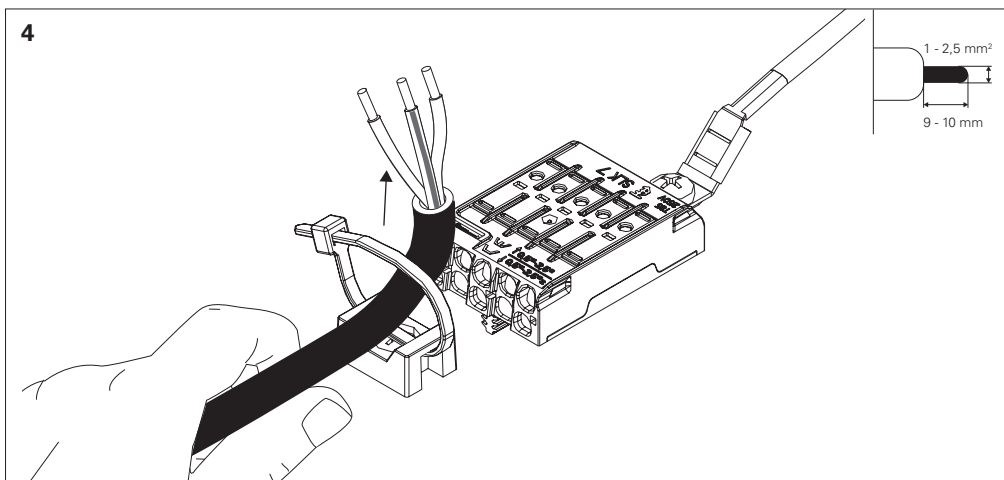

## 5 - HF / CASAMBI

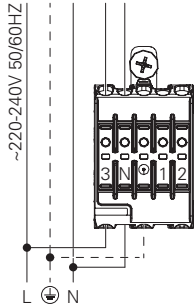

## DALI

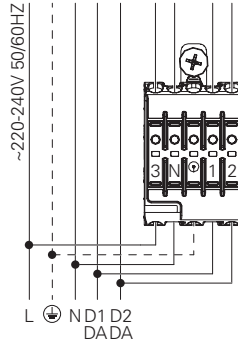

## SWD

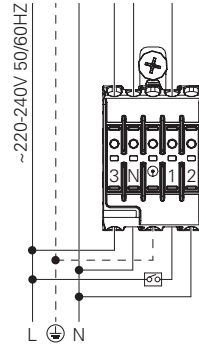

## 5 - HF + K3

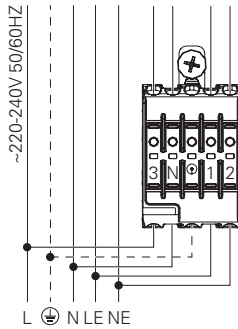

## HF + K3 + TEL

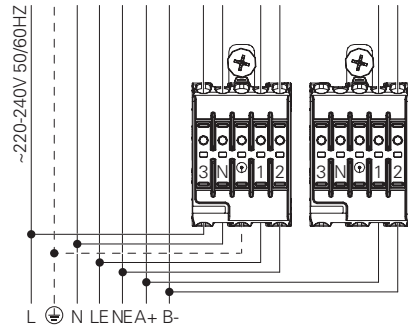

## 5 - DALI + K3

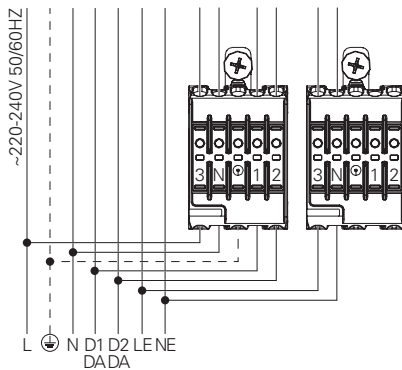

## DALI + K3 + TEL

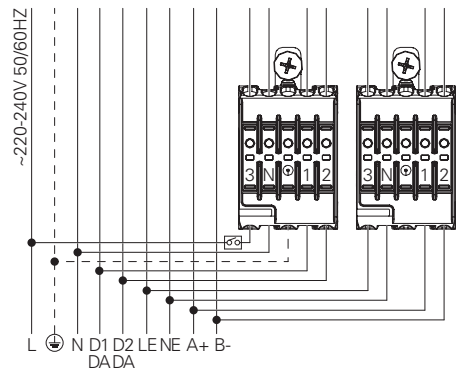

## 5 - SWD + K3

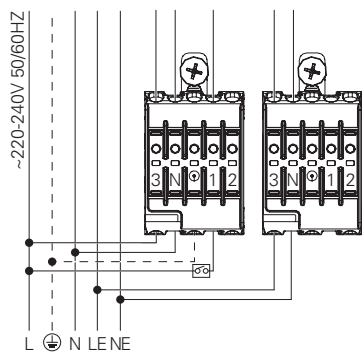

## SWD + K3 + TEL

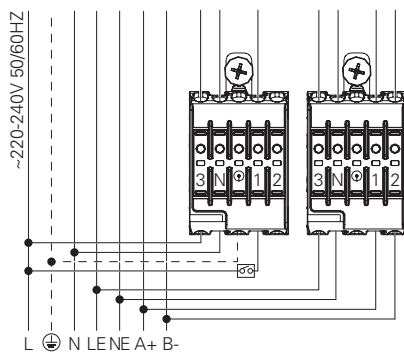

6

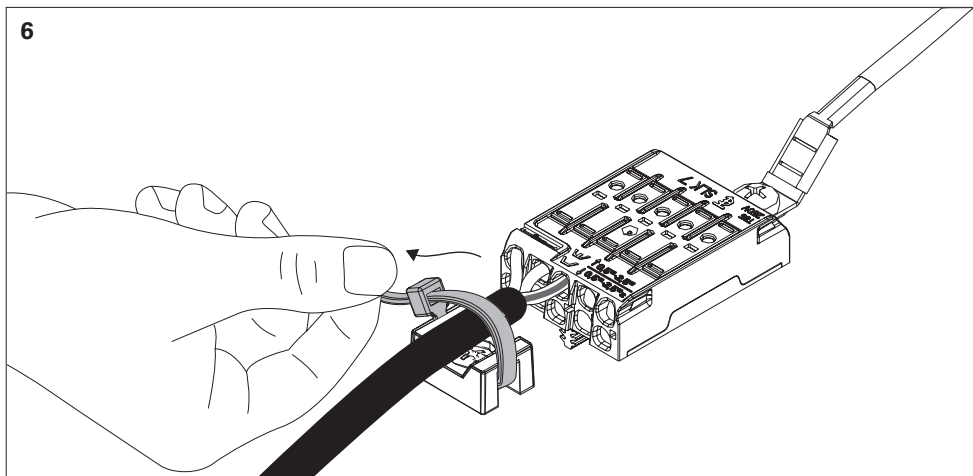

7

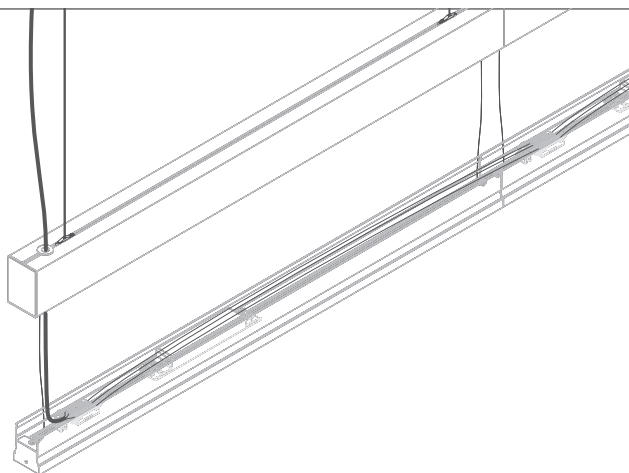

**ONLY FOR LINE VERSION**  
**UNIQUEMENT POUR LA VERSION LINE**  
**NUR FÜR DIE LINE-VERSION**  
**SÓ PARA A VERSÃO LINE**  
**SOLO PARA LA VERSIÓN LINE**

TO CONNECT THE WIRING READ:  
 POUR BRANCHER LE CÂBLAGE  
 TRAVERSANT LIRE:  
 FÜR DURCHGANGVERDRÄHTUNG  
 BITTE LESEN SIE:  
 PARA LIGAR A CABLAGEM LER:  
 PARA CONECTAR EL CABLEADO PARA  
 LÍNEA CONTINUA LEER:



**IIV630**

8

BOPTICS

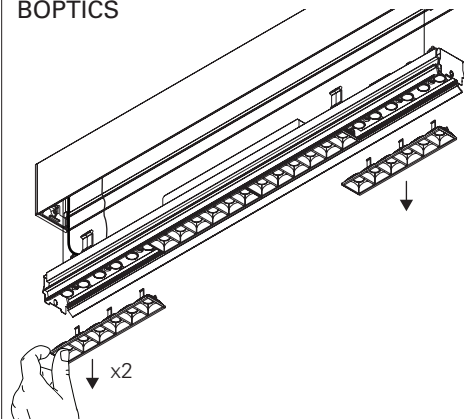

BFLEX

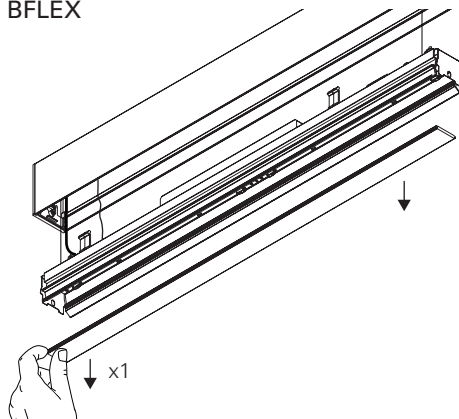

9

BOPTICS

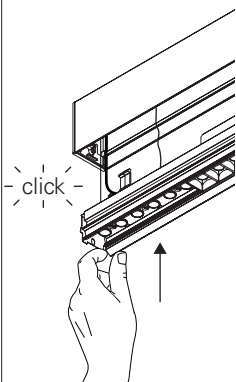

BFLEX

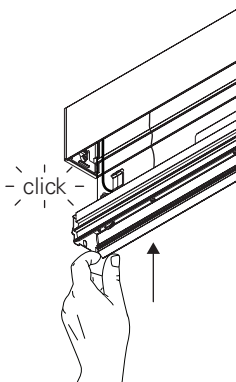

SPOT AND  
BLIND COVER

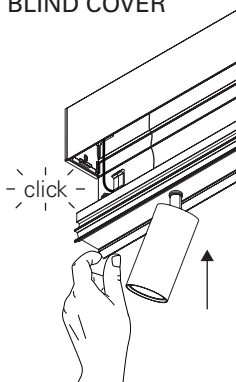

DO NOT CRUSH CABLES  
BETWEEN THE LED MODULE AND  
LUMINAIRE PROFILE.  
FAITES ATTENTION À NE PAS  
COINCER LES CÂBLES ENTRE LE  
MODULE DE LED ET LE PROFILÉ  
DU LUMINAIRE.  
KLEMMEN SIE DIE KABEL  
ZWISCHEN LED-MODUL UND  
LEUCHTENPROFIL NICHT EIN.  
NÃO TRILHAR OS CABOS ENTRE  
O MÓDULO LED E O PERFIL DA  
LUMINÁRIA.  
NO APLASTAR LOS CABLES  
ENTRE EL MÓDULO DE LED Y EL  
PERFIL DE LA LUMINARIA.

10

1. BOPTICS AND BFLEX

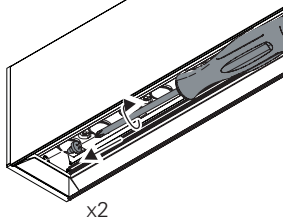

2. BOPTICS

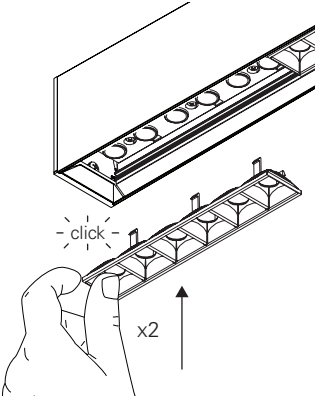

BFLEX

